

Features & Benefits

The Front Load Soft Signage Tension Frame is ideal for all dye-sublimation and direct print fabrics. No sewing or silicone beads required. Fast, easy frame assembly using the 2 Piece Corner Key, Part #5890. Light weight 1 piece design - No cover needed. Available in Mill Finish and Clear Anodized.

Answers to FAQ's

- Fabric can be tensioned using a credit card or vinyl squeegee - No special tool required
- Face material trim size - Add 1-2" to the frame height and width
- Designed for narrow non-illuminated applications
- Face material trim size - Add 2" to the cabinet height & width
- Visible opening - Deduct 1/2" from the cabinet height & width

Optional Items

- Soft Signage Tension Frame Z-Clip, Part #3099

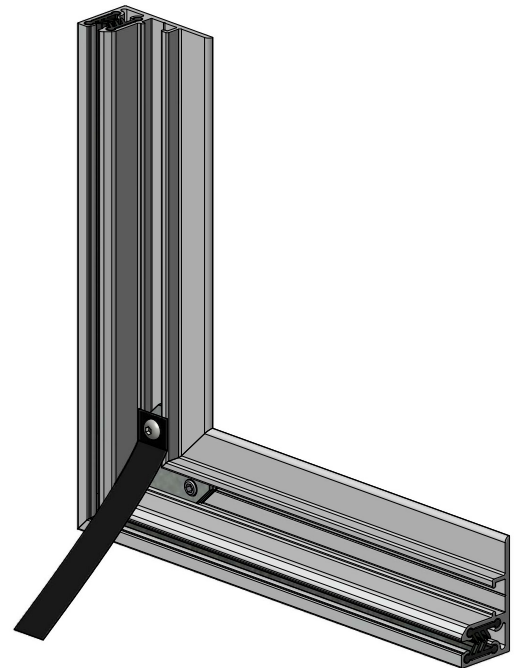

US Patent Number 8,595,966
Canadian Patent Number 2,754,507