

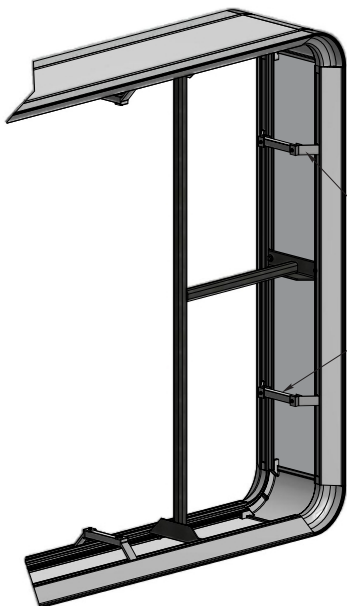

NEW PRODUCT UPDATE: Retro Frame Brace

	Part Number	Part	Length
	5354	Retro Frame Brace	1-1/8"

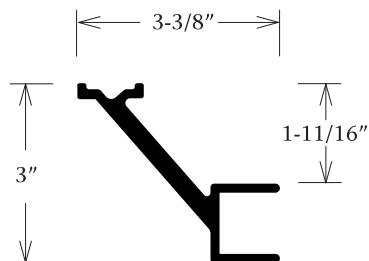
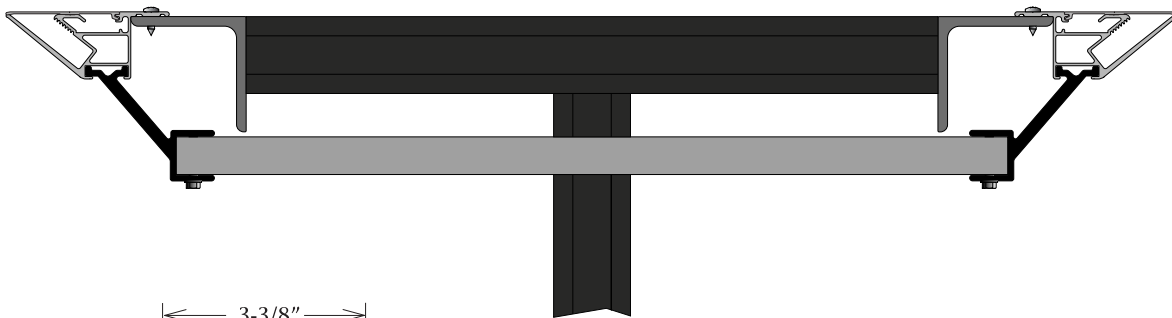

Retro Frame Brace
Part #5354

Frame Support Tubes cut to span between the Retro Frame Braces to form continuous support from side to side.

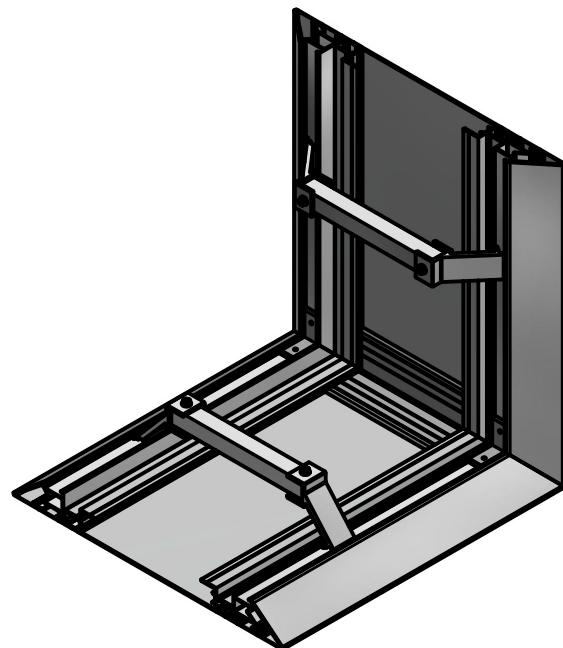

Retro Bracing

Place a Retro Frame Brace and 1" Frame Support Tube approximately every 24" on center around the perimeter of the cabinet. This bracing option may be used when there IS adequate structure in the cabinet and the frames are NOT required to hinge.



Frame Brace & Frame Support Tube Options

Image	Part	Part Number	Size
	Small Frame Brace Small Frame Support Tube	5352 2177	
	Retro Frame Brace Small Frame Support Tube	5354 2177	
	Frame Brace Frame Support Tube	5350 2175	
	2 Piece Frame Brace Frame Support Tube	5357 2175	