

Ship To:
Sales Order #

ITEM	PART #	DESCRIPTION	NOTES
1	K2010	Flat 2PC Double Face Medium Body	Assembly
2	K2107-2121	Flat Bleed Retro Frame II w/ Flat Bleed Cover	Assembly
79	5178	Hinge Screw - #10 x 5/8" pancake head	Pre-drill 5/32" - Top 36" o/c
80	5178	Closure Screw - #10 x 5/8" pancake head	Pre-drill 5/32" - Bottom and Sides 48" o/c

NOTE: PRE-CUT KITS ARE NOT PRE-DRILLED.

(Holes shown in this drawing are for reference only.
Drilling of pilot holes are to be done by fabricator.)

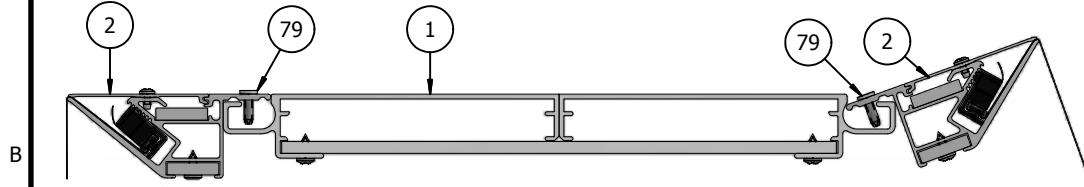

TOP CROSS-SECTION VIEW

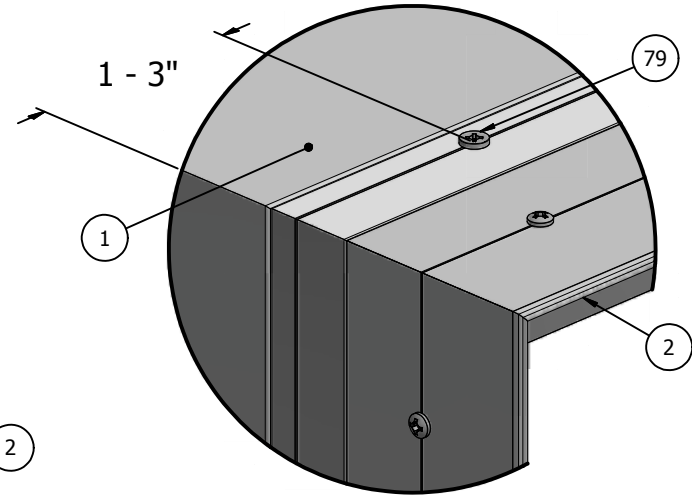

DETAIL A
FRAME CLOSED

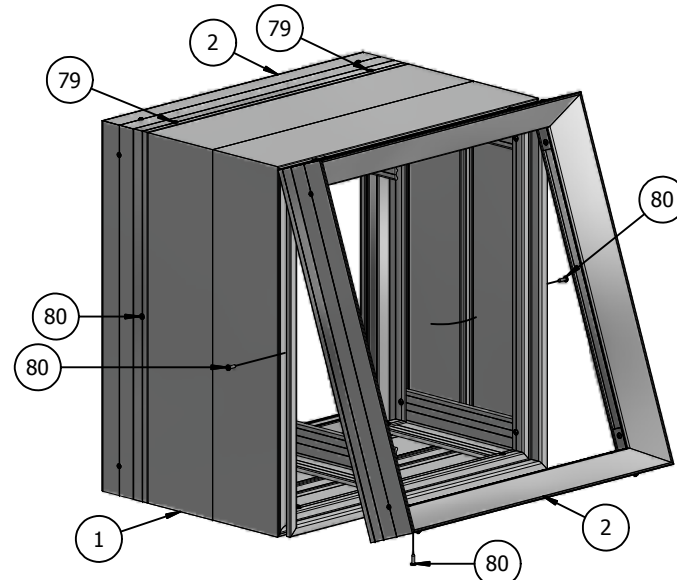
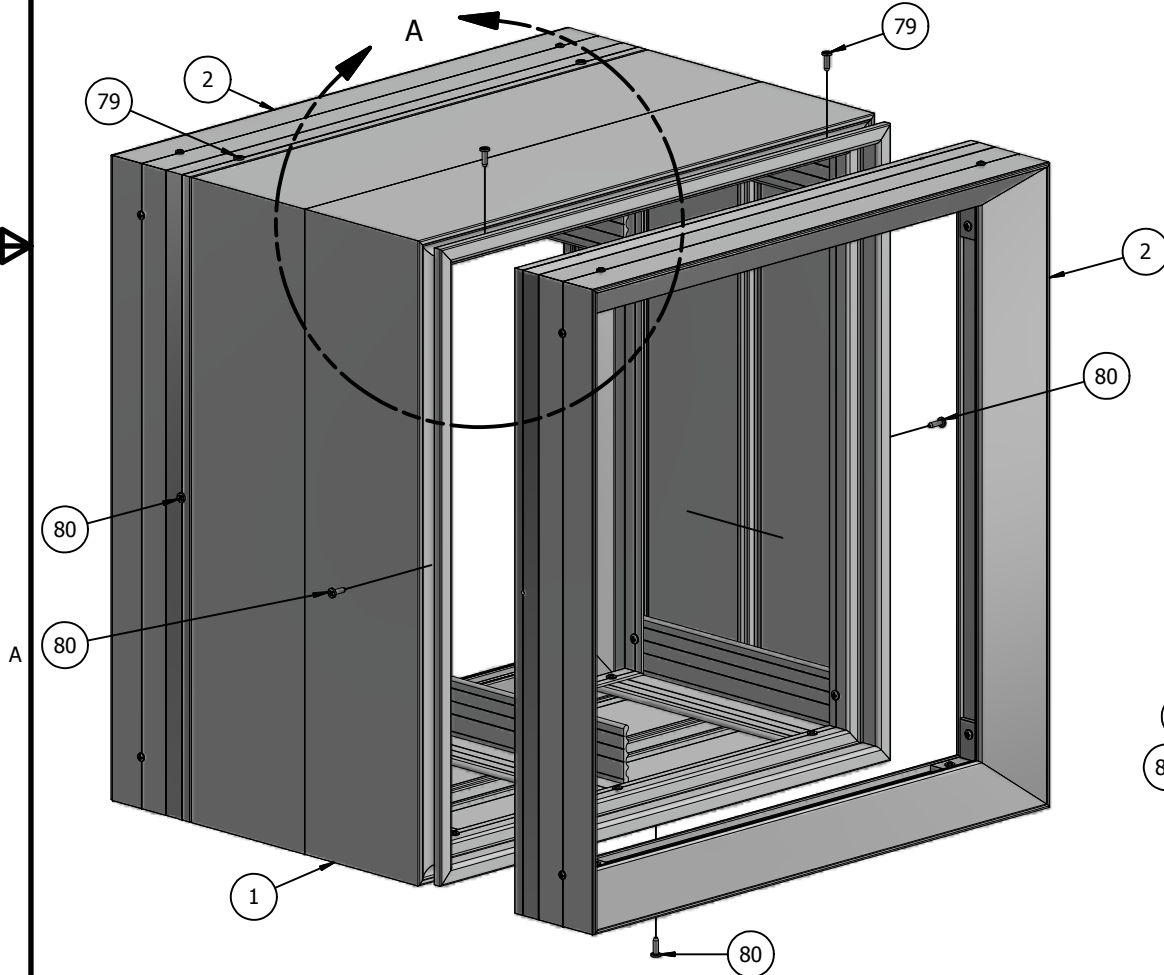

THIS DRAWING WAS CREATED AT NO CHARGE TO ASSIST YOU IN VISUALIZING OUR PROPOSAL. THE DRAWING HEREIN IS THE PROPERTY OF SIGNCOMP. PERMISSION TO COPY OR REVISE THIS DRAWING OR TO USE THIS DRAWING FOR PRODUCTION IS STRICTLY PROHIBITED AND CAN ONLY BE COPIED, REVISED OR USED FOR PRODUCTION WITH THE EXPRESSED WRITTEN PERMISSION OF SIGNCOMP.

Part Name: **Flat 2PC D/F Med. Body w/ Flat Bleed Retro Frm II** Sheet: 1 of 1 Size: A
 Part Number: **K2010-2107-21** Revision: **3/24/2015** Drawing By: **SBreihof**



PARTS LIST			
ITEM	PART#	DESCRIPTION	NOTES
1	2010	Flat 2PC Double Face Medium Body	Top & Bottom
2	2010	Flat 2PC Double Face Medium Body	Sides
3	5910	Flat 2PC Double Face Medium Body Corner Angle	One (1) per corner
4	5910	Flat 2PC Double Face Medium Body Corner Angle	Notched by Other
13	5218	Corner Angle Screw	Pre-drill 5/32" pilot hole

Shp To:
Sales Order#

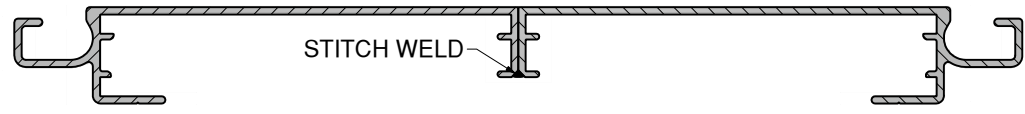
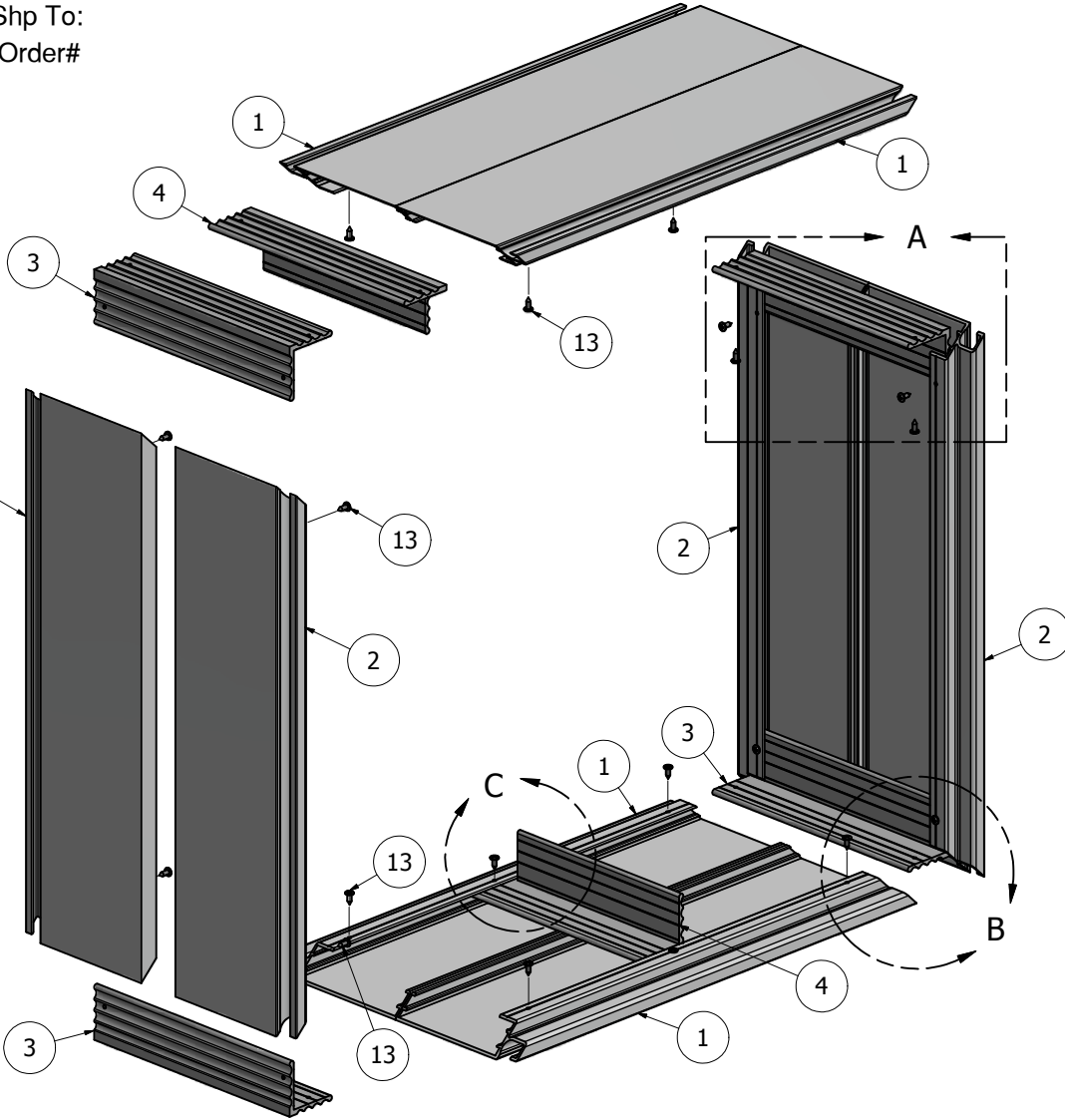

CROSS-SECTION VIEW

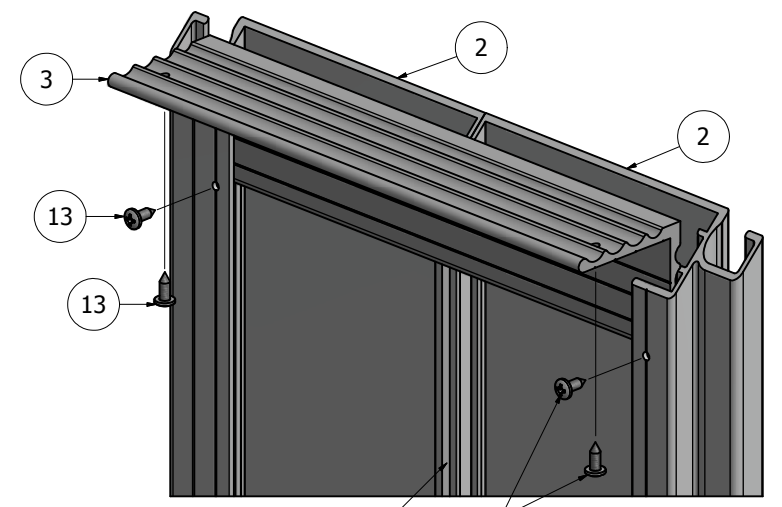

NOTE: Stitch weld the body joint then fill in the gaps between the welds with a bead of silicon.

DETAIL A

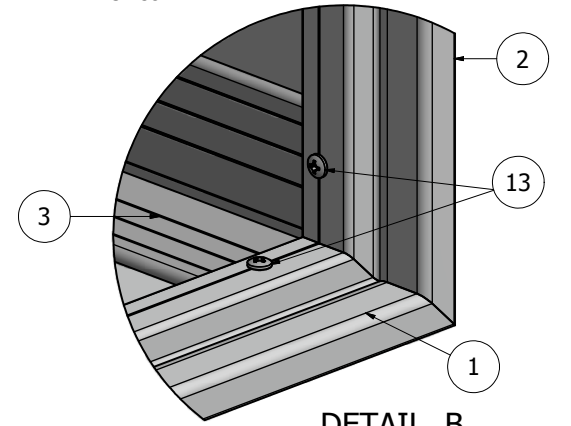

DETAIL B
ASSEMBLED

NOTE: PRE-CUT KITS ARE NOT PRE-DRILLED.
(Holes shown in this drawing are for reference only. Drilling of pilot holes are to be done by fabricator.)

DRAWING BY: SBreihof 8/14/2013		SignComp
Centroid X: 0.000 in	TITLE	
Centroid Y: 0.000 in	Flat 2PC Double Face Medium Body - Assembly	
Principal Moments Ix: 0.000 in ⁴	PART NO	REV
Principal Moments Iy: 0.000 in ⁴	K2010	
Section Modulus Ix: 0.000 in ³	SHEET 1 OF 2	
Section Modulus Iy: 0.000 in ³		

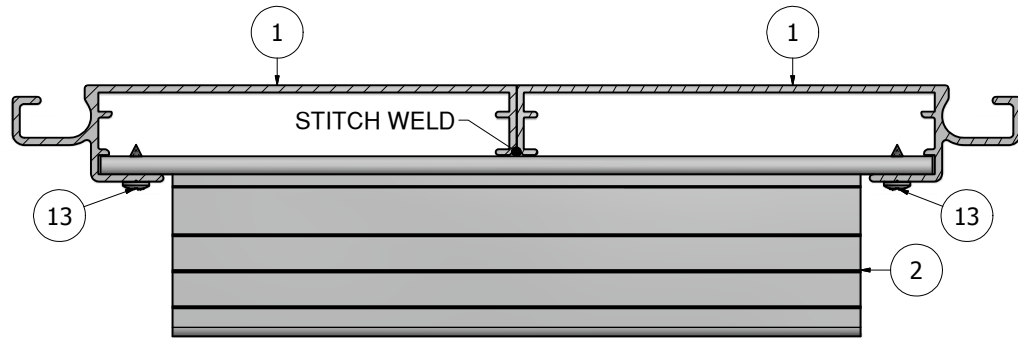

TOP & BOTTOM CROSS-SECTION VIEW
AT BODY BRACE

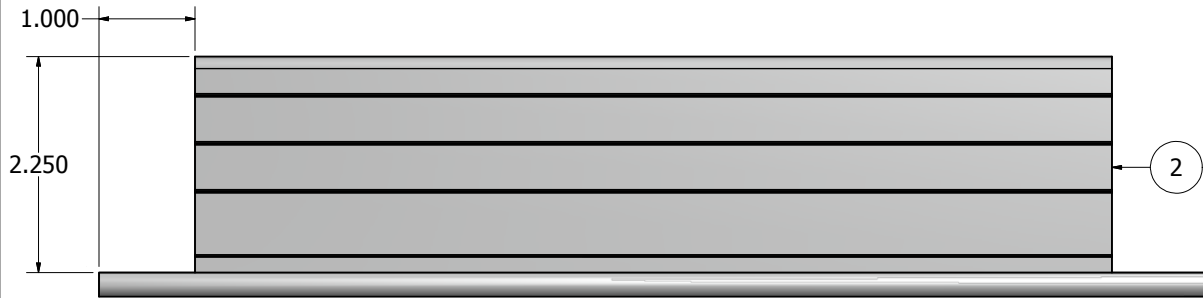

NOTE: NOTCH BOTH ENDS OF THE ANGLE ABOVE TO BYPASS THE INNER BODY FLANGES. THIS SERVES AS A BRACE TO PROVIDE ADDITIONAL SUPPORT TO THE JOINED BODY SECTIONS.

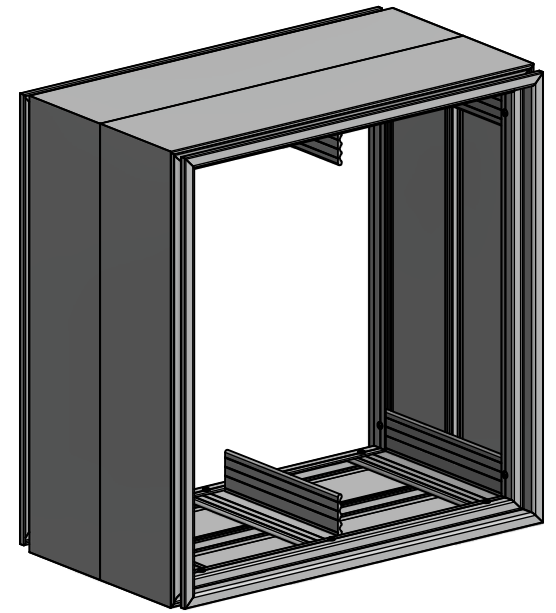
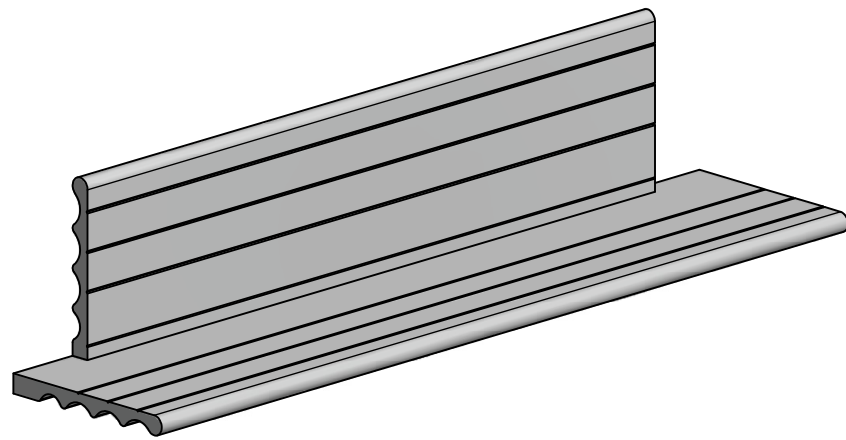

NOTE: BRACES SHOULD BE SPACED A MIN. OF 48" ON CENTER.

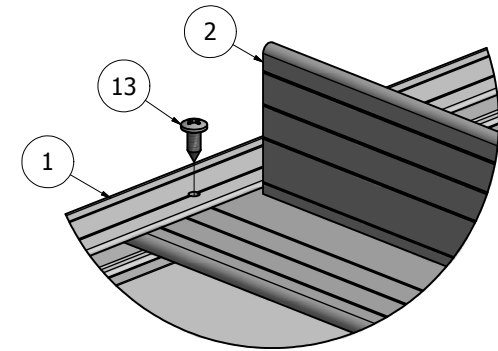

DETAIL C

THIS DRAWING WAS CREATED AT NO CHARGE TO ASSIST YOU IN VISUALIZING OUR PROPOSAL. THE DRAWING HEREIN IS THE PROPERTY OF SIGNCOMP. PERMISSION TO COPY OR REVISE THIS DRAWING OR TO USE THIS DRAWING FOR PRODUCTION IS STRICTLY PROHIBITED AND CAN ONLY BE COPIED, REVISED OR USED FOR PRODUCTION WITH THE EXPRESSED WRITTEN PERMISSION OF SIGNCOMP.

DRAWING BY:	SBreihof	8/14/2013
Centroid X:	0.000 in	
Centroid Y:	0.000 in	
Principal Moments Ix:	0.000 in ⁴	
Principal Moments Iy:	0.000 in ⁴	
Section Modulus Ix:	0.000 in ³	
Section Modulus Iy:	0.000 in ³	

SignComp

Flat 2PC Double Face Medium Body -
Assembly

PART NO	K2010	REV
---------	--------------	-----

PARTS LIST			NOTES
ITEM	PART #	DESCRIPTION	
1	2010	Flat 2PC Double Face Medium Body	All Sides
2	5910	Flat 2PC Double Face Medium Body Corner Angle	Notched by Other
13	5218	Corner Angle Screw	Pre-drill 5/32" pilot hole

ITEM	PART #	DESCRIPTION	NOTES
1	2107	Flat Bleed Retro Frame II	Top & Bottom
2	2107	Flat Bleed Retro Frame II	Sides
3	5305	Frame Corner Angle	Two (2) per corner
13	5218	Corner Angle Screw	#10 x 1/2" pan head tapping

Ship To:
Sales Order #

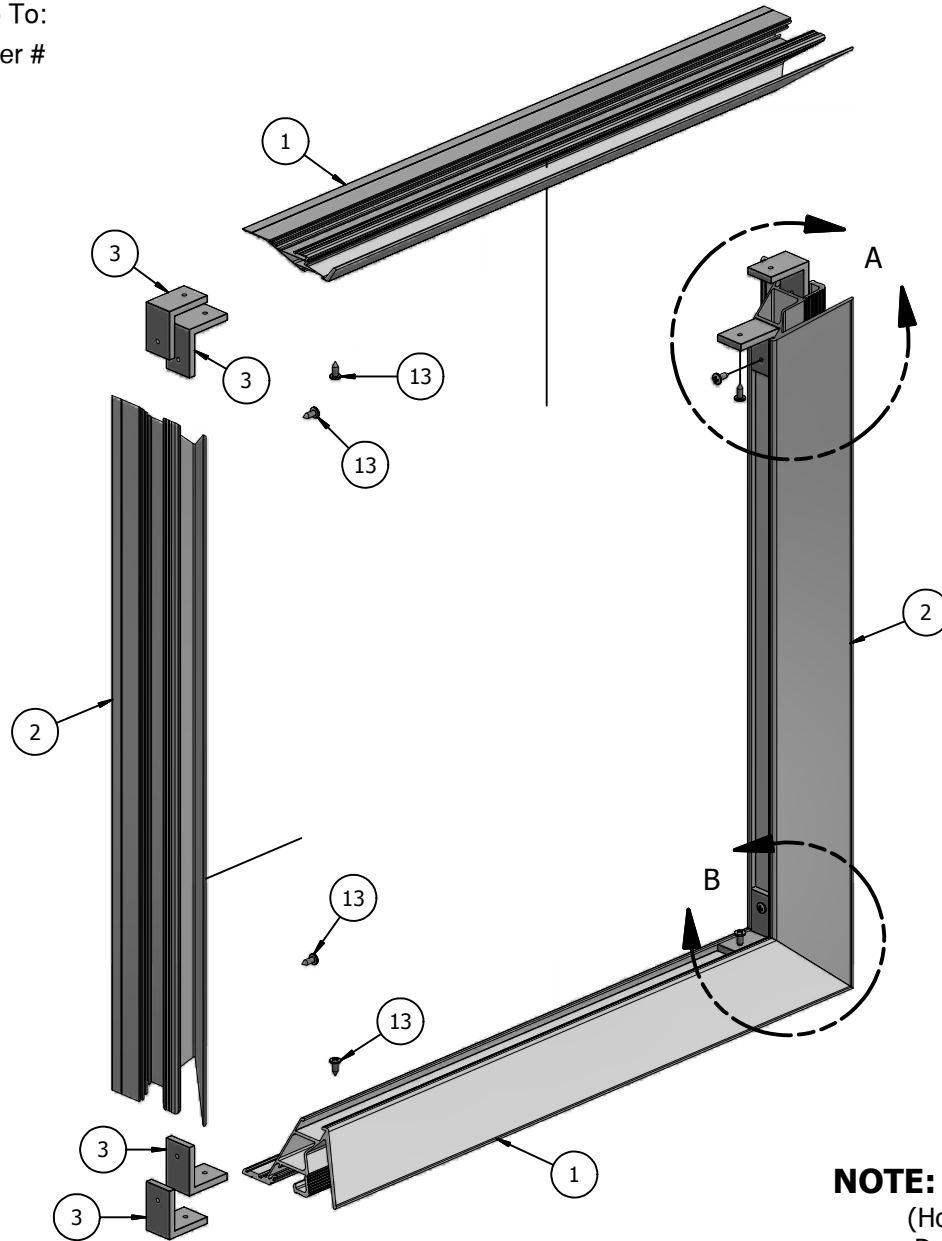

THE OUTER FRAME
CORNER ANGLE FLOATS
IN THE FRAME FOR
ALIGNMENT.

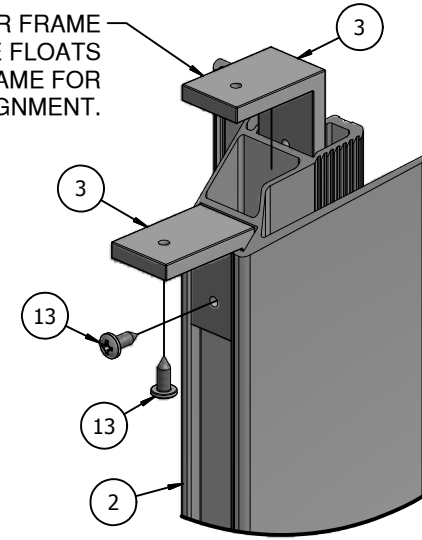

DETAIL A

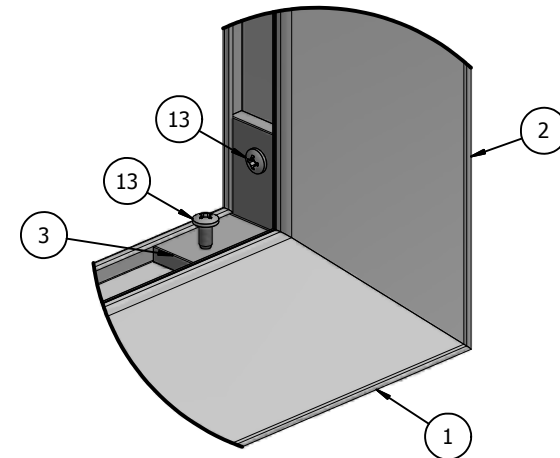

DETAIL B

NOTE: PRE-CUT KITS ARE NOT PRE-DRILLED.

(Holes shown in this drawing are for reference only.
Drilling of pilot holes are to be done by fabricator.)

THIS DRAWING WAS CREATED AT NO CHARGE TO ASSIST YOU IN VISUALIZING OUR PROPOSAL. THE DRAWING HEREIN IS THE PROPERTY OF SIGNCOMP. PERMISSION TO COPY OR REVISE THIS DRAWING OR TO USE THIS DRAWING FOR PRODUCTION IS STRICTLY PROHIBITED AND CAN ONLY BE COPIED, REVISED OR USED FOR PRODUCTION WITH THE EXPRESSED WRITTEN PERMISSION OF SIGNCOMP.

Part Name: Flat Bleed Retro Frame II - Assembly

Part Number: K2107

Revision:

Date: 1/30/2015

Drawing By: SBreihof

Sheet: 1 of 1

Size: A

SignComp

ITEM	PART #	DESCRIPTION	NOTES
1	2107	Flat Bleed Retro Frame II	Assembly
2	2121	Flat Bleed Retro Cover	All Sides
12	5195	Cover Screw	#8x5/16" Pre-drill 1/8" hole

NOTE: PRE-CUT KITS ARE NOT PRE-DRILLED.

(Holes shown in this drawing are for reference only.
Drilling of pilot holes are to be done by fabricator.)

Ship To:
Sales Order #

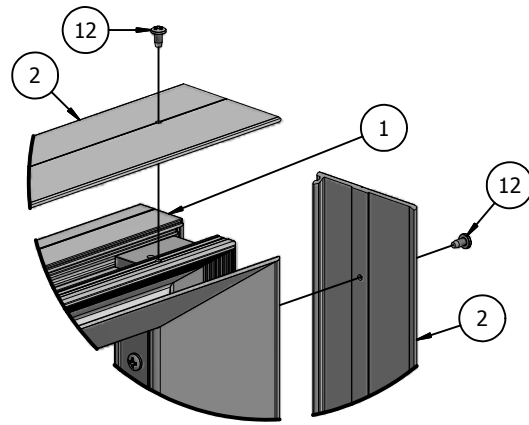
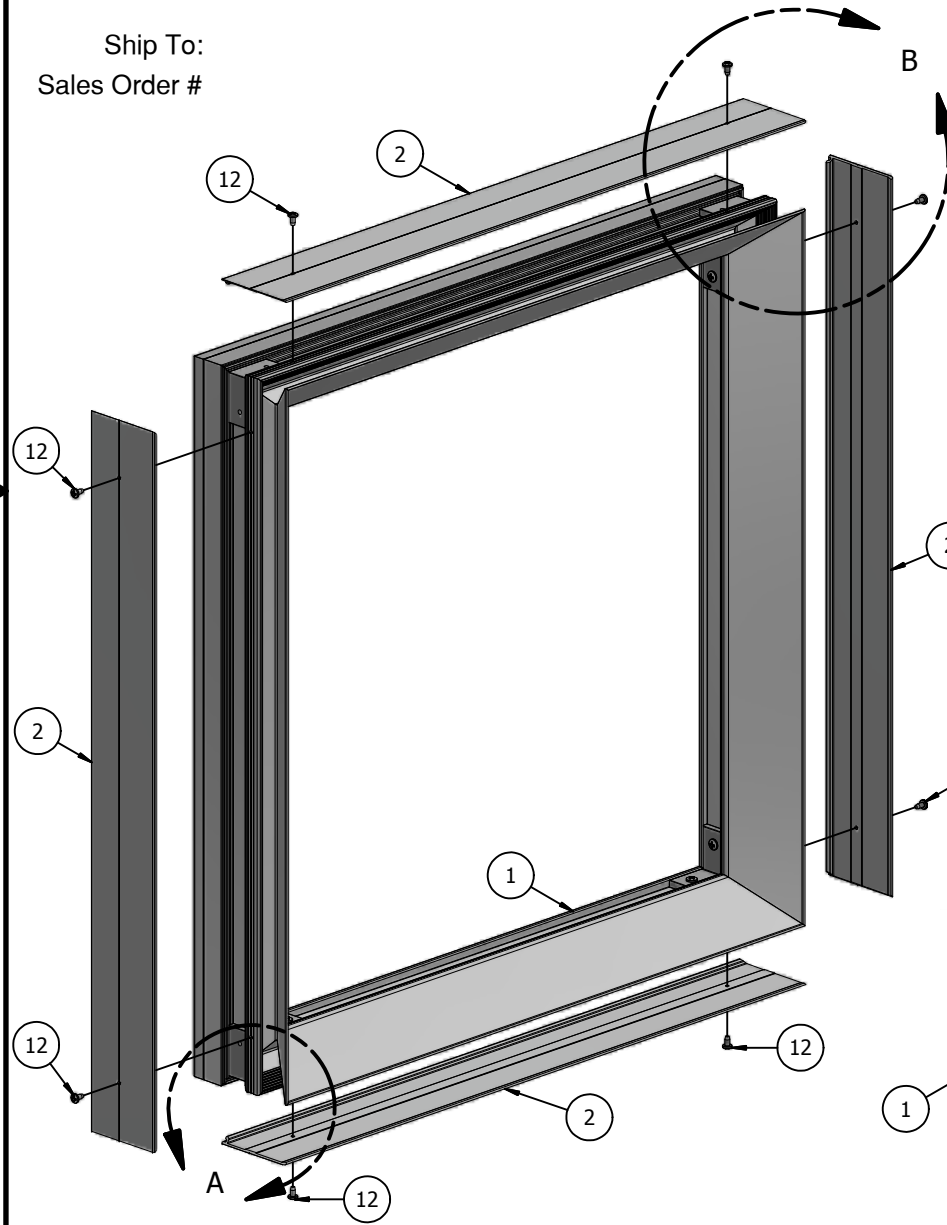

DETAIL B

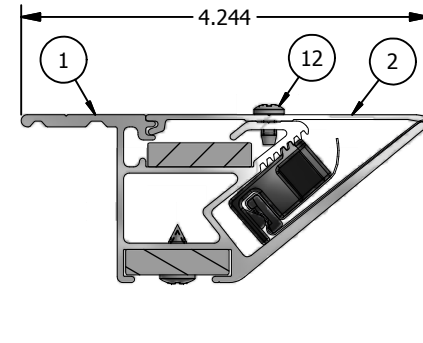

ASSEMBLY CROSS-SECTION

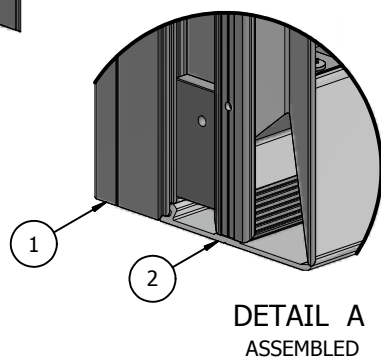

DETAIL A
ASSEMBLED

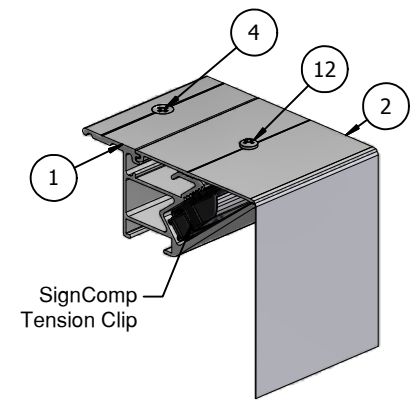

SignComp
Tension Clip

THIS DRAWING WAS CREATED AT NO CHARGE TO ASSIST YOU IN VISUALIZING OUR PROPOSAL. THE DRAWING HEREIN IS THE PROPERTY OF SIGNCOMP. PERMISSION TO COPY OR REVISE THIS DRAWING OR TO USE THIS DRAWING FOR PRODUCTION IS STRICTLY PROHIBITED AND CAN ONLY BE COPIED, REVISED OR USED FOR PRODUCTION WITH THE EXPRESSED WRITTEN PERMISSION OF SIGNCOMP.

Part Name:	Flat Bleed Retro Frame II/Bleed Cover - Assembly	Sheet:	1 of 1	Size:	A
Part Number:	K2107-21	Revision:		Drawing By:	SBreihof
		Date:	1/30/2015		

SignComp