

PARTS LIST			
ITEM	PART #	DESCRIPTION	NOTES
1	K2015/4050	Medium Body w/ 9in Radius Corners	Assembly
2	K2086/95/4250	Tension Frame II & Bleed Cover w/ 9in Radius Corners & Covers	Assembly
10	5170	Hinge Screw	Drill 3/8" pilot hole
11	5180	Closure Screw	Drill 5/16" pilot hole

NOTE: PRE-CUT KITS ARE NOT PRE-DRILLED.
 (Holes shown in this drawing are for reference only.
 Drilling of pilot holes are to be done by fabricator.)

***NOTE:** Drill a 3/8" oversized hole for the head of the hinge screw to slip through.

***NOTE:** IT IS RECOMMENDED THAT THE FRAME BE ASSEMBLED ON THE BODY, THEN RATCHET STRAPPED TO CHECK FOR SQUARE, BEFORE THE FRAME IS WELDED OR MECHANICALLY FASTENED.

Ship To:
Sales Order #

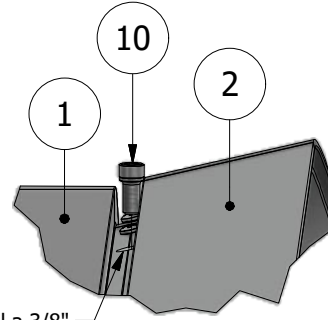
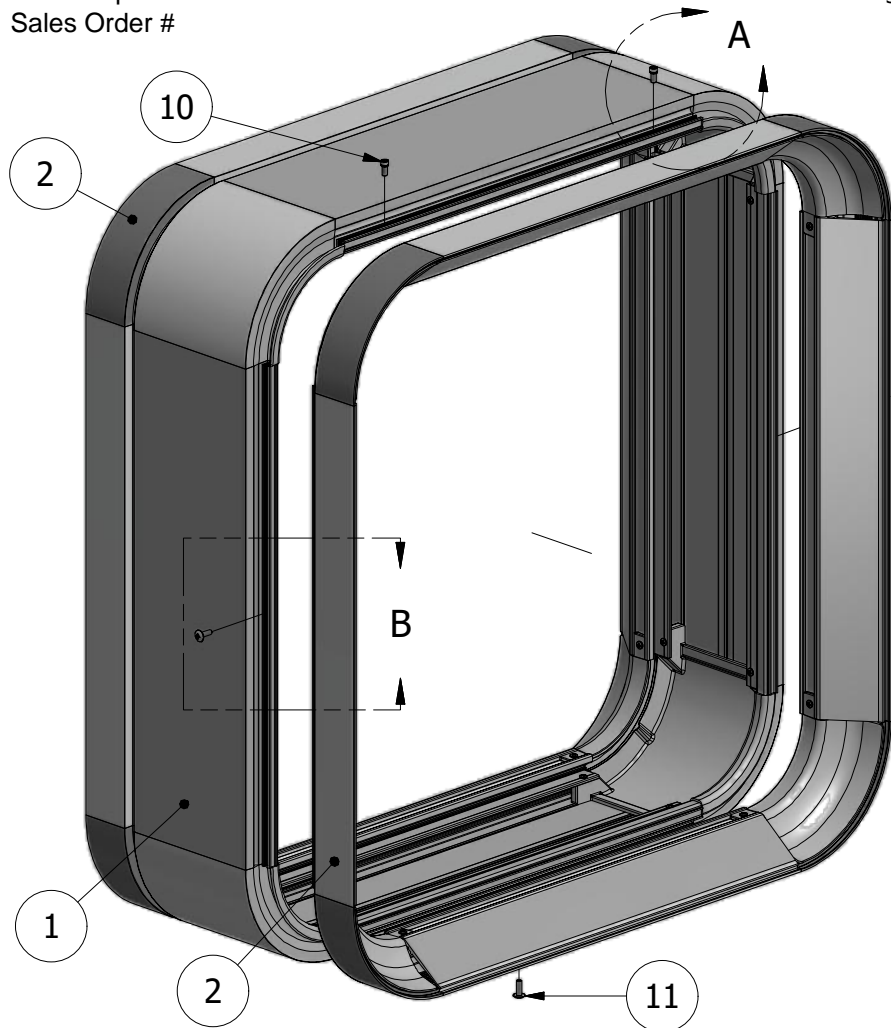

DETAIL A

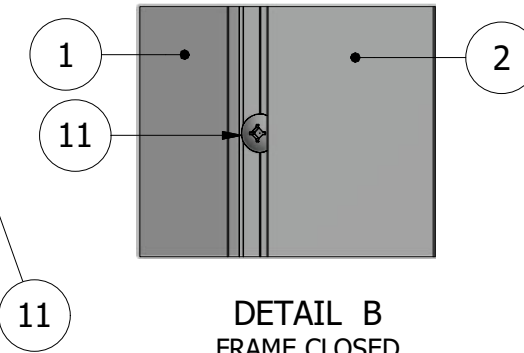

DETAIL B
FRAME CLOSED

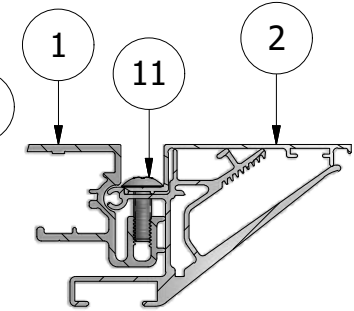

DETAIL B
CROSS-SECTION

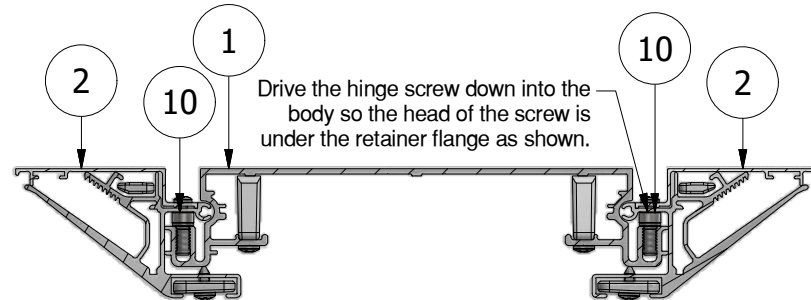

TOP CROSS-SECTION

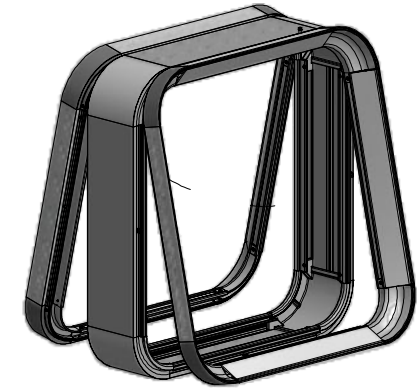

THIS DRAWING WAS CREATED AT NO CHARGE TO ASSIST YOU IN VISUALIZING OUR PROPOSAL. THE DRAWING HEREIN IS THE PROPERTY OF SIGNCOMP. PERMISSION TO COPY OR REVISE THIS DRAWING OR TO USE THIS DRAWING FOR PRODUCTION IS STRICTLY PROHIBITED AND CAN ONLY BE COPIED, REVISED OR USED FOR PRODUCTION WITH THE EXPRESSED WRITTEN PERMISSION OF SIGNCOMP.

Project Name: Medium Body w/ Tension Frame II & Bleed Cvr-9" Rad. Corners
 Sign Company: KMB/86/95/4557
 Sheet: 1 of 1
 Date: 5/23/2019
 Drawing By: SBreihof
 Size: A

SignComp

PARTS LIST			
ITEM	PART #	DESCRIPTION	NOTES
1	2015	Medium Body	Top & Bottom
2	2015	Medium Body	Sides
3	4050	Medium Body 9in Radius Corner	
65	5218	Radius Corner Screw	Drill 5/32" pilot hole

***NOTE:** RADIUS CORNERS ARE DESIGNED TO BE WELDED, HOWEVER CAN ALSO BE MECHANICALLY ASSEMBLED.

Ship To:
Sales Order#

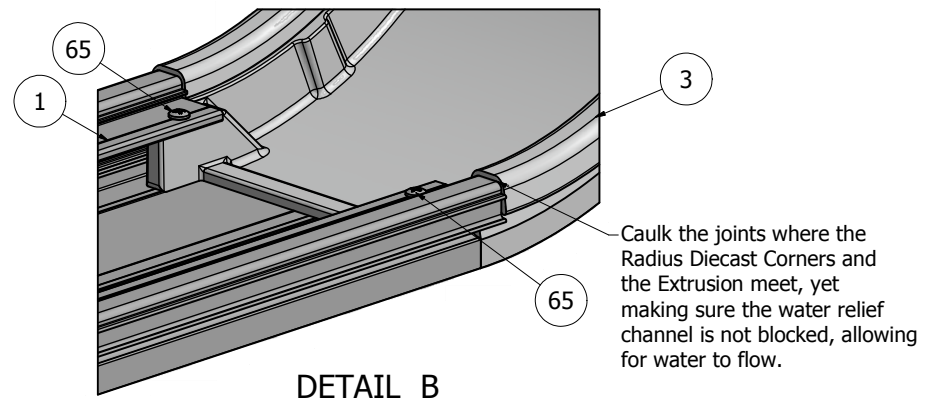
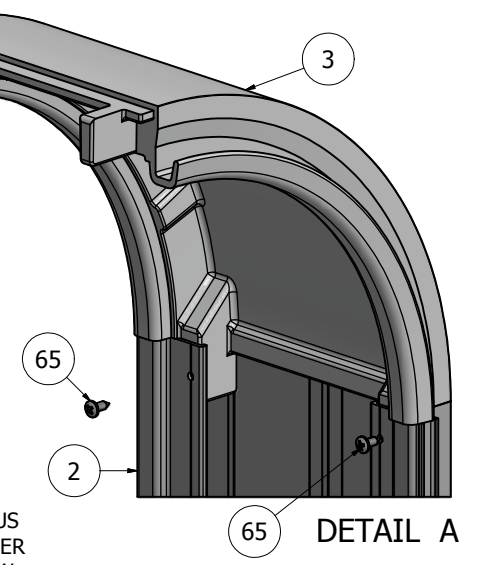
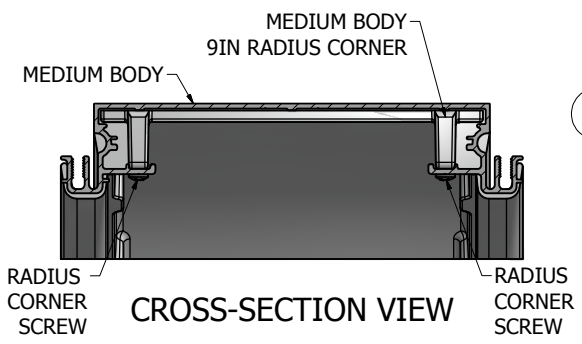
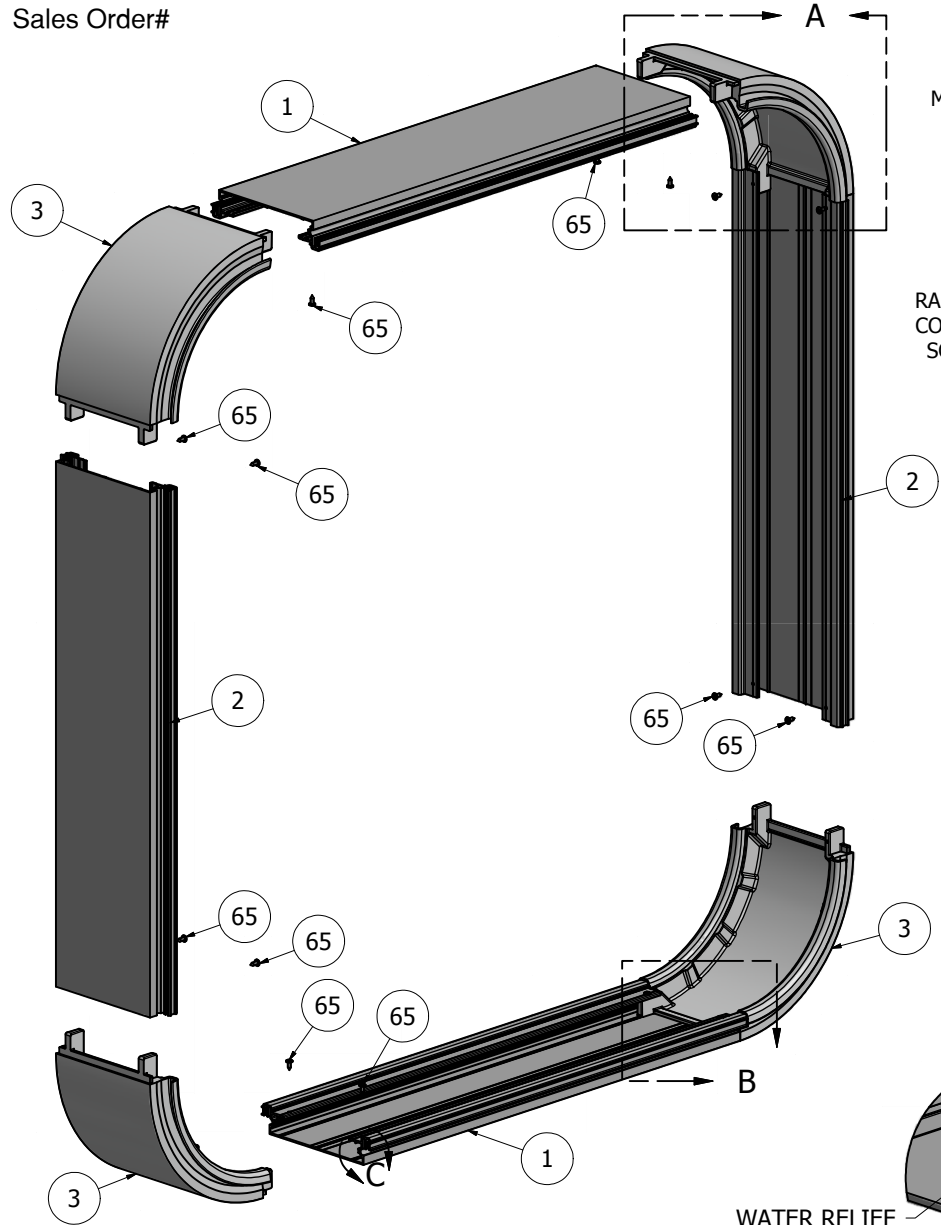

NOTE: PRE-CUT KITS ARE NOT PRE-DRILLED.
(Holes shown in this drawing are for reference only. Drilling of pilot holes are to be done by fabricator.)

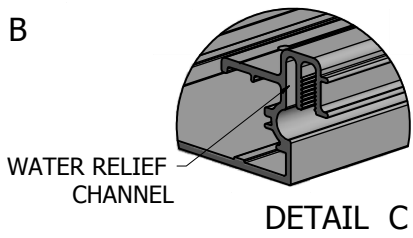

THIS DRAWING WAS CREATED AT NO CHARGE TO ASSIST YOU IN VISUALIZING OUR PROPOSAL. THE DRAWING HEREIN IS THE PROPERTY OF SIGNCOMP. PERMISSION TO COPY OR REVISE THIS DRAWING OR TO USE THIS DRAWING FOR PRODUCTION IS STRICTLY PROHIBITED AND CAN ONLY BE COPIED, REVISED OR USED FOR PRODUCTION WITH THE EXPRESSED WRITTEN PERMISSION OF SIGNCOMP.

DRAWING BY:	SBreihof	6/26/2013
Centroid X:	0.000 in	
Centroid Y:	0.000 in	
Principal Moments Ix:	0.000 in ⁴	
Principal Moments Iy:	0.000 in ⁴	
Section Modulus Ix:	0.000 in ³	
Section Modulus Iy:	0.000 in ³	

SignComp		TITLE
		Medium Body w/ 9in Radius Corners - Assembly
PART NO	KMB-4050	REV
SHEET 1 OF 1		

PARTS LIST			
ITEM	PART #	DESCRIPTION	NOTES
1	2086	Tension Frame II	Top & Bottom
2	2086	Tension Frame II	Sides
3	4250	9in Tension Frame II Radius Corner	All 4 Corners
65	5218	Radius Corner Screw	Drill 5/32" pilot hole

NOTE: PRE-CUT KITS ARE NOT PRE-DRILLED.
 (Holes shown in this drawing are for reference only.
 Drilling of pilot holes are to be done by fabricator.)

Ship To:
 Sales Order #

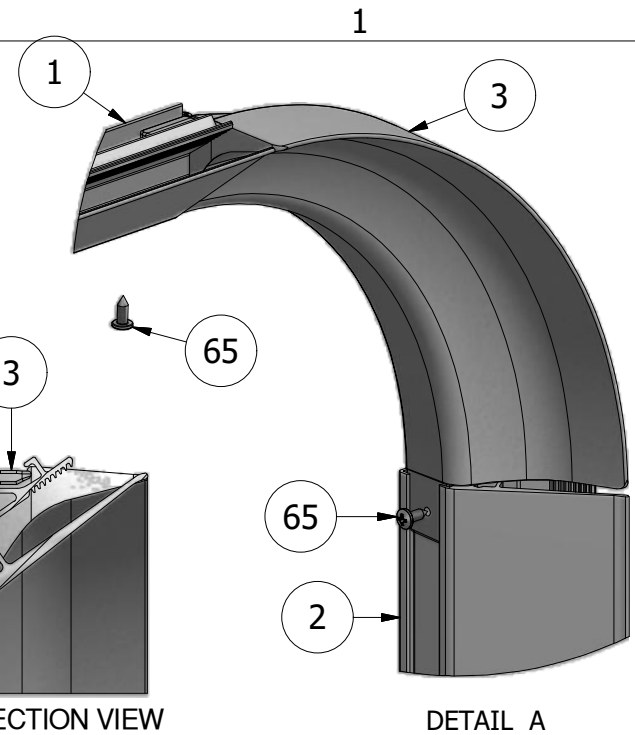
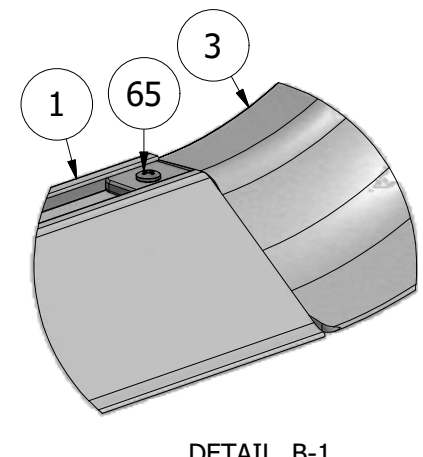
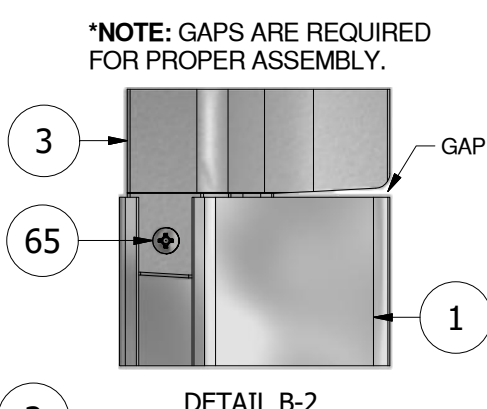
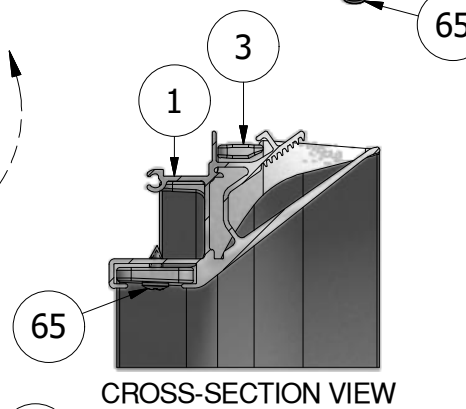
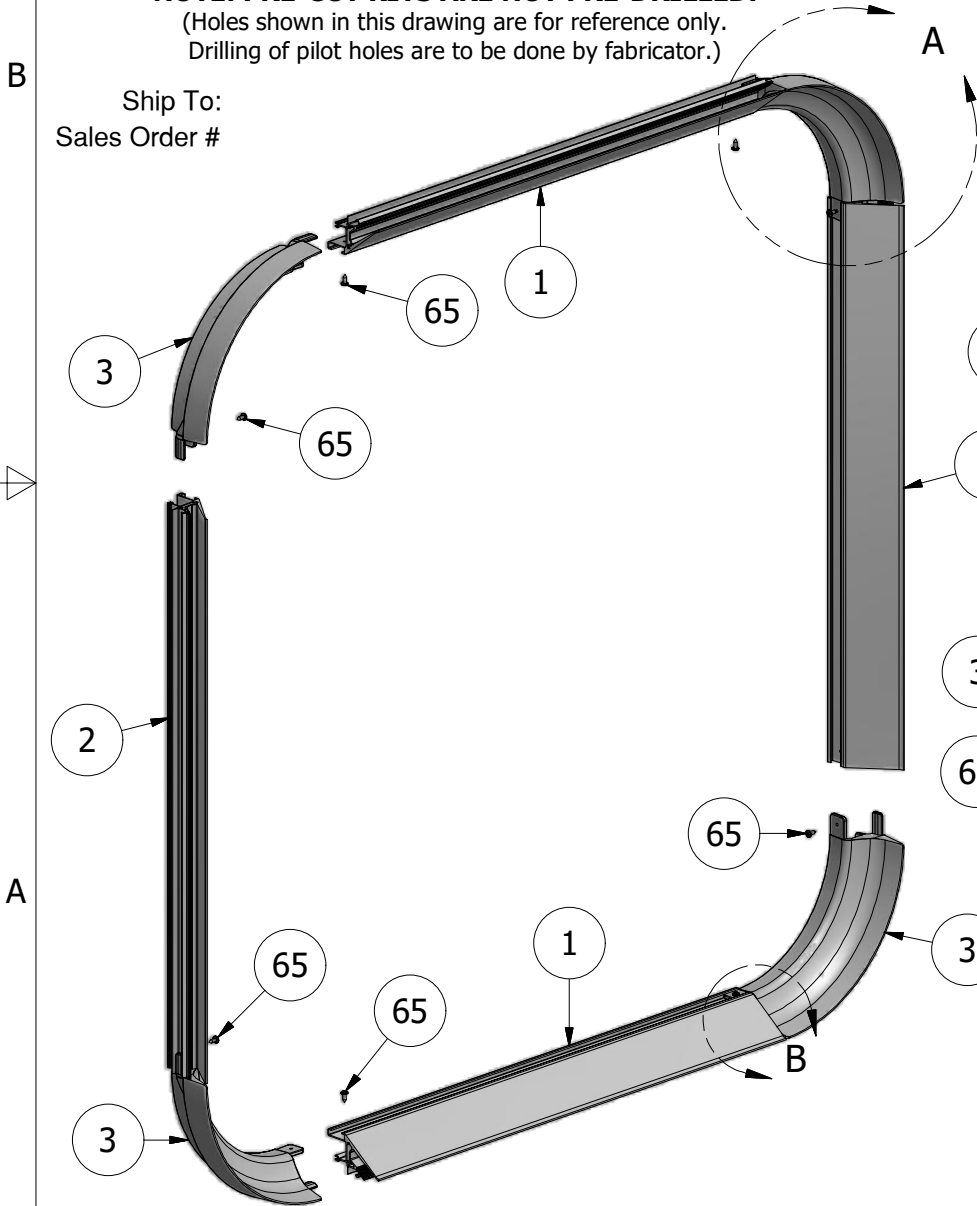

***NOTE: IT IS RECOMMENDED THAT THE FRAME BE ASSEMBLED ON THE BODY, THEN RATCHET STRAPPED TO CHECK FOR SQUARE, BEFORE THE FRAME IS WELDED OR MECHANICALLY FASTENED.**

THIS DRAWING WAS CREATED AT NO CHARGE TO ASSIST YOU IN VISUALIZING OUR PROPOSAL. THE DRAWING HEREIN IS THE PROPERTY OF SIGNCOMP. PERMISSION TO COPY OR REVISE THIS DRAWING OR TO USE THIS DRAWING FOR PRODUCTION IS STRICTLY PROHIBITED AND CAN ONLY BE COPIED, REVISED OR USED FOR PRODUCTION WITH THE EXPRESSED WRITTEN PERMISSION OF SIGNCOMP.

Project Name: Tension Frame II with 9" Rad. Corners - Assembly
 Sign Company: K2086-4250
 Revision: 5/14/2019
 Date: 5/14/2019
 Sheet: 1 of 1
 Drawing By: SBreihof
 Size: A



PARTS LIST

ITEM	PART #	DESCRIPTION	NOTES
1	K2086/4250	Tension Frame II w/ 9in Radius Corners	Assembly
2	2095	Bleed Tension Frame Cover	Top & Bottom
3	2095	Bleed Tension Frame Cover	Sides
4	4260P	9in Bleed Tension Frame Radius Cover	
12	5195	Cover Screw	Pre-drill 3/32" hole
15	5195	Radius Corner Cover Screw	Pre-drill 3/32" hole

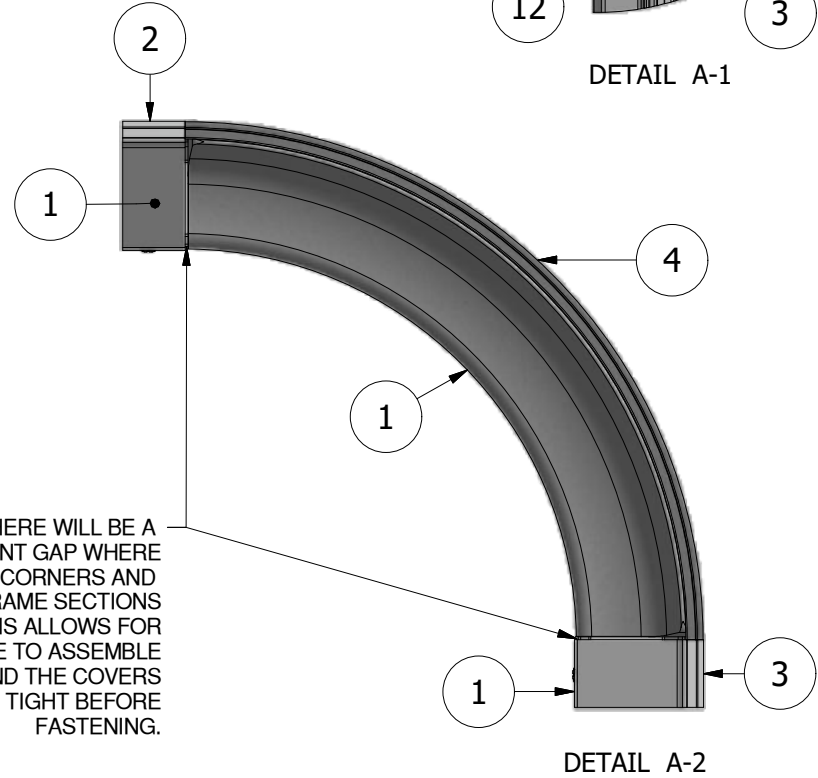
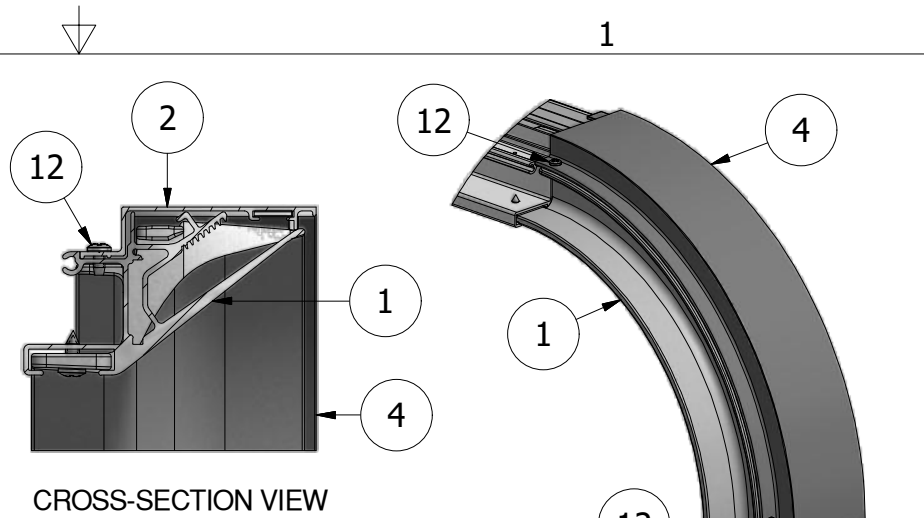
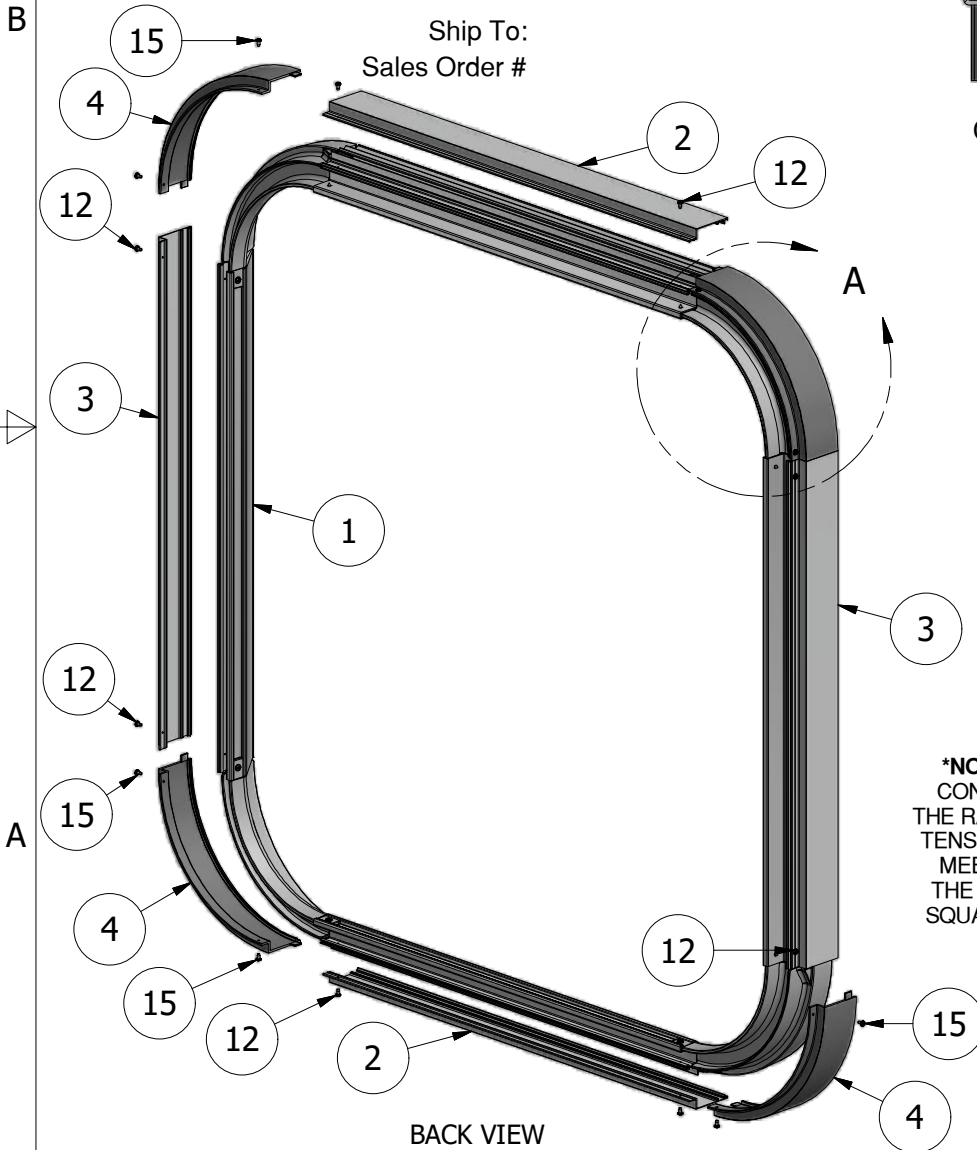

***NOTE:** THERE WILL BE A CONSISTANT GAP WHERE THE RADIUS CORNERS AND TENSION FRAME SECTIONS MEET. THIS ALLOWS FOR THE FRAME TO ASSEMBLE SQUARE AND THE COVERS TO FIT TIGHT BEFORE FASTENING.

NOTE: PRE-CUT KITS ARE NOT PRE-DRILLED.
(Holes shown in this drawing are for reference only. Drilling of pilot holes are to be done by fabricator.)

THIS DRAWING WAS CREATED AT NO CHARGE TO ASSIST YOU IN VISUALIZING OUR PROPOSAL. THE DRAWING HEREIN IS THE PROPERTY OF SIGNCOMP. PERMISSION TO COPY OR REVISE THIS DRAWING OR TO USE THIS DRAWING FOR PRODUCTION IS STRICTLY PROHIBITED AND CAN ONLY BE COPIED, REVISED OR USED FOR PRODUCTION WITH THE EXPRESSED WRITTEN PERMISSION OF SIGNCOMP.

SignComp	Size: A
	Drawing By: SBreihof
Sheet: 1 of 1	Date: 5/14/2019
Revision: _____	Part #: _____
Project Name: Tension Frame II and Bleed Cover - 9" Rad. Covers - Assembly	
Sign Company: K2086-95-4260P	

ITEM	PART #	DESCRIPTION
1	2015	Medium Body
2		MB Support Mounting Plate - By Other
3		Main Support Plate Bolt Assembly
4		Main Support
5	5116	Raceway Cover - Blank
6		Lamp & Socket
7	2086	Tension Frame II
8	5210	Corner Key
9	5305	Frame Corner Angle
10	5352	Small Frame Brace
11	2095	Bleed Tension Frame Cover
12	2177	Small Frame Support Tube - 1"

NOTE: PRE-CUT KITS ARE NOT PRE-DRILLED.
 (Holes shown in this drawing are for reference only.
 Drilling of pilot holes are to be done by fabricator.)

NOTE: FRAME BRACING GUIDELINES APPLY FOR BOTH THE BLEED AND FRAMED COVERS.

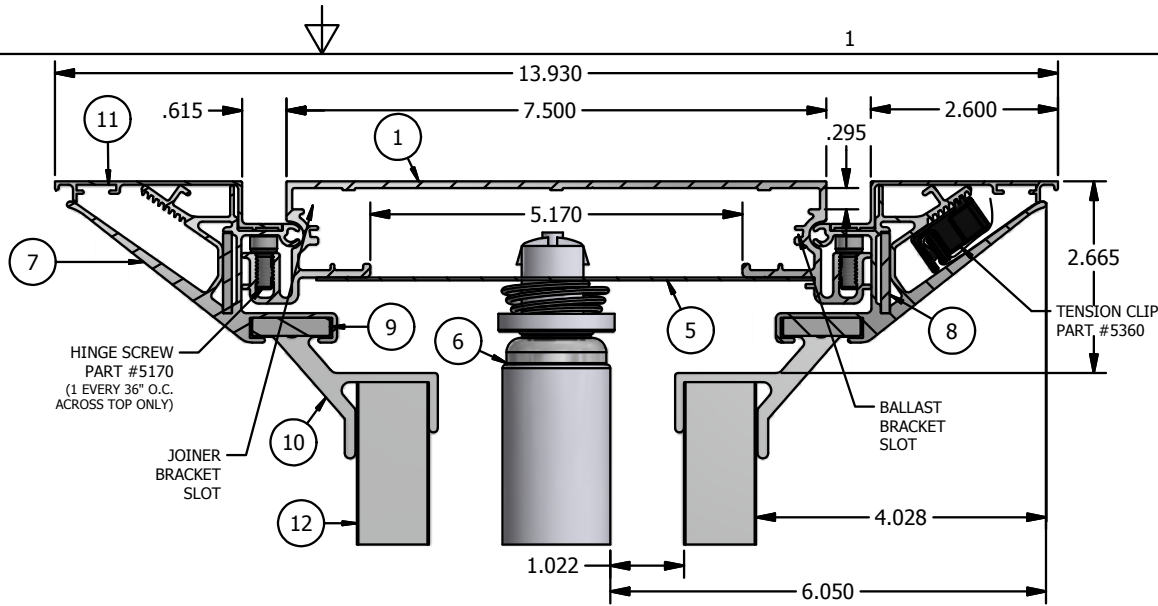

SECTION VIEW - ELECTRICAL

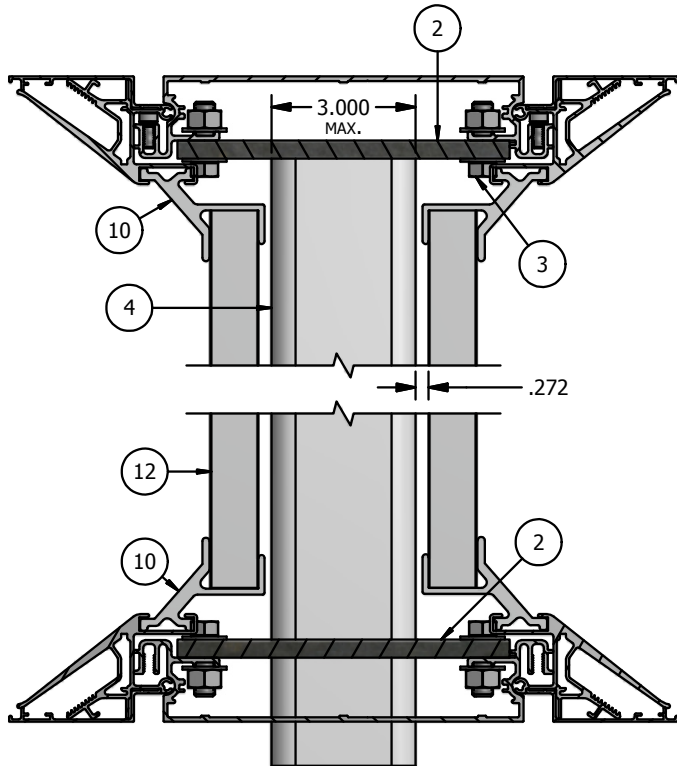

SECTION VIEW - STRUCTURAL

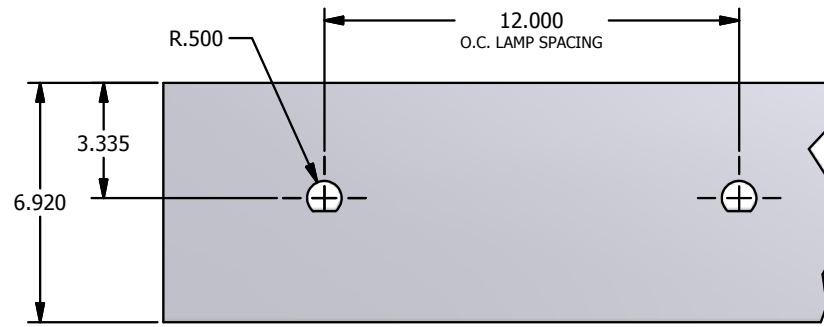

RACEWAY D-PUNCH DETAIL

NOTES:

1. ADD 1" TO SIZE OF CABINET (VERTICAL OR HORIZONTAL) WHEN THE SIZE OF THE CABINET IS THE SAME SIZE AS THE NOMINAL LAMP LENGTH.
2. SIGNCOMP DOES NOT SUPPLY THE BALLAST(S), LAMPS OR LAMP SOCKETS.
3. SIGNCOMP DOES NOT SUPPLY MAIN SUPPORT.

NOTE:

All structural detailing for sign construction is the sole responsibility of the sign contractor. All details shown here should be considered as **DESIGN INTENT ONLY**. The sign fabricator shall provide engineering drawings stamped by a licenced structural engineer.

THIS DRAWING WAS CREATED AT NO CHARGE TO ASSIST YOU IN VISUALIZING OUR PROPOSAL. THE DRAWING HEREIN IS THE PROPERTY OF SIGNCOMP. PERMISSION TO COPY OR REVISE THIS DRAWING OR TO USE THIS DRAWING FOR PRODUCTION IS STRICTLY PROHIBITED AND CAN ONLY BE COPIED, REVISED OR USED FOR PRODUCTION WITH THE EXPRESSED WRITTEN PERMISSION OF SIGNCOMP.

Project Name:	MB w/ Tension Frame II & Cover - Cross Sect.
Sign Company:	SignComp
Revision:	9/15/2014
Drawing By:	SBreihof
Sheet:	1 of 1
Size:	A

SignComp

2

1

2

1

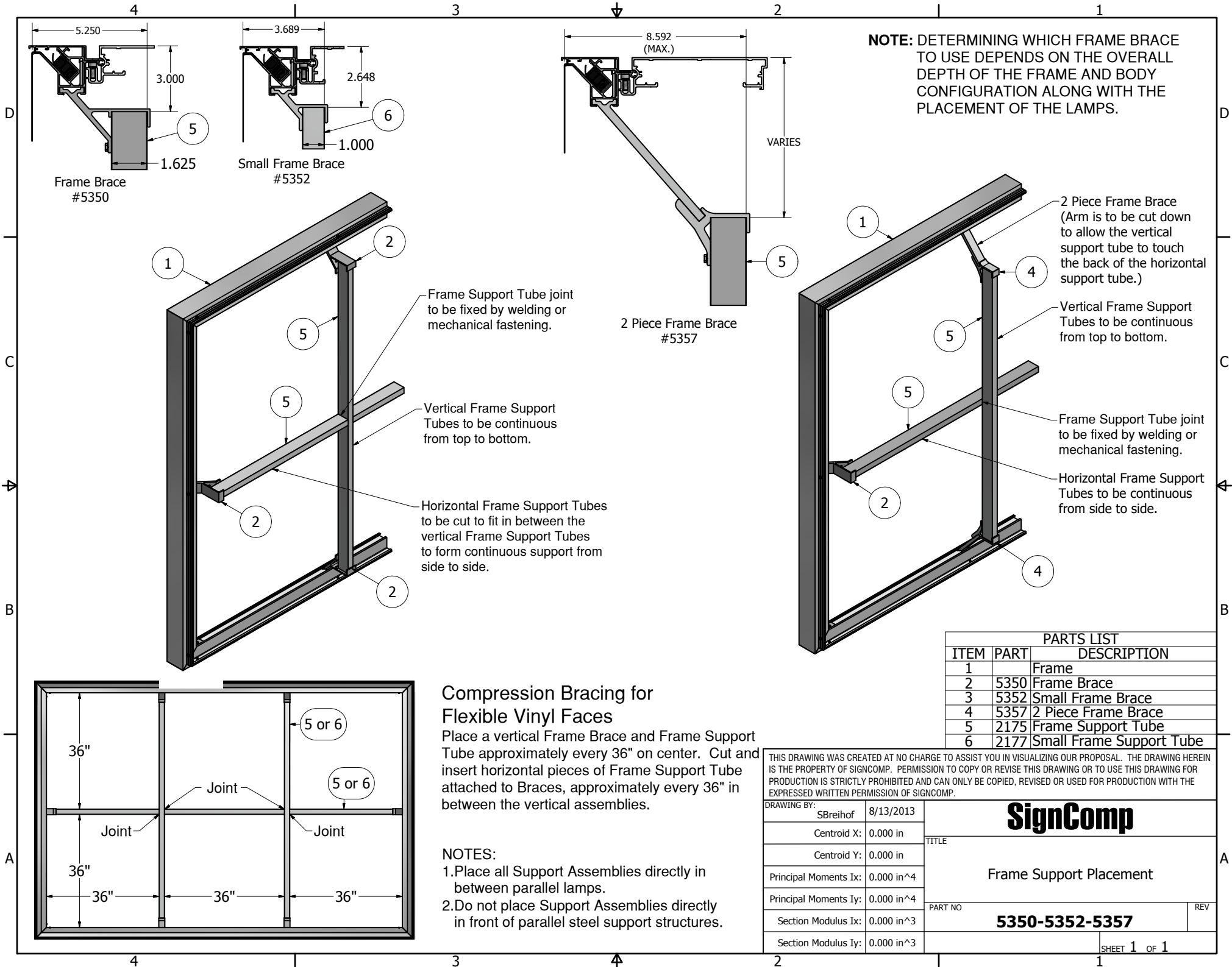

NOTE: DETERMINING WHICH FRAME BRACE TO USE DEPENDS ON THE OVERALL DEPTH OF THE FRAME AND BODY CONFIGURATION ALONG WITH THE PLACEMENT OF THE LAMPS.

Frame Support Tube joint to be fixed by welding or mechanical fastening.

Vertical Frame Support Tubes to be continuous from top to bottom.

Horizontal Frame Support Tubes to be cut to fit in between the vertical Frame Support Tubes to form continuous support from side to side.

2 Piece Frame Brace (Arm is to be cut down to allow the vertical support tube to touch the back of the horizontal support tube.)

Vertical Frame Support Tubes to be continuous from top to bottom.

Frame Support Tube joint to be fixed by welding or mechanical fastening.

Horizontal Frame Support Tubes to be continuous from side to side.

PARTS LIST		
ITEM	PART	DESCRIPTION
1		Frame
2	5350	Frame Brace
3	5352	Small Frame Brace
4	5357	2 Piece Frame Brace
5	2175	Frame Support Tube
6	2177	Small Frame Support Tube

Compression Bracing for Flexible Vinyl Faces

Place a vertical Frame Brace and Frame Support Tube approximately every 36" on center. Cut and insert horizontal pieces of Frame Support Tube attached to Braces, approximately every 36" in between the vertical assemblies.

- NOTES:**
1. Place all Support Assemblies directly in between parallel lamps.
 2. Do not place Support Assemblies directly in front of parallel steel support structures.

THIS DRAWING WAS CREATED AT NO CHARGE TO ASSIST YOU IN VISUALIZING OUR PROPOSAL. THE DRAWING HEREIN IS THE PROPERTY OF SIGNCOMP. PERMISSION TO COPY OR REVISE THIS DRAWING OR TO USE THIS DRAWING FOR PRODUCTION IS STRICTLY PROHIBITED AND CAN ONLY BE COPIED, REVISED OR USED FOR PRODUCTION WITH THE EXPRESSED WRITTEN PERMISSION OF SIGNCOMP.

DRAWING BY:	SBreihof	8/13/2013
Centroid X:	0.000 in	
Centroid Y:	0.000 in	
Principal Moments Ix:	0.000 in^4	
Principal Moments Iy:	0.000 in^4	
Section Modulus Ix:	0.000 in^3	
Section Modulus Iy:	0.000 in^3	

SignComp

TITLE
Frame Support Placement

PART NO
5350-5352-5357

REV

SHEET 1 OF 1