

PARTS LIST			
ITEM	PART #	DESCRIPTION	NOTES
1	K2020	Slimline Single Face Body	Assembly
2	K2086/95	Tension Frame II and Bleed Cover	Assembly
10	5170	Hinge Screw	Drill a 3/8" pilot hole
11	5180	Closure Screw	Drill a 5/16" pilot hole

Ship To:  
Sales Order #

**\*NOTE:** Drill a 3/8" oversized hole for the head of the hinge screw to slip through.

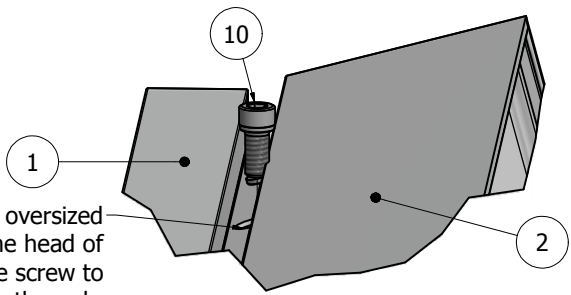
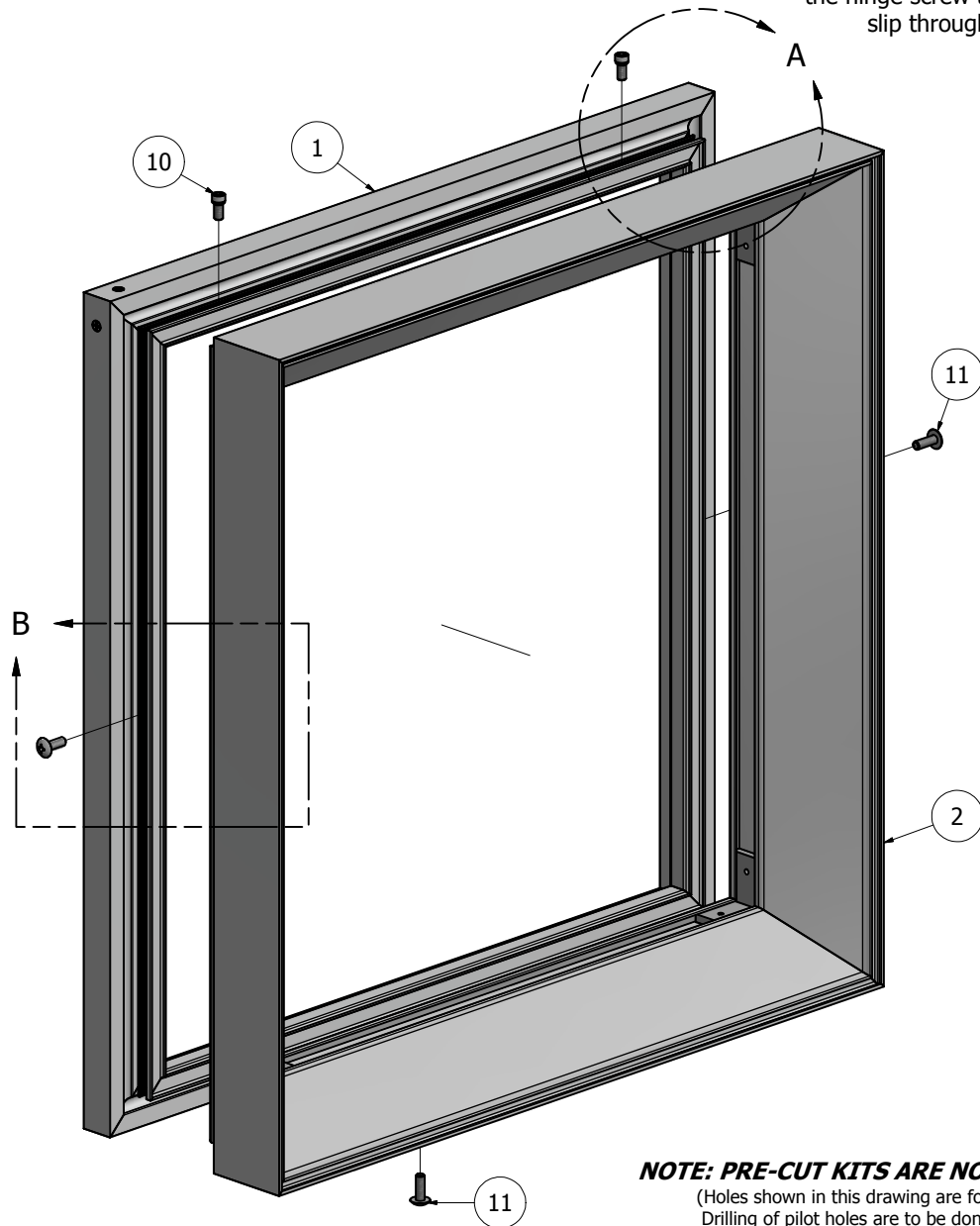

DETAIL A  
FRAME HINGED

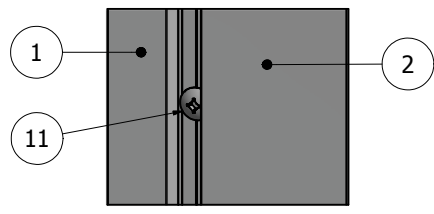
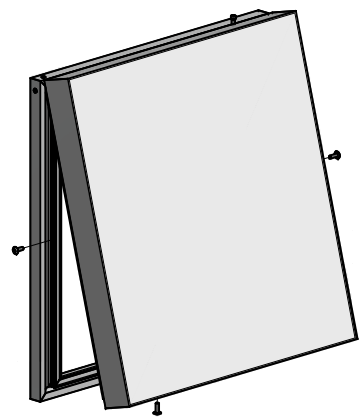

DETAIL B  
FRAME CLOSED

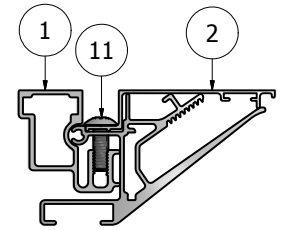

SIDE CROSS-SECTION  
FRAME CLOSED

Drive the hinge screw down into the body so the head of the screw is under the retainer flange as shown.

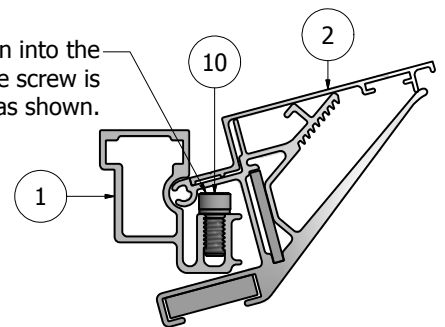

TOP CROSS-SECTION VIEW

THIS DRAWING WAS CREATED AT NO CHARGE TO ASSIST YOU IN VISUALIZING OUR PROPOSAL. THE DRAWING HEREIN IS THE PROPERTY OF SIGNCOMP. PERMISSION TO COPY OR REVISE THIS DRAWING OR TO USE THIS DRAWING FOR PRODUCTION IS STRICTLY PROHIBITED AND CAN ONLY BE COPIED, REVISED OR USED FOR PRODUCTION WITH THE EXPRESSED WRITTEN PERMISSION OF SIGNCOMP.

DRAWING BY:	SBreihof	7/1/2014
Centroid X:	0.000 in	
Centroid Y:	0.000 in	
Principal Moments Ix:	0.000 in^4	
Principal Moments Iy:	0.000 in^4	
Section Modulus Ix:	0.000 in^3	
Section Modulus Iy:	0.000 in^3	

<b>SignComp</b>		
TITLE Slimline Single Face Body w/ Tension Frame II and Bleed Cover - Assembly		
PART NO	<b>K2020-86-95</b>	REV
SHEET 1 OF 1		

**NOTE: PRE-CUT KITS ARE NOT PRE-DRILLED.**  
(Holes shown in this drawing are for reference only.  
Drilling of pilot holes are to be done by fabricator.)

Parts List			
ITEM	PART#	DESCRIPTION	NOTES
1	2020	Slimline Single Face Body	Top & Bottom
2	2020	Slimline Single Face Body	Sides
3	5320	Slimline Body Corner Angle	
4	By Other	Frame Angle Fastener - Optional	NOT PROVIDED BY SIGNCOMP

THIS AREA ALLOWS FOR ADHESIVE OR BONDING AGENT. ADHESIVE MUST BE APPLIED BEFORE THE ANGLE IS INSERTED.

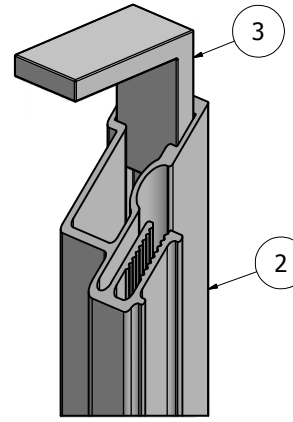
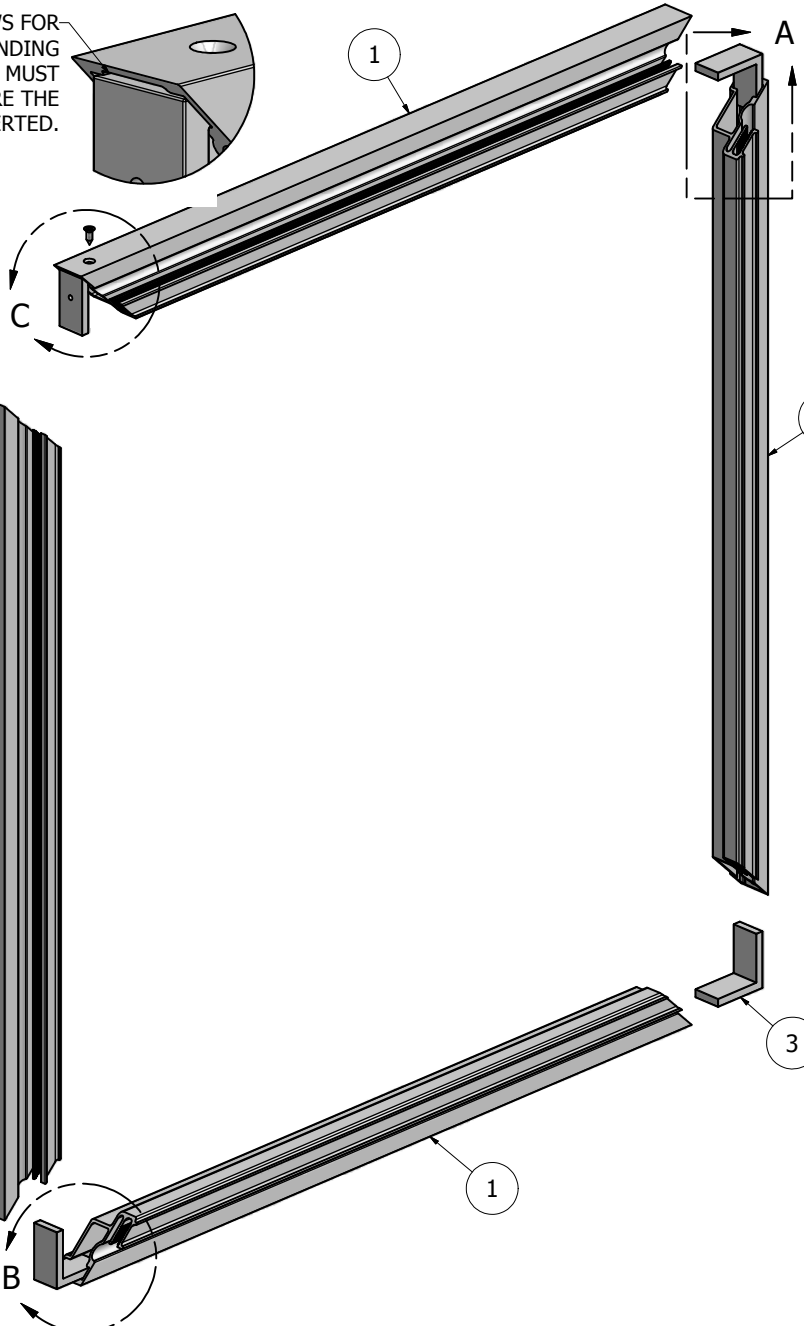

DETAIL A

Ship To:  
Order Number:

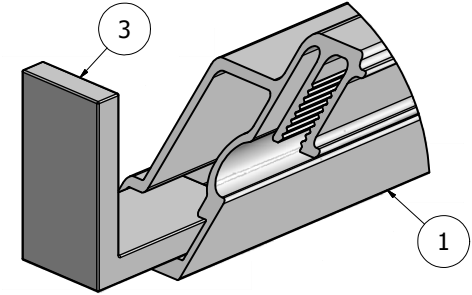

DETAIL B

\*OPTIONAL FASTENER-ASSEMBLY - FRAME IS DESIGNED TO BE BONDED OR WELDED.

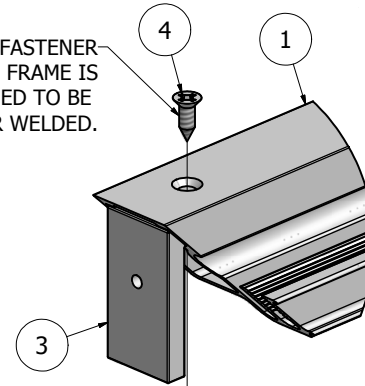

DETAIL C

**NOTE: PRE-CUT KITS ARE NOT PRE-DRILLED.**

(Holes shown in this drawing are for reference only. Drilling of pilot holes are to be done by fabricator.)

THIS DRAWING WAS CREATED AT NO CHARGE TO ASSIST YOU IN VISUALIZING OUR PROPOSAL. THE DRAWING HEREIN IS THE PROPERTY OF SIGNCOMP. PERMISSION TO COPY OR REVISE THIS DRAWING OR TO USE THIS DRAWING FOR PRODUCTION IS STRICTLY PROHIBITED AND CAN ONLY BE COPIED, REVISED OR USED FOR PRODUCTION WITH THE EXPRESSED WRITTEN PERMISSION OF SIGNCOMP.

DRAWN	Sarah	4/30/2012
Centroid X:	0.000 in	
Centroid Y:	0.000 in	
Principal Moments Ix:	0.000 in <sup>4</sup>	
Principal Moments Iy:	0.000 in <sup>4</sup>	
Section Modulus Ix:	0.000 in <sup>3</sup>	
Section Modulus Iy:	0.000 in <sup>3</sup>	

**SignComp**

TITLE  
Slimline Single Face Body - Assembly

DWG NO

**K2020**

REV

PARTS LIST			
ITEM	PART#	DESCRIPTION	NOTES
1	2086	Tension Frame II	Top & Bottom
2	2086	Tension Frame II	Sides
3	5210	Corner Key	
4	5305	Frame Corner Angle	
85	5218	Corner Angle Screw	Pre-drill 5/32" hole

THE CORNER KEYS FLOAT IN THE EXTRUSION HELPING TO ALIGN THE MITERS AND ADD STRENGTH.

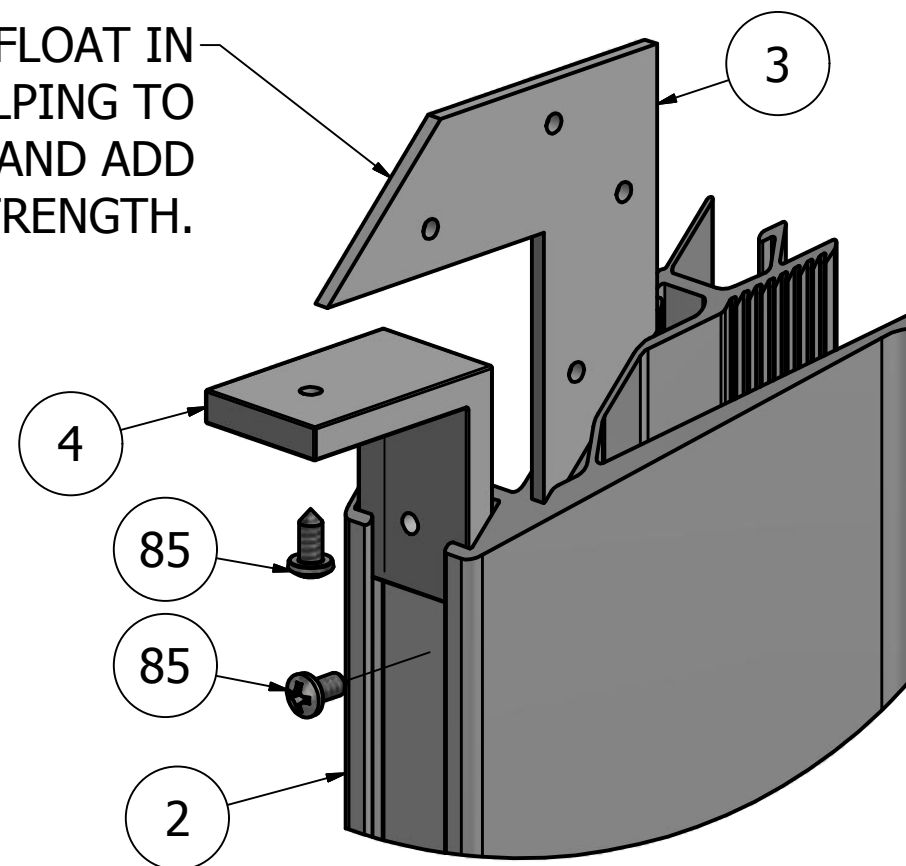

DETAIL A

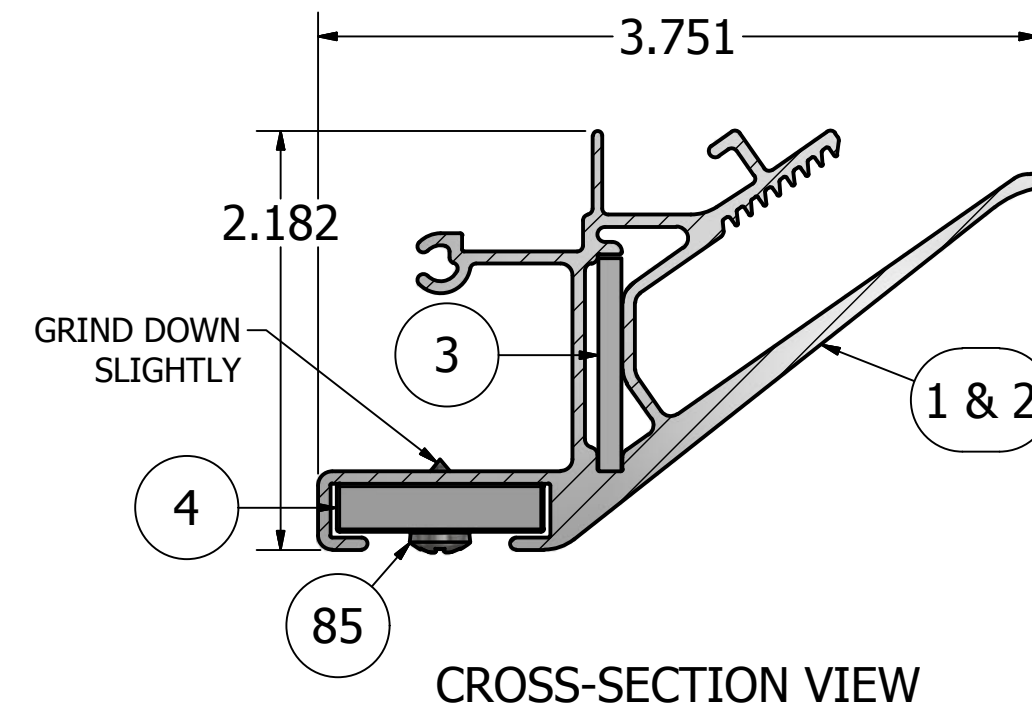

CROSS-SECTION VIEW

SHIP TO:  
SALES ORDER #

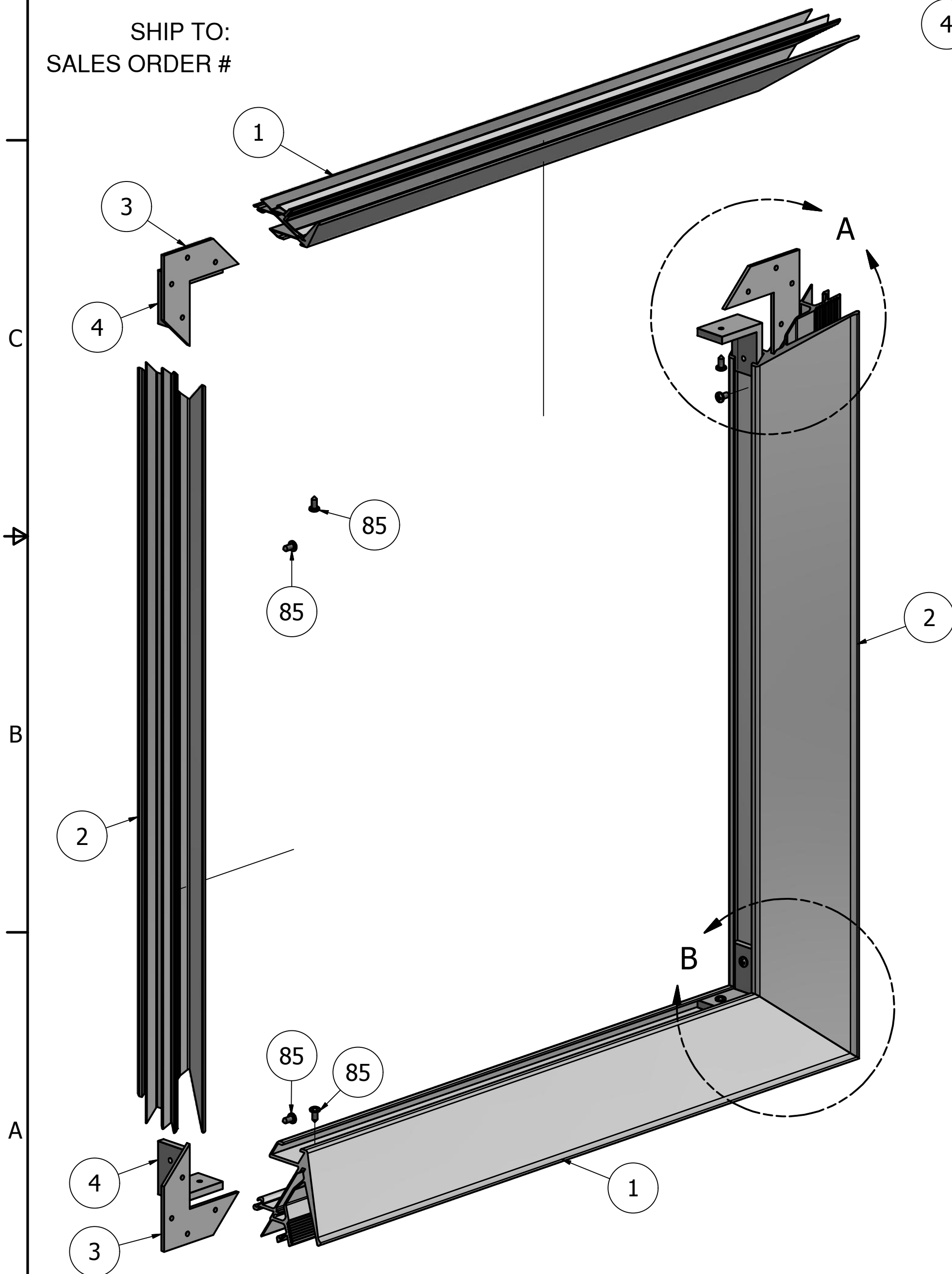

NOTE: THIS FRAME MAY BE BONDED, WELDED OR ASSEMBLED WITH FASTENERS.

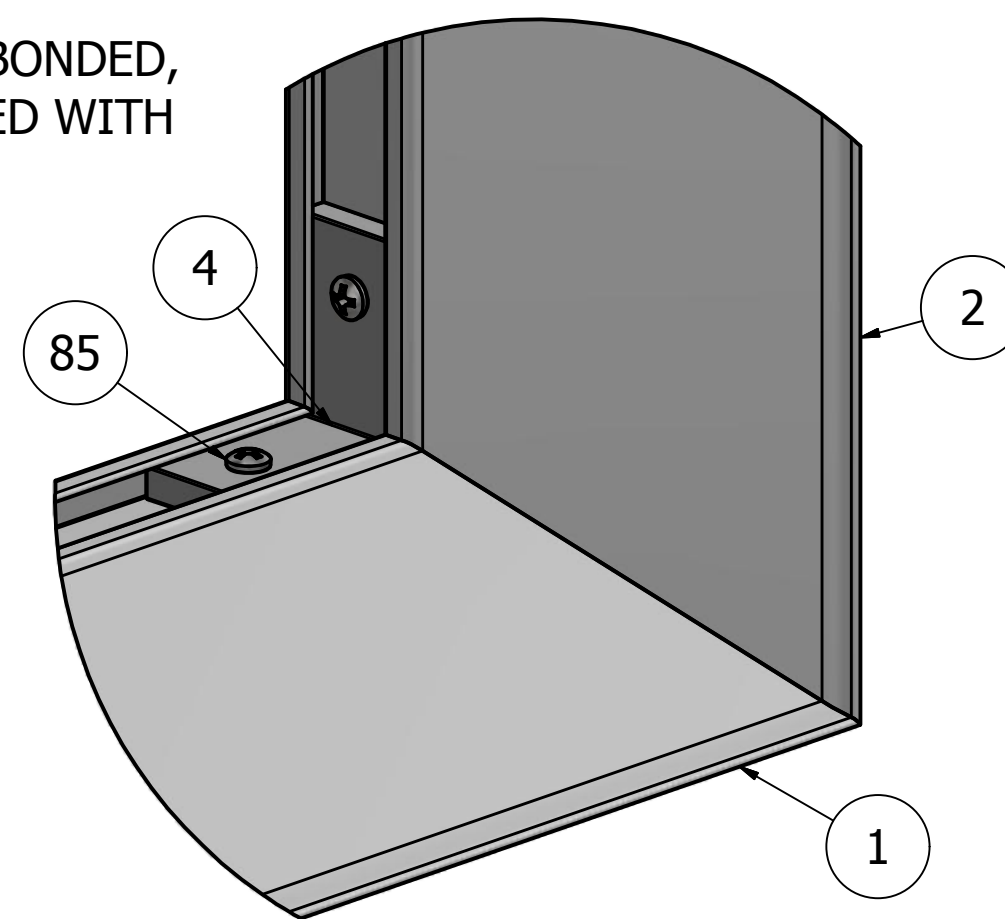

DETAIL B

**NOTE: PRE-CUT KITS ARE NOT PRE-DRILLED.**  
(Holes shown in this drawing are for reference only. Drilling of pilot holes are to be done by fabricator.)

THIS DRAWING WAS CREATED AT NO CHARGE TO ASSIST YOU IN VISUALIZING OUR PROPOSAL. THE DRAWING HEREIN IS THE PROPERTY OF SIGNCOMP. PERMISSION TO COPY OR REVISE THIS DRAWING OR TO USE THIS DRAWING FOR PRODUCTION IS STRICTLY PROHIBITED AND CAN ONLY BE COPIED, REVISED OR USED FOR PRODUCTION WITH THE EXPRESSED WRITTEN PERMISSION OF SIGNCOMP.

DRAWING BY:	SBreihof	4/24/2014	<b>SignComp</b>
Centroid X:	0.000 in	Centroid Y:	
Principal Moments Ix:	0.000 in <sup>4</sup>	Principal Moments Iy:	0.000 in <sup>4</sup>
Section Modulus Ix:	0.000 in <sup>3</sup>	Section Modulus Iy:	0.000 in <sup>3</sup>
TITLE			Tension Frame II - Assembly
PART NO			<b>K2086</b>
REV			
SHEET			1 OF 1

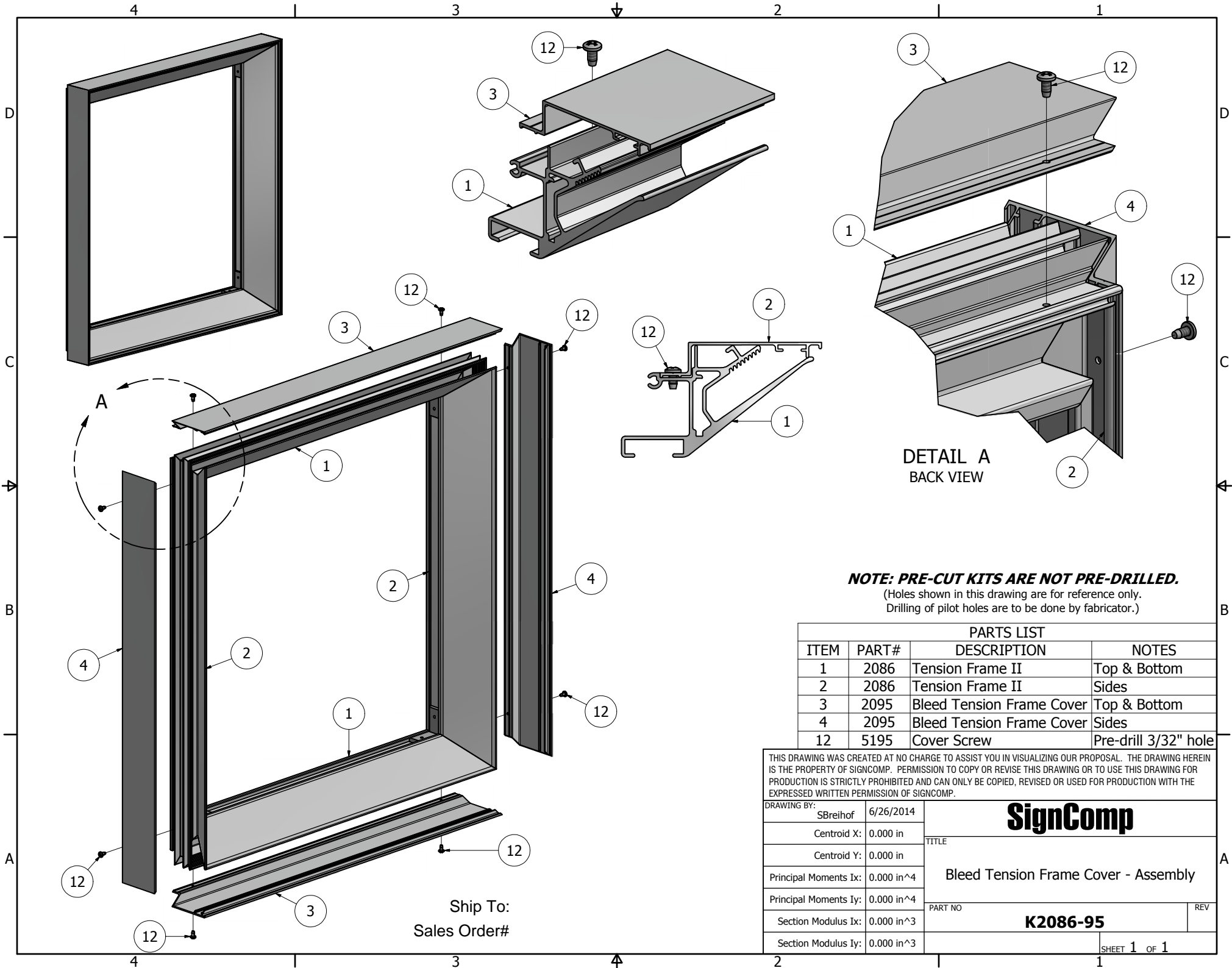

**DETAIL A  
BACK VIEW**

**NOTE: PRE-CUT KITS ARE NOT PRE-DRILLED.**  
 (Holes shown in this drawing are for reference only.  
 Drilling of pilot holes are to be done by fabricator.)

PARTS LIST			
ITEM	PART #	DESCRIPTION	NOTES
1	2086	Tension Frame II	Top & Bottom
2	2086	Tension Frame II	Sides
3	2095	Bleed Tension Frame Cover	Top & Bottom
4	2095	Bleed Tension Frame Cover	Sides
12	5195	Cover Screw	Pre-drill 3/32" hole

THIS DRAWING WAS CREATED AT NO CHARGE TO ASSIST YOU IN VISUALIZING OUR PROPOSAL. THE DRAWING HEREIN IS THE PROPERTY OF SIGNCOMP. PERMISSION TO COPY OR REVISE THIS DRAWING OR TO USE THIS DRAWING FOR PRODUCTION IS STRICTLY PROHIBITED AND CAN ONLY BE COPIED, REVISED OR USED FOR PRODUCTION WITH THE EXPRESSED WRITTEN PERMISSION OF SIGNCOMP.

DRAWING BY:	SBreihof	6/26/2014
Centroid X:	0.000 in	
Centroid Y:	0.000 in	
Principal Moments Ix:	0.000 in^4	
Principal Moments Iy:	0.000 in^4	
Section Modulus Ix:	0.000 in^3	
Section Modulus Iy:	0.000 in^3	

<b>SignComp</b>	
TITLE	
Bleed Tension Frame Cover - Assembly	
PART NO	REV
<b>K2086-95</b>	
SHEET 1 OF 1	

Ship To:  
Sales Order#

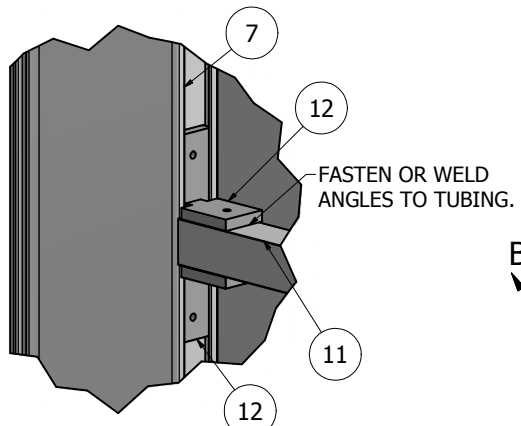
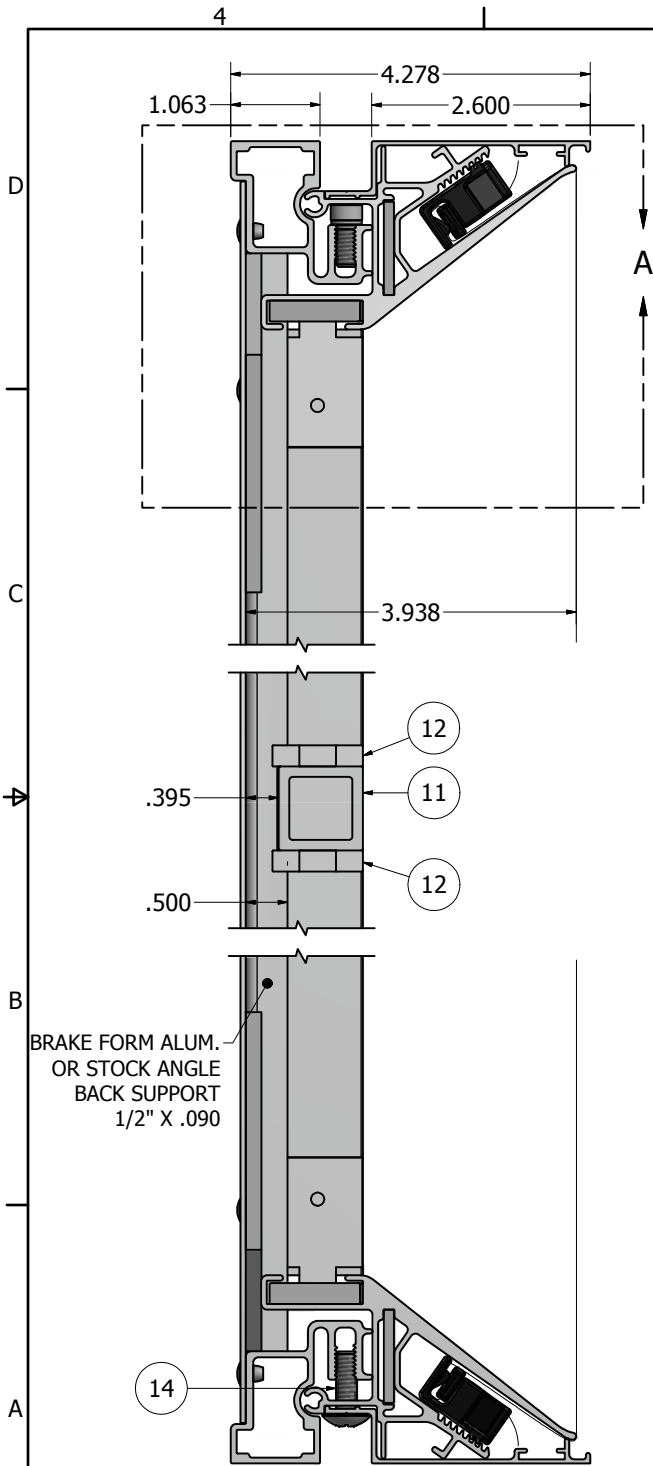

**NOTE: FRAME BRACING GUIDELINES APPLY FOR BOTH THE BLEED AND FRAMED COVERS.**

**NOTE: THE SLIMLINE SINGLE FACE BODY IS DESIGNED FOR LED APPLICATION.**

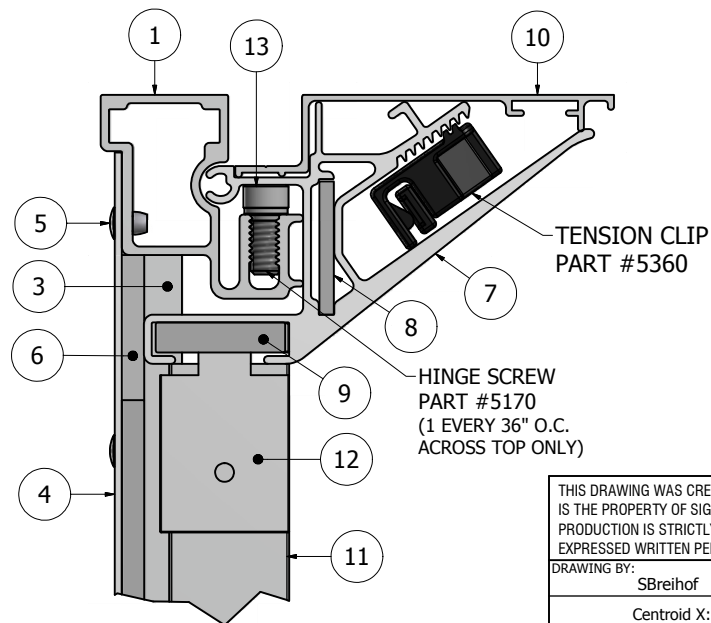

**NOTE: PRE-CUT KITS ARE NOT PRE-DRILLED.**  
(Holes shown in this drawing are for reference only. Drilling of pilot holes are to be done by fabricator.)

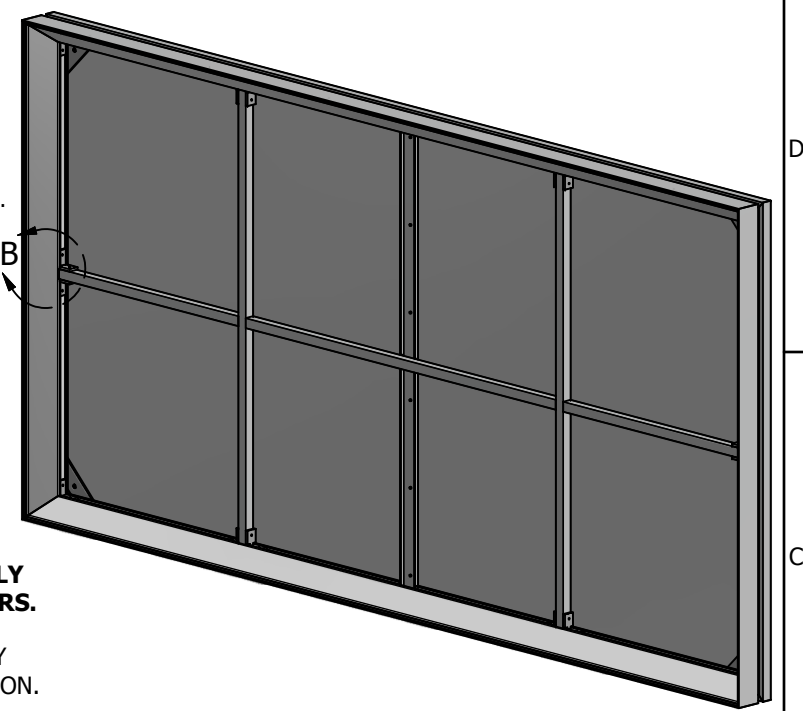

PARTS LIST		
ITEM	PART #	DESCRIPTION
1	2020	Slimline Single Face Body
2	5320	Body Corner Angle
3		Alum. Back Support
4		Alum. Back
5		Rivet
6		Corner Gusset
7	2086	Tension Frame II
8	5210	Corner Key
9	5305	Frame Corner Angle
10	2095	Bleed Tension Frame Cover
11	2177	Small Frame Support Tube - 1" SQ
12	5300	Divider Corner Angle
13	5170	Hinge Screw
14	5180	Closure Screw

THIS DRAWING WAS CREATED AT NO CHARGE TO ASSIST YOU IN VISUALIZING OUR PROPOSAL. THE DRAWING HEREIN IS THE PROPERTY OF SIGNCOMP. PERMISSION TO COPY OR REVISE THIS DRAWING OR TO USE THIS DRAWING FOR PRODUCTION IS STRICTLY PROHIBITED AND CAN ONLY BE COPIED, REVISED OR USED FOR PRODUCTION WITH THE EXPRESSED WRITTEN PERMISSION OF SIGNCOMP.

DRAWING BY:	SBreihof	7/11/2014	<b>SignComp</b>
Centroid X:	0.000 in		
Centroid Y:	0.000 in		TITLE
Principal Moments Ix:	0.000 in <sup>4</sup>		Slimline Single Face Body w/ Tension Frame II and Bleed Cover - Cross Sectional Details
Principal Moments Iy:	0.000 in <sup>4</sup>		
Section Modulus Ix:	0.000 in <sup>3</sup>		PART NO
Section Modulus Iy:	0.000 in <sup>3</sup>		<b>2020-86-95 with Angles</b>
			REV

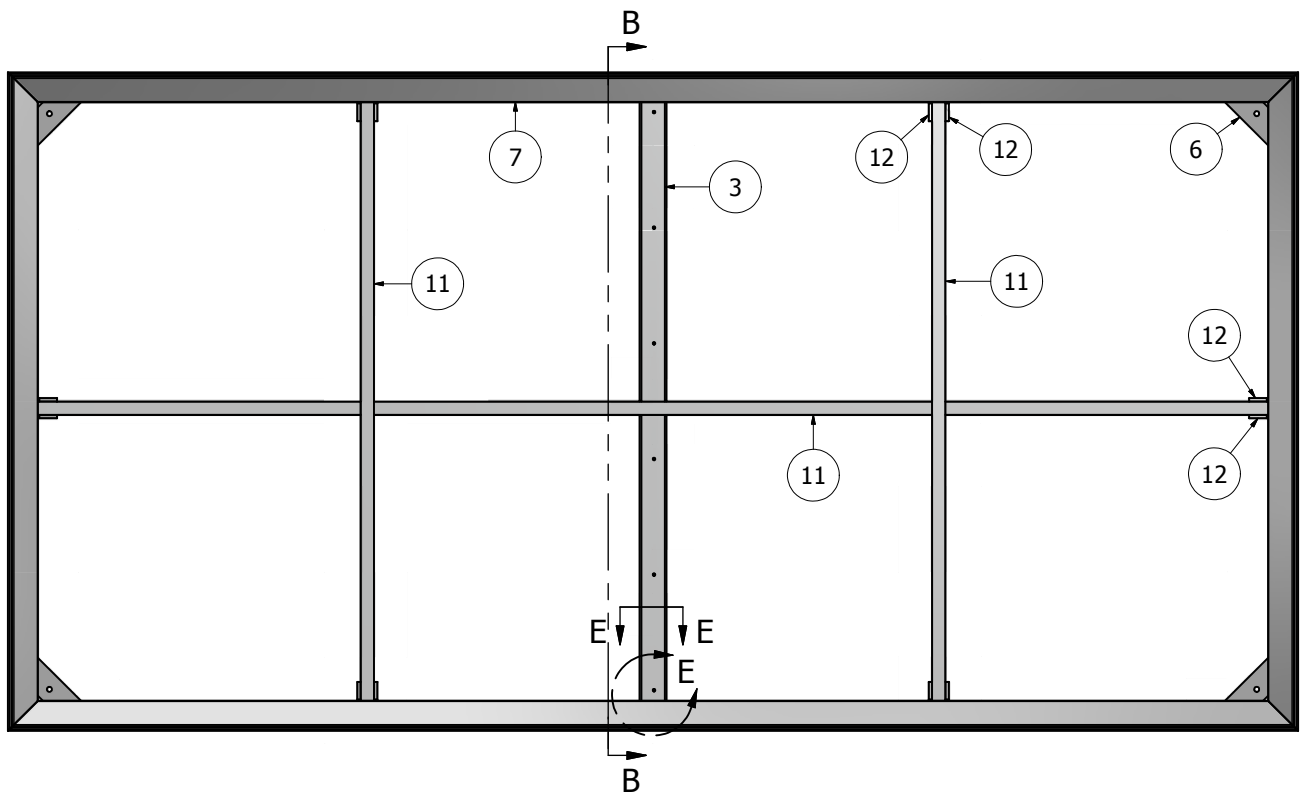

FRONT VIEW

**NOTE:** NOTCHING IS BASED ON A BRAKE FORMED ALUMINUM BACK SUPPORT 2" x 1/2" x .090 AND 1" SQ TUBE FOR COMPRESSION BRACING.

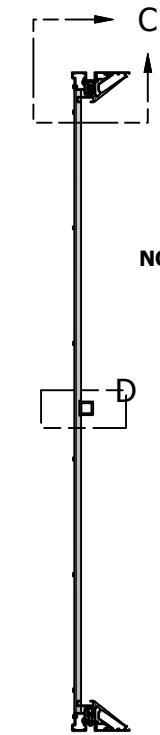

SECTION B-B

**NOTE:** NOTCH THE BACK SUPPORT(S) AS SHOWN, TO ACCOMMODATE THE HORIZONTAL FRAME SUPPORT(S). DIMENSIONS MAY VARY PENDING ON SIZE OF SUPPORTS USED.

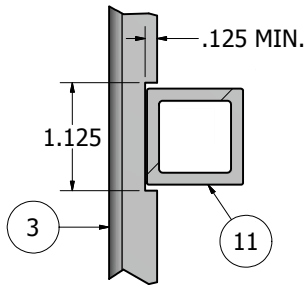

DETAIL D

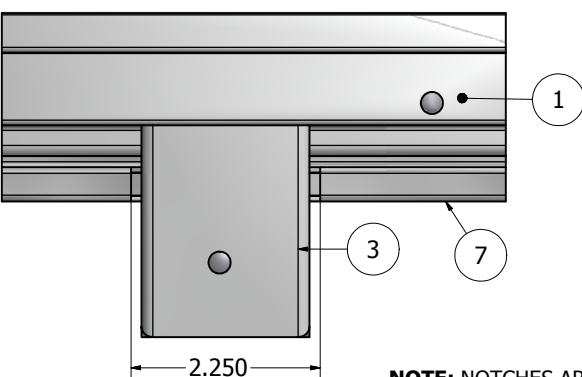

DETAIL C BACK VIEW

**NOTE:** NOTCHES ARE TAKEN OUT OF THE TOP AND BOTTOM HORIZONTALS OF THE FRAME AT THE DIMENSIONS SHOWN, IN ORDER TO ACCOMMODATE THE BACK SUPPORT(S).

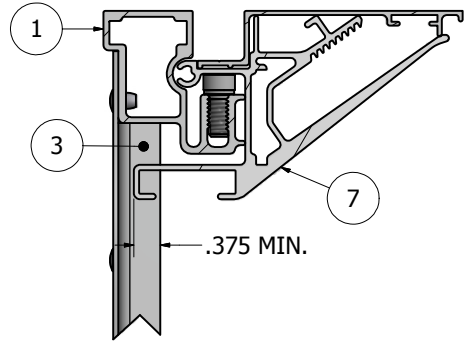

DETAIL C

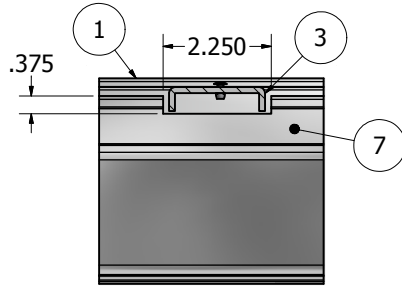

SECTION E-E

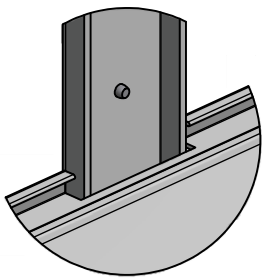

DETAIL E ISOMETRIC

THIS DRAWING WAS CREATED AT NO CHARGE TO ASSIST YOU IN VISUALIZING OUR PROPOSAL. THE DRAWING HEREIN IS THE PROPERTY OF SIGNCOMP. PERMISSION TO COPY OR REVISE THIS DRAWING OR TO USE THIS DRAWING FOR PRODUCTION IS STRICTLY PROHIBITED AND CAN ONLY BE COPIED, REVISED OR USED FOR PRODUCTION WITH THE EXPRESSED WRITTEN PERMISSION OF SIGNCOMP.

DRAWING BY:	SBreihof	7/11/2014
Centroid X:	0.000 in	
Centroid Y:	0.000 in	
Principal Moments Ix:	0.000 in <sup>4</sup>	
Principal Moments Iy:	0.000 in <sup>4</sup>	
Section Modulus Ix:	0.000 in <sup>3</sup>	
Section Modulus Iy:	0.000 in <sup>3</sup>	

		TITLE
		Slimline Single Face Body w/ Tension Frame II and Bleed Cover - Cross Sectional Details
PART NO	<b>2020-86-95 with Angles</b>	REV
SHEET 2 OF 2		