

Ship To:
Sales Order#

PARTS LIST			
ITEM	PART #	DESCRIPTION	NOTES
1	K2010	Flat 2 PC Double Face Medium Body	Assembly
2	K2104-2121	Flat Bleed Retro Frame w/ Bleed Cover	Assembly
79	5175	Hinge Screw - #10 x 5/8" Pan Head	Pre-drill 5/32" pilot holes every 36" o/c
80	5175	Closure Screw - #10 x 5/8" Pan Head	Pre-drill 5/32" pilot holes every 48" o/c

NOTE: THE FRAME ALIGNS TIGHT TO THE BODY, SHOWING NO REVEAL.

NOTE: PRE-CUT KITS ARE NOT PRE-DRILLED.
(Holes shown in this drawing are for reference only. Drilling of pilot holes are to be done by fabricator.)

THIS DRAWING WAS CREATED AT NO CHARGE TO ASSIST YOU IN VISUALIZING OUR PROPOSAL. THE DRAWING HEREIN IS THE PROPERTY OF SIGNCOMP. PERMISSION TO COPY OR REVISE THIS DRAWING OR TO USE THIS DRAWING FOR PRODUCTION IS STRICTLY PROHIBITED AND CAN ONLY BE COPIED, REVISED OR USED FOR PRODUCTION WITH THE EXPRESSED WRITTEN PERMISSION OF SIGNCOMP.

DRAWING BY:	SBreihof	8/21/2013	SignComp
Centroid X:	0.000 in		
Centroid Y:	0.000 in		TITLE
Principal Moments Ix:	0.000 in ⁴		Flat 2 Piece Double Face Medium Body w/ Flat Bleed Retro Frame and Bleed Cover - Assembly
Principal Moments Iy:	0.000 in ⁴		PART NO
Section Modulus Ix:	0.000 in ³		K2010-2104-21
Section Modulus Iy:	0.000 in ³		REV
			SHEET 1 OF 1

PARTS LIST			
ITEM	PART#	DESCRIPTION	NOTES
1	2010	Flat 2PC Double Face Medium Body	Top & Bottom
2	2010	Flat 2PC Double Face Medium Body	Sides
3	5910	Flat 2PC Double Face Medium Body Corner Angle	One (1) per corner
4	5910	Flat 2PC Double Face Medium Body Corner Angle	Notched by Other
13	5218	Corner Angle Screw	Pre-drill 5/32" pilot hole

Ship To:
Sales Order#

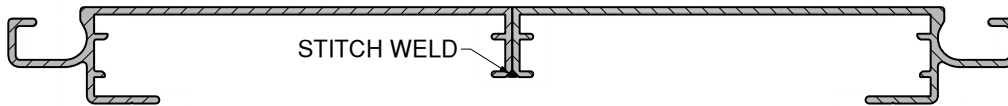
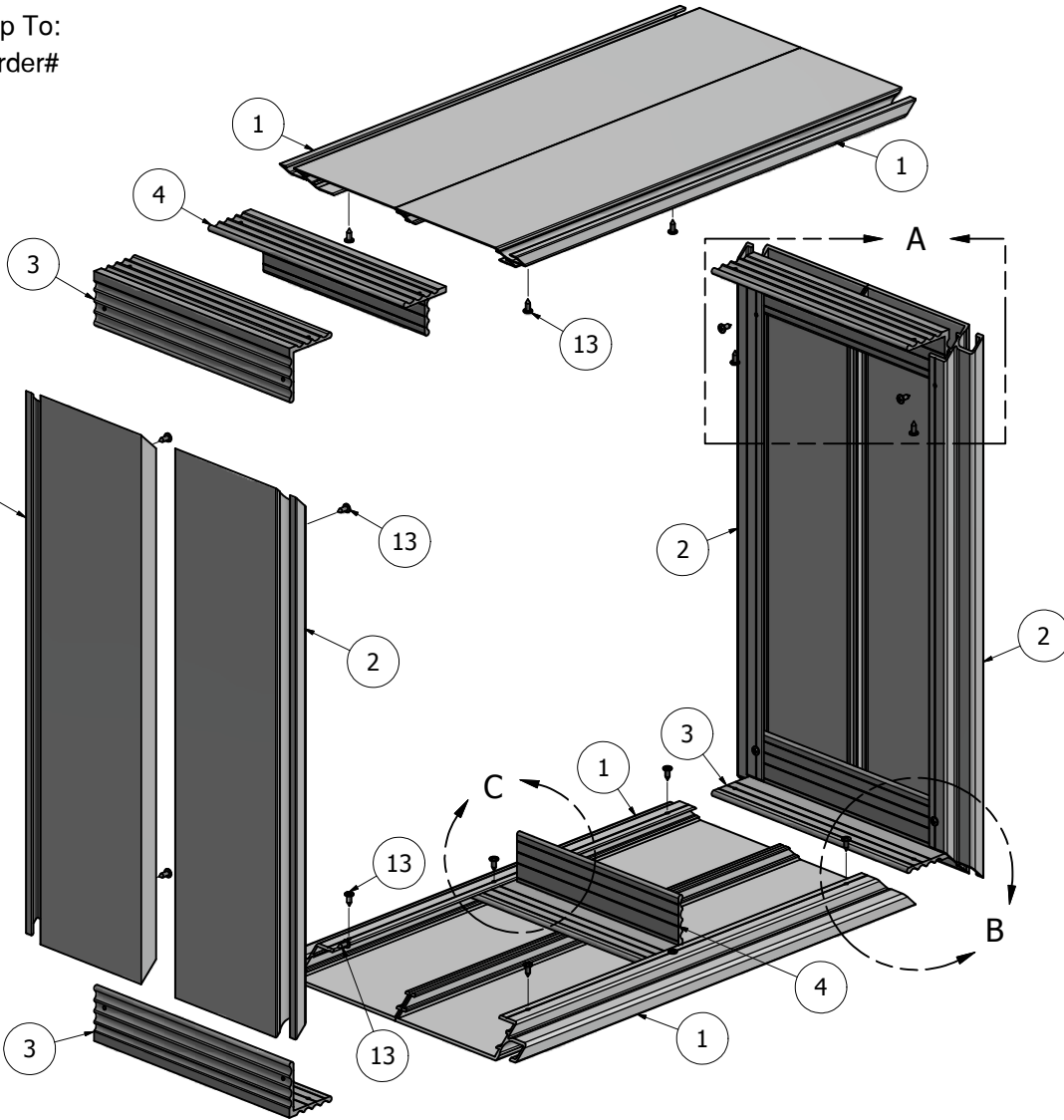

CROSS-SECTION VIEW

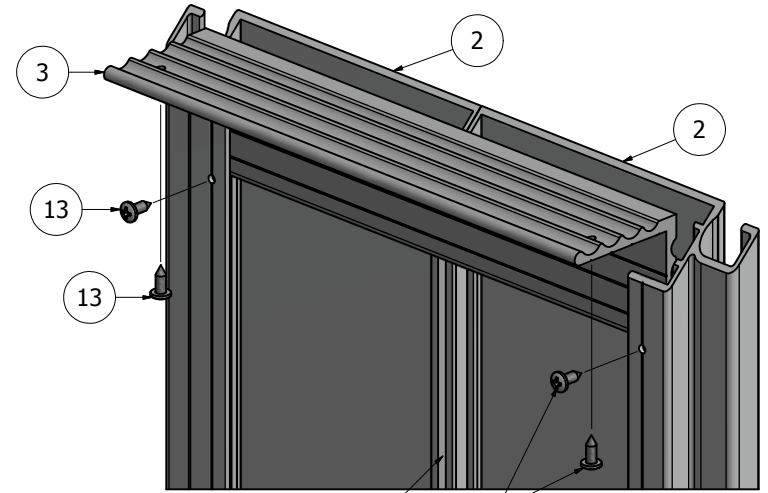

NOTE: Stitch weld the body joint then fill in the gaps between the welds with a bead of silicon.

DETAIL A

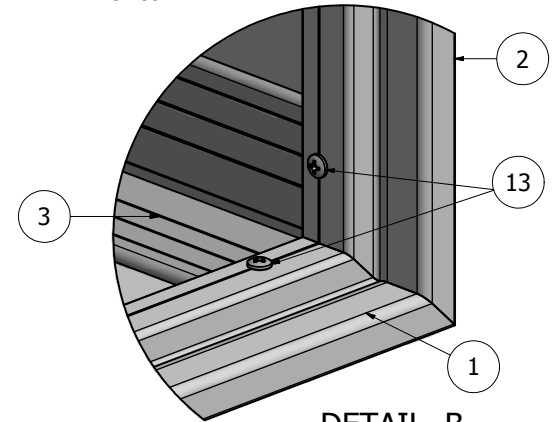

DETAIL B
ASSEMBLED

NOTE: PRE-CUT KITS ARE NOT PRE-DRILLED.
(Holes shown in this drawing are for reference only.
Drilling of pilot holes are to be done by fabricator.)

THIS DRAWING WAS CREATED AT NO CHARGE TO ASSIST YOU IN VISUALIZING OUR PROPOSAL. THE DRAWING HEREIN IS THE PROPERTY OF SIGNCOMP. PERMISSION TO COPY OR REVISE THIS DRAWING OR TO USE THIS DRAWING FOR PRODUCTION IS STRICTLY PROHIBITED AND CAN ONLY BE COPIED, REVISED OR USED FOR PRODUCTION WITH THE EXPRESSED WRITTEN PERMISSION OF SIGNCOMP.

DRAWING BY:	SBreihof	8/14/2013
Centroid X:	0.000 in	
Centroid Y:	0.000 in	
Principal Moments Ix:	0.000 in ⁴	
Principal Moments Iy:	0.000 in ⁴	
Section Modulus Ix:	0.000 in ³	
Section Modulus Iy:	0.000 in ³	

SignComp

Flat 2PC Double Face Medium Body -
Assembly

PART NO **K2010** REV

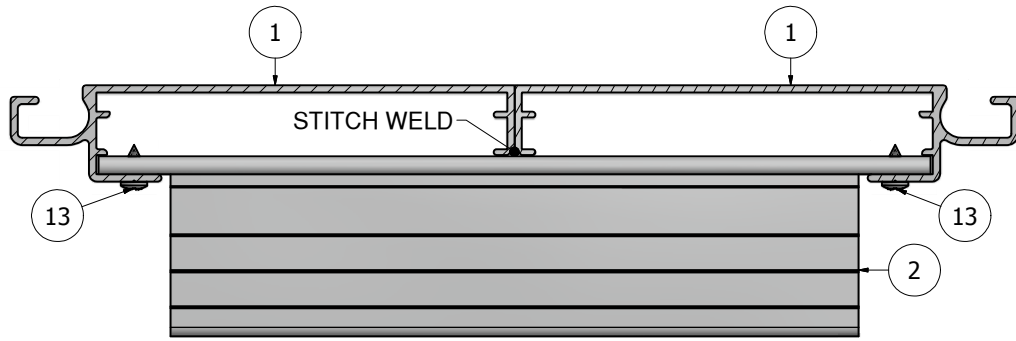

TOP & BOTTOM CROSS-SECTION VIEW
AT BODY BRACE

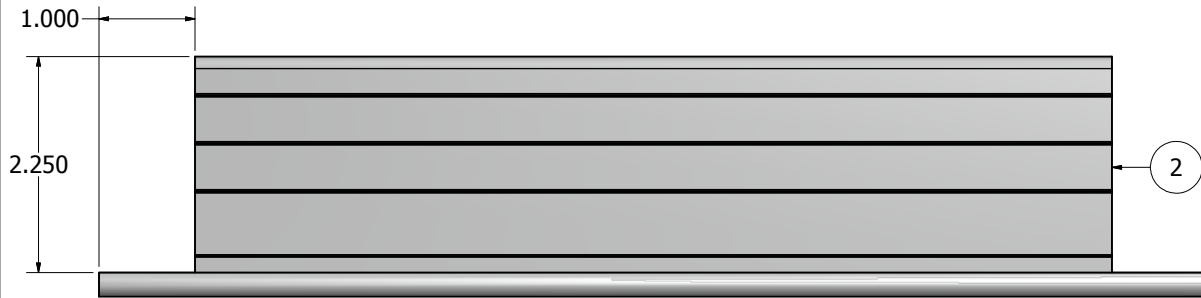

NOTE: NOTCH BOTH ENDS OF THE ANGLE ABOVE TO BYPASS THE INNER BODY FLANGES. THIS SERVES AS A BRACE TO PROVIDE ADDITIONAL SUPPORT TO THE JOINED BODY SECTIONS.

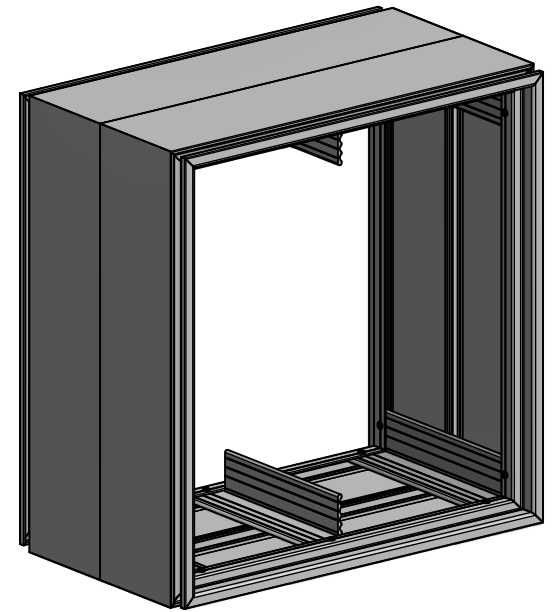
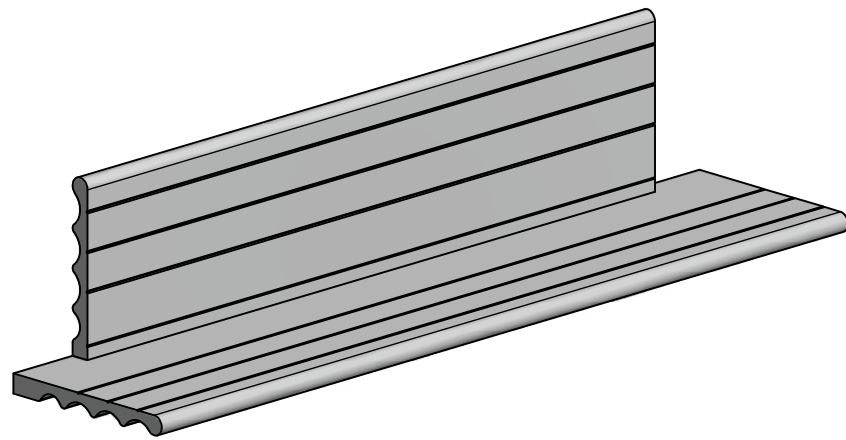

NOTE: BRACES SHOULD BE SPACED A MIN. OF 48" ON CENTER.

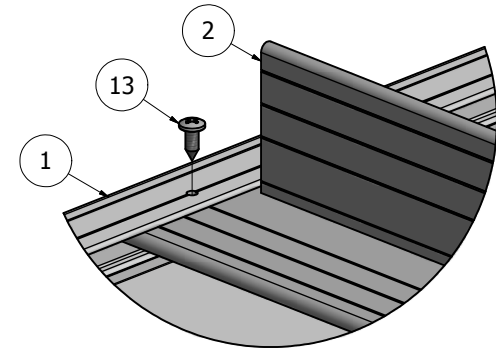

DETAIL C

THIS DRAWING WAS CREATED AT NO CHARGE TO ASSIST YOU IN VISUALIZING OUR PROPOSAL. THE DRAWING HEREIN IS THE PROPERTY OF SIGNCOMP. PERMISSION TO COPY OR REVISE THIS DRAWING OR TO USE THIS DRAWING FOR PRODUCTION IS STRICTLY PROHIBITED AND CAN ONLY BE COPIED, REVISED OR USED FOR PRODUCTION WITH THE EXPRESSED WRITTEN PERMISSION OF SIGNCOMP.

DRAWING BY:	SBreihof	8/14/2013
Centroid X:	0.000 in	
Centroid Y:	0.000 in	
Principal Moments Ix:	0.000 in ⁴	
Principal Moments Iy:	0.000 in ⁴	
Section Modulus Ix:	0.000 in ³	
Section Modulus Iy:	0.000 in ³	

SignComp

Flat 2PC Double Face Medium Body -
Assembly

PART NO	K2010	REV
---------	--------------	-----

PARTS LIST			NOTES
ITEM	PART #	DESCRIPTION	
1	2010	Flat 2PC Double Face Medium Body	All Sides
2	5910	Flat 2PC Double Face Medium Body Corner Angle	Notched by Other
13	5218	Corner Angle Screw	Pre-drill 5/32" pilot hole

PARTS LIST			
ITEM	PART#	DESCRIPTION	NOTES
1	2104	Flat Bleed Retro Frame	Top & Bottom
2	2104	Flat Bleed Retro Frame	Sides
3	5305	Frame Corner Angle	
13	5218	Corner Angle Screw	

Ship To:
Sales Order #

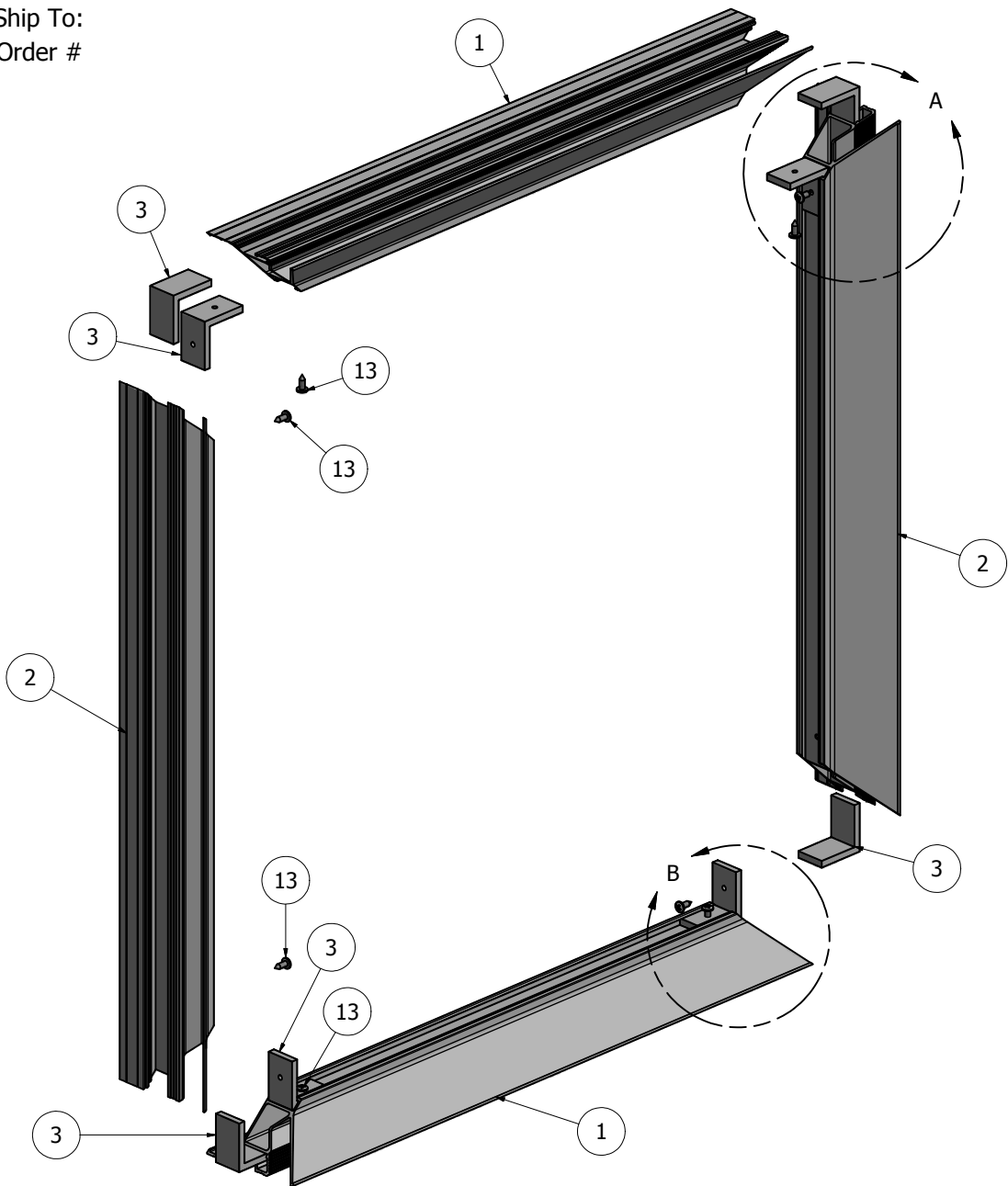

OUTER FRAME CORNER
ANGLE FLOATS IN THE
FRAME FOR ALIGNMENT

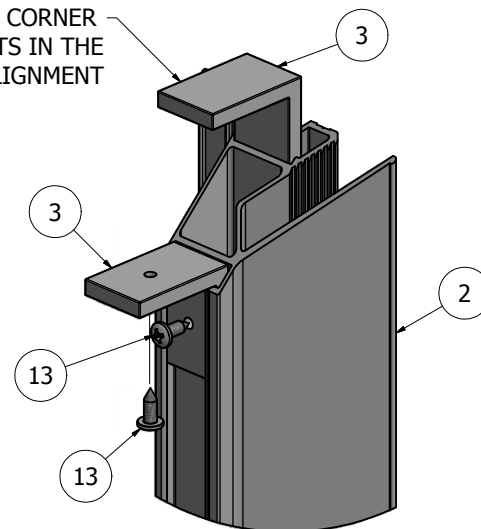

DETAIL A

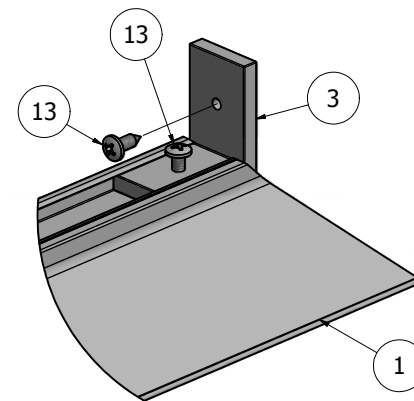

DETAIL B

NOTE: PRE-CUT KITS ARE NOT PRE-DRILLED.

(Holes shown in this drawing are for reference only.
Drilling of pilot holes are to be done by fabricator.)

THIS DRAWING WAS CREATED AT NO CHARGE TO ASSIST YOU IN VISUALIZING OUR PROPOSAL. THE DRAWING HEREIN IS THE PROPERTY OF SIGNCOMP. PERMISSION TO COPY OR REVISE THIS DRAWING OR TO USE THIS DRAWING FOR PRODUCTION IS STRICTLY PROHIBITED AND CAN ONLY BE COPIED, REVISED OR USED FOR PRODUCTION WITH THE EXPRESSED WRITTEN PERMISSION OF SIGNCOMP.

DRAWN	SBreihof	5/8/2012	SignComp
Centroid X:	0.000 in		
Centroid Y:	0.000 in		TITLE
Principal Moments Ix:	0.000 in ⁴		Flat Bleed Retro Frame - Assembly
Principal Moments Iy:	0.000 in ⁴		DWG NO
Section Modulus Ix:	0.000 in ³		K2104
Section Modulus Iy:	0.000 in ³		REV

PARTS LIST			
ITEM	PART#	DESCRIPTION	NOTES
1	K2104	Flat Bleed Retro Frame	Assembly
2	2121	Flat Bleed Retro Frame Cover	Top & Bottom
3	2121	Flat Bleed Retro Frame Cover	Sides
12	5195	Cover Screw	Pre-drill 3/32" pilot hole

Ship To:
Sales Order#

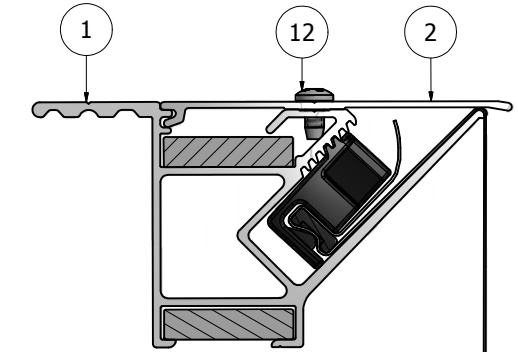
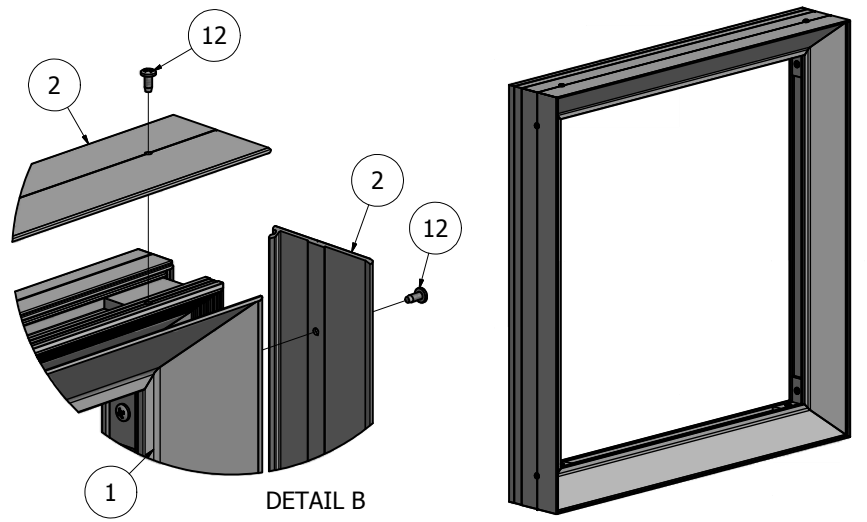
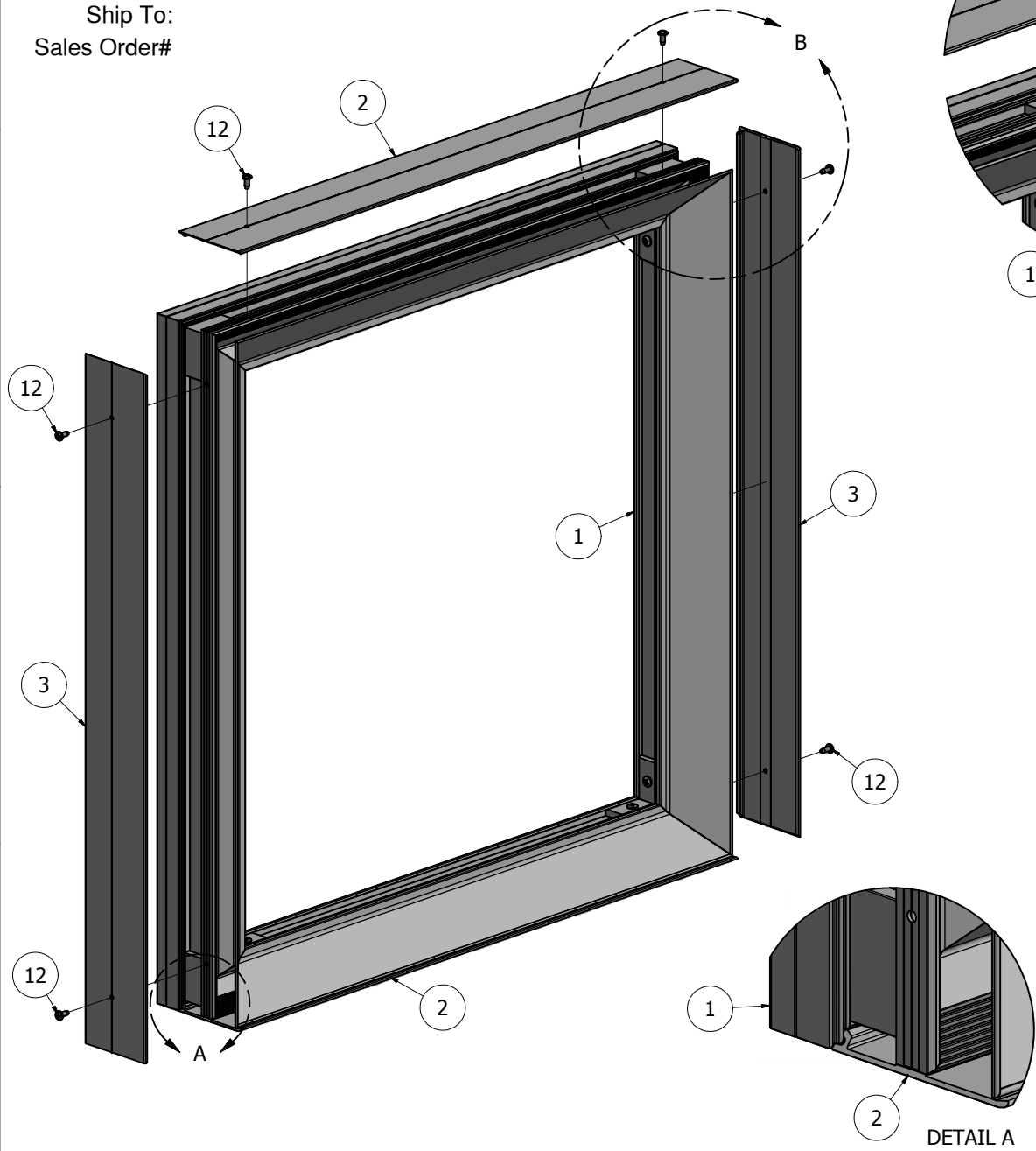

CROSS-SECTION VIEW

NOTE: PRE-CUT KITS ARE NOT PRE-DRILLED.
(Holes shown in this drawing are for reference only.
Drilling of pilot holes are to be done by fabricator.)

THIS DRAWING WAS CREATED AT NO CHARGE TO ASSIST YOU IN VISUALIZING OUR PROPOSAL. THE DRAWING HEREIN IS THE PROPERTY OF SIGNCOMP. PERMISSION TO COPY OR REVISE THIS DRAWING OR TO USE THIS DRAWING FOR PRODUCTION IS STRICTLY PROHIBITED AND CAN ONLY BE COPIED, REVISED OR USED FOR PRODUCTION WITH THE EXPRESSED WRITTEN PERMISSION OF SIGNCOMP.		
DRAWN	SBreihof	5/8/2012
Centroid X:	0.000 in	
Centroid Y:	0.000 in	
Principal Moments Ix:	0.000 in ⁴	
Principal Moments Iy:	0.000 in ⁴	
Section Modulus Ix:	0.000 in ³	
Section Modulus Iy:	0.000 in ³	
TITLE		REV
Flat Bleed Retro Frame w/ Flat Bleed Retro Frame Cover - Assembly		
DWG NO		K2104-21
SHEET 1 OF 1		

SignComp

Flat Bleed Retro Frame w/ Flat Bleed Retro Frame Cover - Assembly

K2104-21

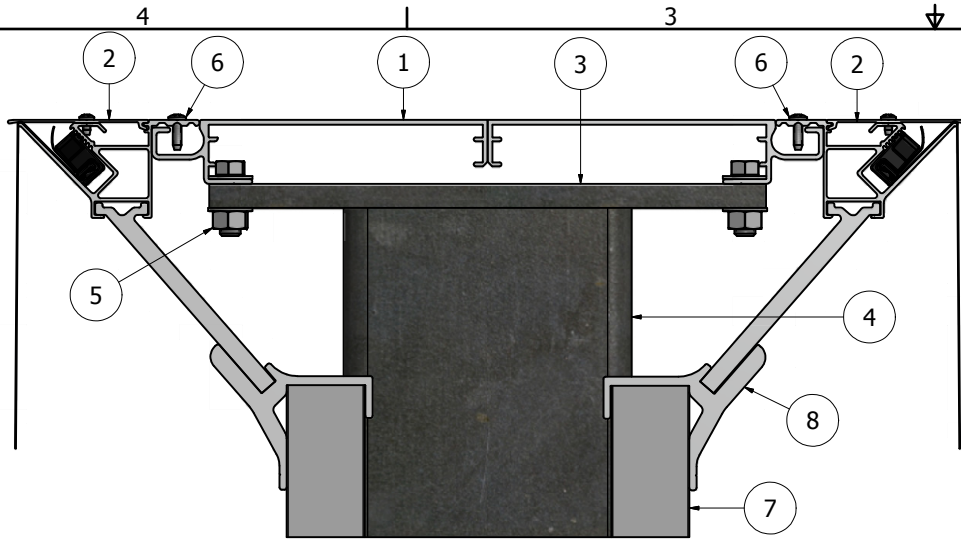

ASSEMBLED TOP CROSS-SECTION

NOTE: THE 2 PC FRAME BRACE ALLOWS FOR THE DEPTH OF THE SUPPORT TO BE ADJUSTED BY CUTTING DOWN THE ARM.

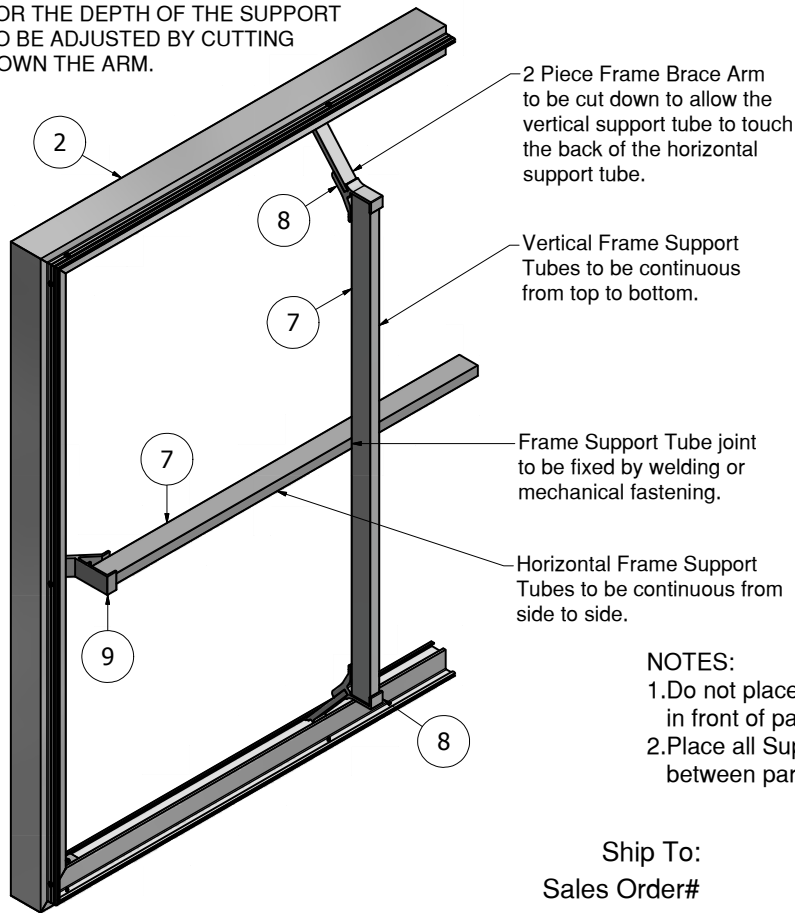

2 Piece Frame Brace Arm to be cut down to allow the vertical support tube to touch the back of the horizontal support tube.

Vertical Frame Support Tubes to be continuous from top to bottom.

Frame Support Tube joint to be fixed by welding or mechanical fastening.

Horizontal Frame Support Tubes to be continuous from side to side.

NOTES:

1. Do not place Support Assemblies directly in front of parallel steel support structures.
2. Place all Support Assemblies directly in between parallel lamps.

Ship To:
Sales Order#

PARTS LIST			
ITEM	PART #	DESCRIPTION	NOTES
1	K2010	Flat 2 PC Double Face Medium Body	Assembly
2	K2104-2121	Flat Bleed Retro Frame w/ Bleed Cover	Assembly
3		Mounting Plate	By Other
4		Main Support Tube	By Other
5		Mounting Plate Bolt Assembly	By Other
6	5175	Hinge/Closure Screw	
7	2175	Frame Support Tube	3/4" x 1-5/8" Tube
8	5357	2 Piece Frame Brace	#2167Arm & #2168 Yolk
9	5350	Frame Brace	

Compression Bracing for Flexible Vinyl Faces

Place a vertical 2 PC Frame Brace and Frame Support Tube approximately every 36" on center. Cut and insert horizontal pieces of Frame Support Tube attached to Braces, approximately every 36" in between the vertical assemblies.

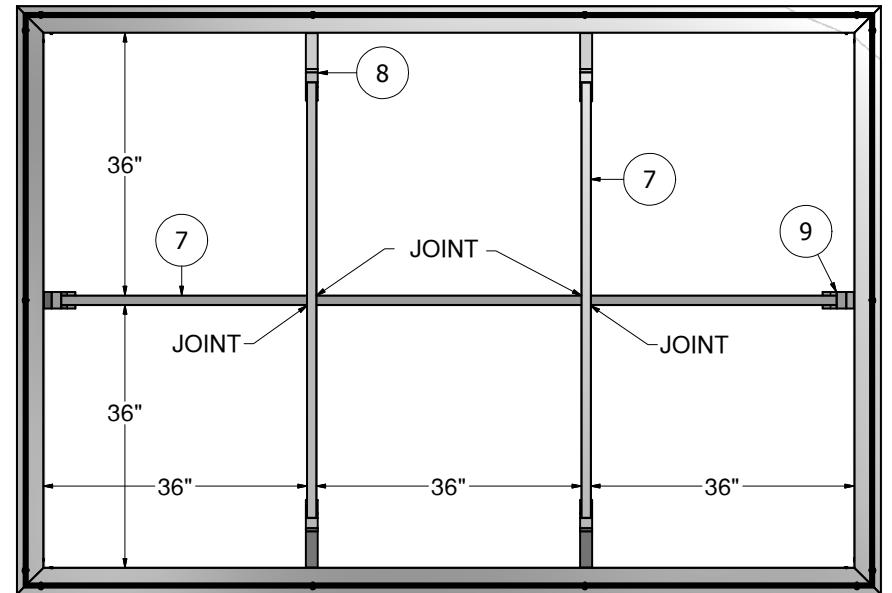

THIS DRAWING WAS CREATED AT NO CHARGE TO ASSIST YOU IN VISUALIZING OUR PROPOSAL. THE DRAWING HEREIN IS THE PROPERTY OF SIGNCOMP. PERMISSION TO COPY OR REVISE THIS DRAWING OR TO USE THIS DRAWING FOR PRODUCTION IS STRICTLY PROHIBITED AND CAN ONLY BE COPIED, REVISED OR USED FOR PRODUCTION WITH THE EXPRESSED WRITTEN PERMISSION OF SIGNCOMP.

DRAWING BY:	SBreihof	8/20/2013
Centroid X:	0.000 in	
Centroid Y:	0.000 in	
Principal Moments Ix:	0.000 in ⁴	
Principal Moments Iy:	0.000 in ⁴	
Section Modulus Ix:	0.000 in ³	
Section Modulus Iy:	0.000 in ³	

		TITLE
		Frame Support Placement
PART NO	5357 & 5350 Frame Brace	REV
		SHEET 1 OF 1