

**NOTE:** THE FRAME ALIGNS TIGHT TO THE BODY, SHOWING NO REVEAL.

DETAIL A  
FRAME CLOSED

PARTS LIST			
ITEM	PART #	DESCRIPTION	NOTES
1	K2008	Flat Double Face Body	Assembly
2	K2104-2121	Flat Bleed Retro Frame w/ Bleed Cover	Assembly
79	5175	Hinge Screw - #10 x 5/8" Pan Head	Pre-drill 5/32" pilot holes every 36" o/c
80	5175	Closure Screw - #10 x 5/8" Pan Head	Pre-drill 5/32" pilot holes every 48" o/c

THIS DRAWING WAS CREATED AT NO CHARGE TO ASSIST YOU IN VISUALIZING OUR PROPOSAL. THE DRAWING HEREIN IS THE PROPERTY OF SIGNCOMP. PERMISSION TO COPY OR REVISE THIS DRAWING OR TO USE THIS DRAWING FOR PRODUCTION IS STRICTLY PROHIBITED AND CAN ONLY BE COPIED, REVISED OR USED FOR PRODUCTION WITH THE EXPRESSED WRITTEN PERMISSION OF SIGNCOMP.

DRAWING BY:	SBreihof	8/16/2013
Centroid X:	0.000 in	
Centroid Y:	0.000 in	
Principal Moments Ix:	0.000 in <sup>4</sup>	
Principal Moments Iy:	0.000 in <sup>4</sup>	
Section Modulus Ix:	0.000 in <sup>3</sup>	
Section Modulus Iy:	0.000 in <sup>3</sup>	

**SignComp**

TITLE  
Flat Double Face Body w/ Flat Bleed Retro Frame and Bleed Cover - Assembly

PART NO  
**K2008-2104-21**

Ship To:  
Sales Order#

**NOTE: PRE-CUT KITS ARE NOT PRE-DRILLED.**  
(Holes shown in this drawing are for reference only. Drilling of pilot holes are to be done by fabricator.)

PARTS LIST			
ITEM	PART #	DESCRIPTION	NOTES
1	2008	Flat Double Face Body	Top & Bottom
2	2008	Flat Double Face Body	Sides
3	5908	Flat Double Face Body Corner Angle	One (1) per corner
13	5218	Corner Angle Screw	Pre-drill 5/32" pilot hole

Ship To:  
Sales Order#

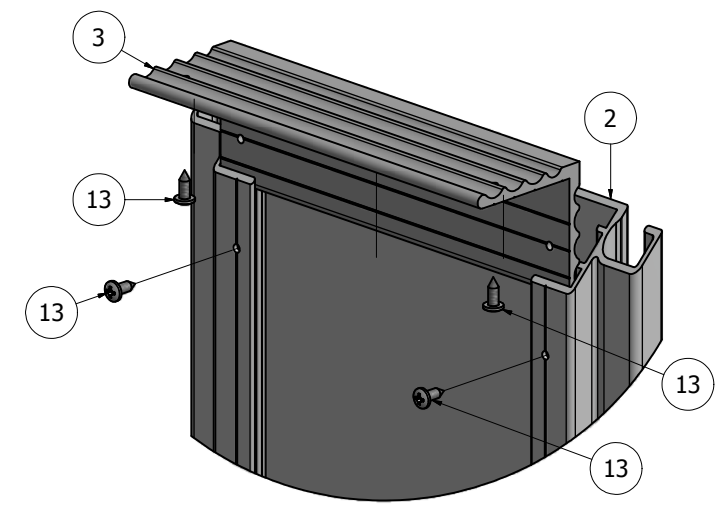
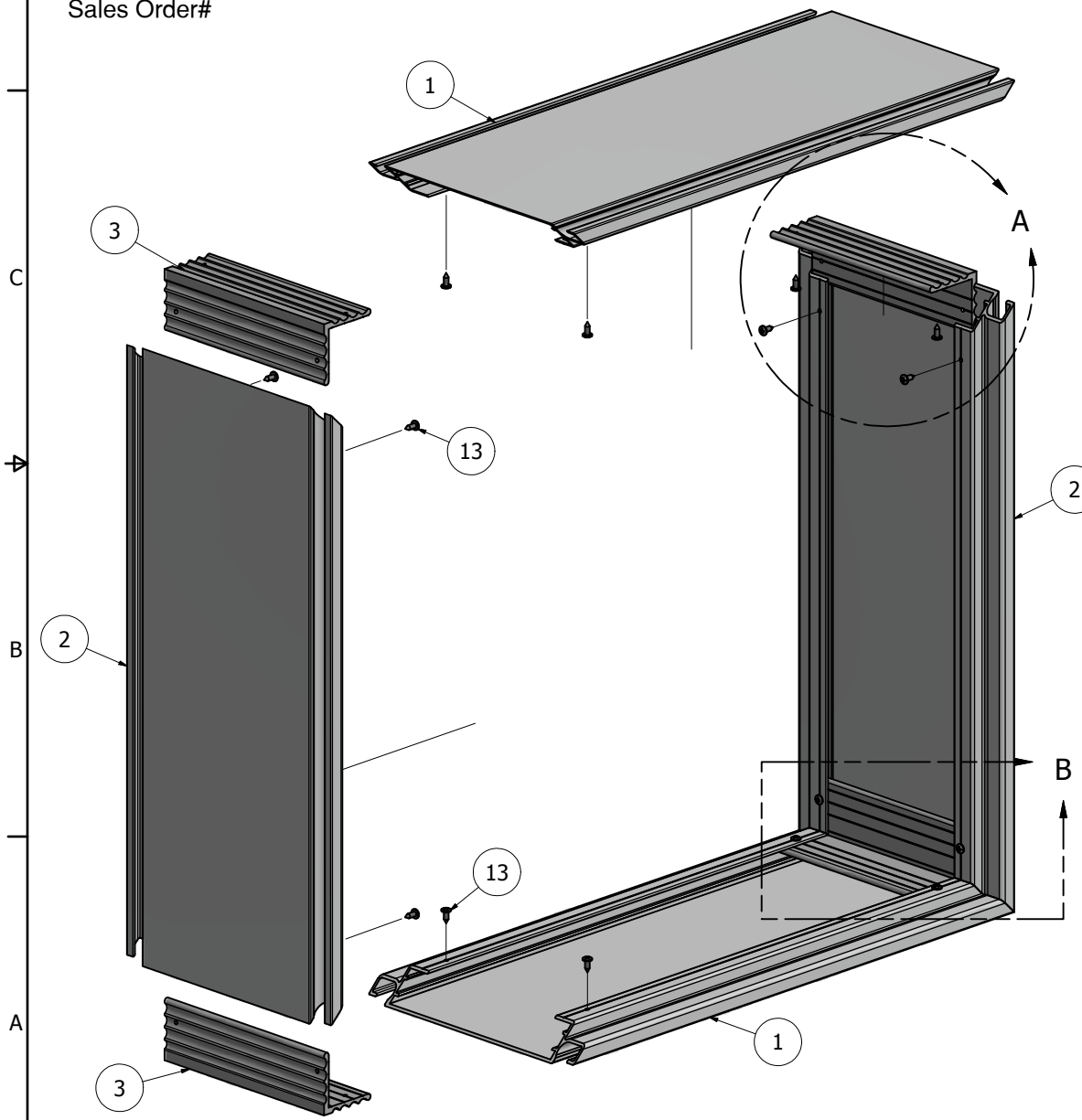

DETAIL A

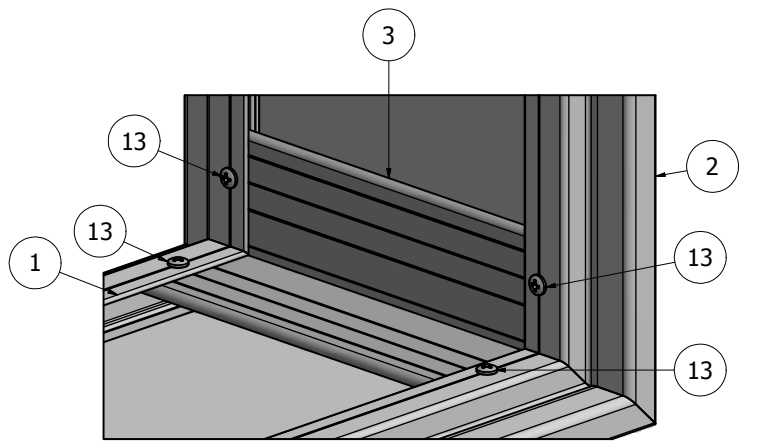

DETAIL B

**NOTE: PRE-CUT KITS ARE NOT PRE-DRILLED.**  
(Holes shown in this drawing are for reference only.  
Drilling of pilot holes are to be done by fabricator.)

DRAWING BY: SBreihof 8/14/2013		<b>SignComp</b>	
Centroid X: 0.000 in	Centroid Y: 0.000 in		
Principal Moments Ix: 0.000 in <sup>4</sup>	Principal Moments Iy: 0.000 in <sup>4</sup>	Flat Double Face Body - Assembly	
Section Modulus Ix: 0.000 in <sup>3</sup>	Section Modulus Iy: 0.000 in <sup>3</sup>		
PART NO		<b>K2008</b>	REV
		SHEET 1 OF 1	

PARTS LIST			
ITEM	PART#	DESCRIPTION	NOTES
1	2104	Flat Bleed Retro Frame	Top & Bottom
2	2104	Flat Bleed Retro Frame	Sides
3	5305	Frame Corner Angle	
13	5218	Corner Angle Screw	

Ship To:  
Order Number:

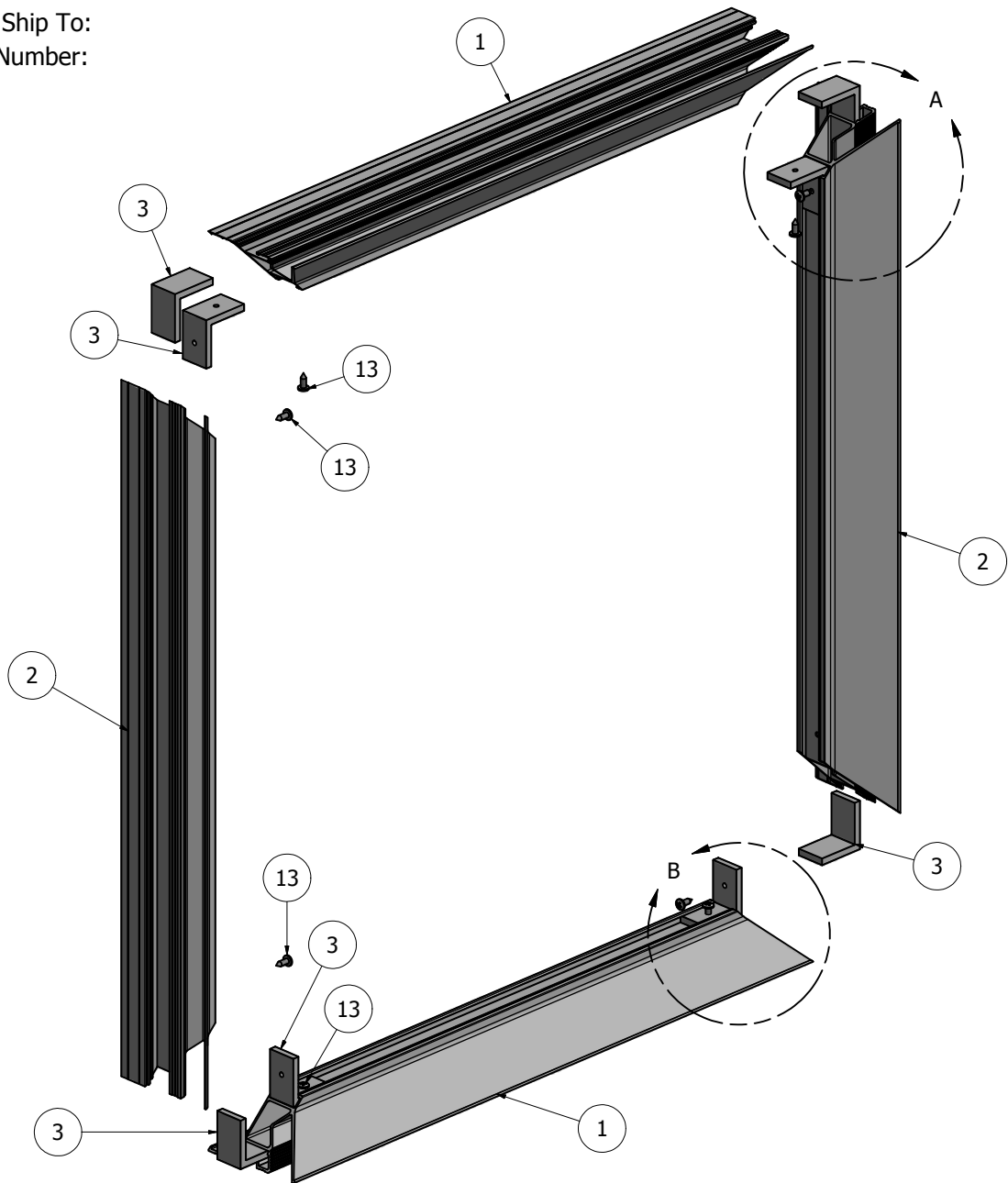

OUTER FRAME CORNER  
ANGLE FLOATS IN THE  
FRAME FOR ALIGNMENT

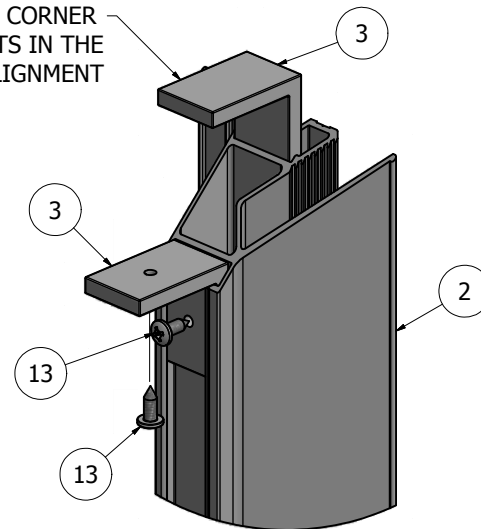

DETAIL A

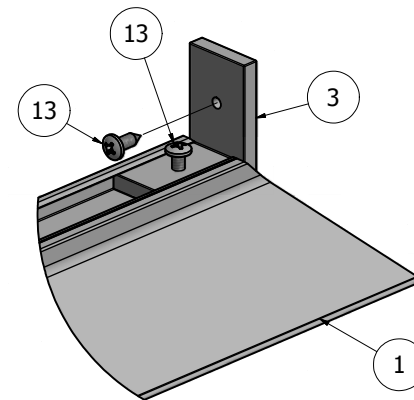

DETAIL B

**NOTE: PRE-CUT KITS ARE NOT PRE-DRILLED.**

(Holes shown in this drawing are for reference only.  
Drilling of pilot holes are to be done by fabricator.)

THIS DRAWING WAS CREATED AT NO CHARGE TO ASSIST YOU IN VISUALIZING OUR PROPOSAL. THE DRAWING HEREIN IS THE PROPERTY OF SIGNCOMP. PERMISSION TO COPY OR REVISE THIS DRAWING OR TO USE THIS DRAWING FOR PRODUCTION IS STRICTLY PROHIBITED AND CAN ONLY BE COPIED, REVISED OR USED FOR PRODUCTION WITH THE EXPRESSED WRITTEN PERMISSION OF SIGNCOMP.

DRAWN	SBreihof	5/8/2012
Centroid X:	0.000 in	
Centroid Y:	0.000 in	
Principal Moments Ix:	0.000 in <sup>4</sup>	
Principal Moments Iy:	0.000 in <sup>4</sup>	
Section Modulus Ix:	0.000 in <sup>3</sup>	
Section Modulus Iy:	0.000 in <sup>3</sup>	

# SignComp

Flat Bleed Retro Frame - Assembly

DWG NO

**K2104**

REV

PARTS LIST			
ITEM	PART#	DESCRIPTION	NOTES
1	K2104	Flat Bleed Retro Frame	Assembly
2	2121	Flat Bleed Retro Frame Cover	Top & Bottom
3	2121	Flat Bleed Retro Frame Cover	Sides
12	5195	Cover Screw	Pre-drill 3/32" pilot hole

Ship To:  
Sales Order#

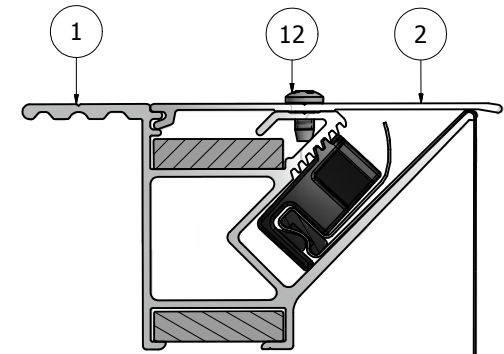
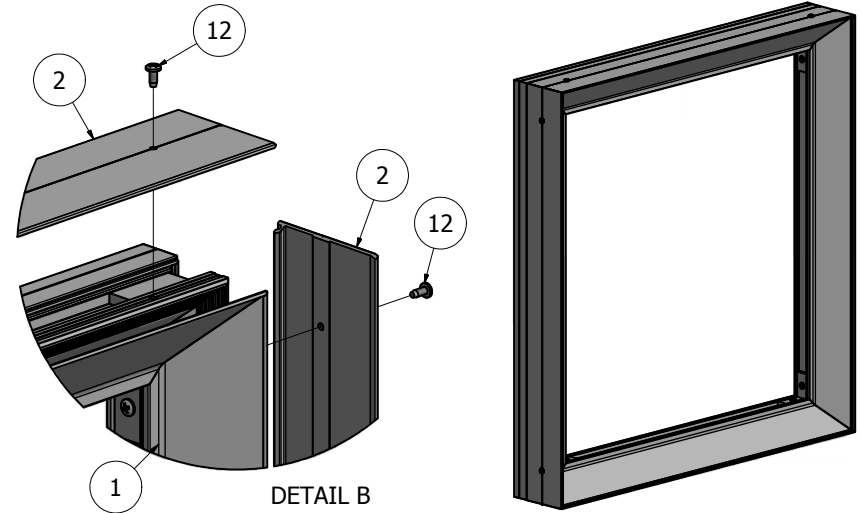
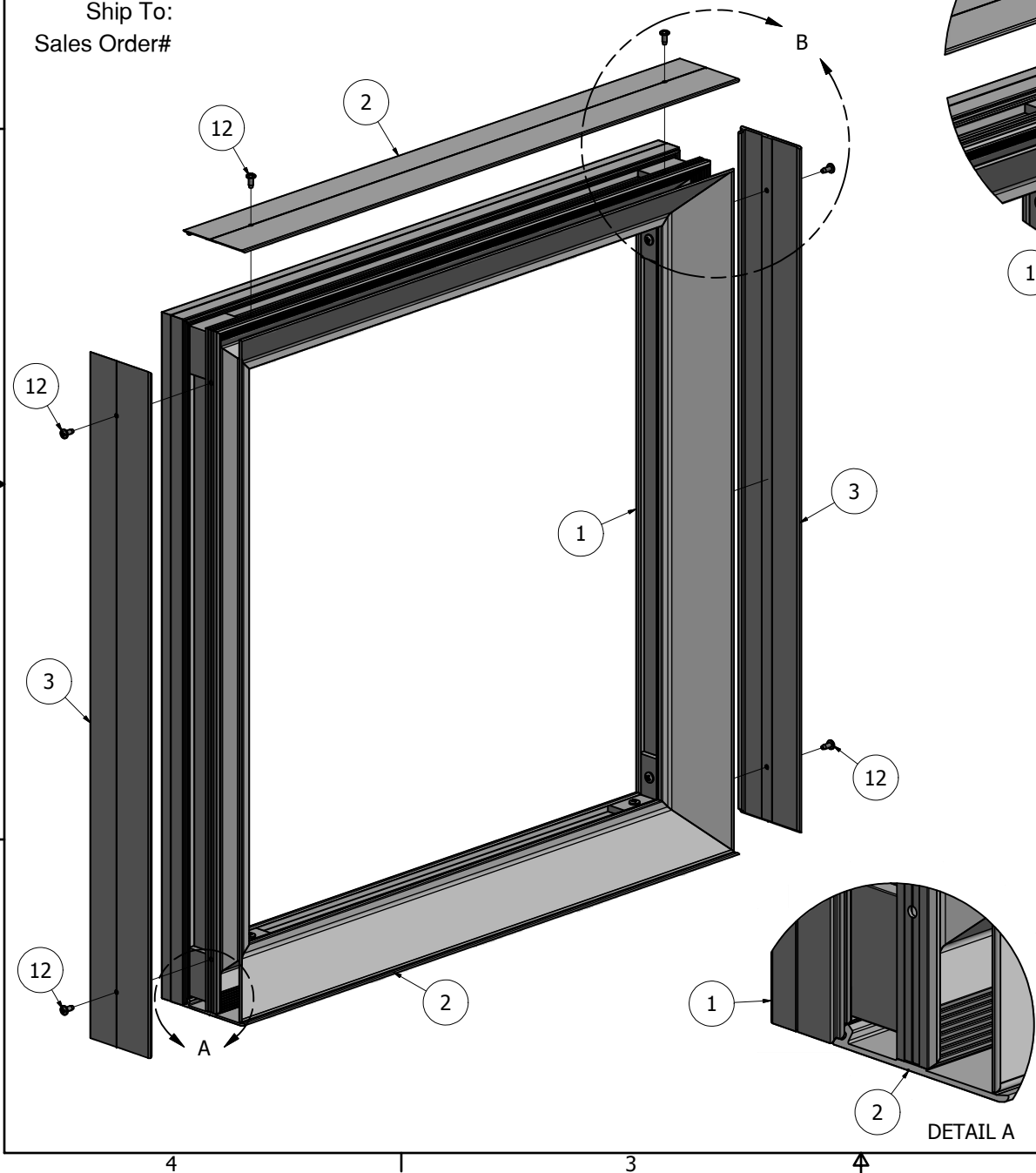

CROSS-SECTION VIEW

**NOTE: PRE-CUT KITS ARE NOT PRE-DRILLED.**  
(Holes shown in this drawing are for reference only.  
Drilling of pilot holes are to be done by fabricator.)

THIS DRAWING WAS CREATED AT NO CHARGE TO ASSIST YOU IN VISUALIZING OUR PROPOSAL. THE DRAWING HEREIN IS THE PROPERTY OF SIGNCOMP. PERMISSION TO COPY OR REVISE THIS DRAWING OR TO USE THIS DRAWING FOR PRODUCTION IS STRICTLY PROHIBITED AND CAN ONLY BE COPIED, REVISED OR USED FOR PRODUCTION WITH THE EXPRESSED WRITTEN PERMISSION OF SIGNCOMP.

DRAWN	SBreihof	5/8/2012	<b>SignComp</b>
Centroid X:	0.000 in		
Centroid Y:	0.000 in		TITLE
Principal Moments Ix:	0.000 in <sup>4</sup>		Flat Bleed Retro Frame w/ Flat Bleed Retro Frame Cover - Assembly
Principal Moments Iy:	0.000 in <sup>4</sup>		DWG NO
Section Modulus Ix:	0.000 in <sup>3</sup>		<b>K2104-21</b>
Section Modulus Iy:	0.000 in <sup>3</sup>		REV

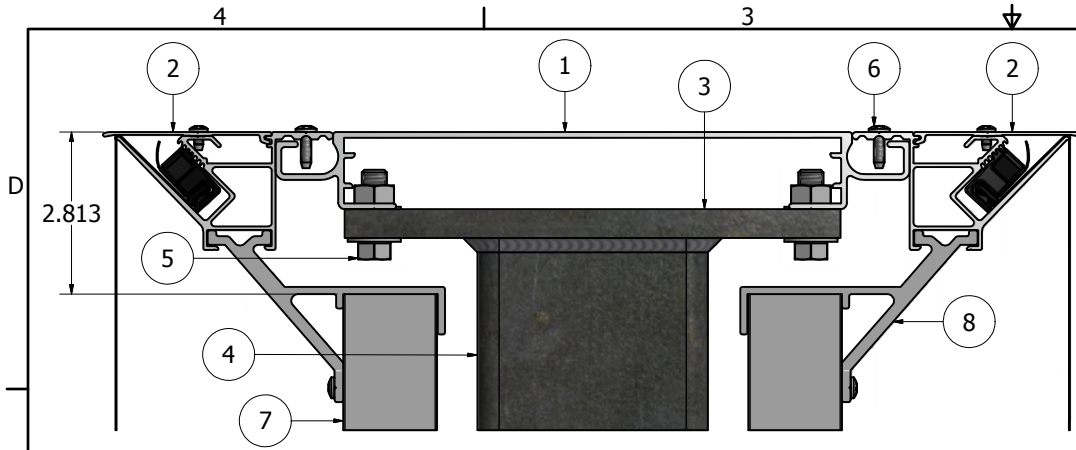

ASSEMBLED CROSS-SECTION

PARTS LIST			
ITEM	PART #	DESCRIPTION	NOTES
1	K2008	Flat Double Face Body	Assembly
2	K2104-2121	Flat Bleed Retro Frame w/ Bleed Cover	Assembly
3		Mounting Plate	By Other
4		Main Support Tube	By Other
5		Mounting Plate Bolt Assembly	By Other
6	5175	Hinge/Closure Screw	
7	2175	Frame Support Tube	3/4" x 1-5/8" Sq Tube
8	5350	Frame Brace	

### Compression Bracing for Flexible Vinyl Faces

Place a vertical Frame Brace and Frame Support Tube approximately every 36" on center. Cut and insert horizontal pieces of Frame Support Tube attached to Braces, approximately every 36" in between the vertical assemblies.

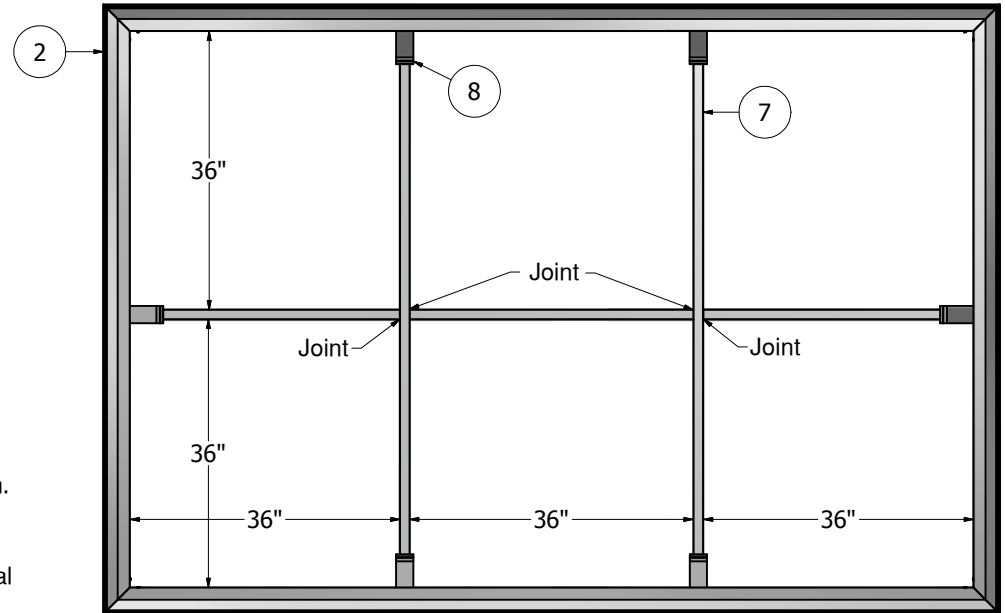
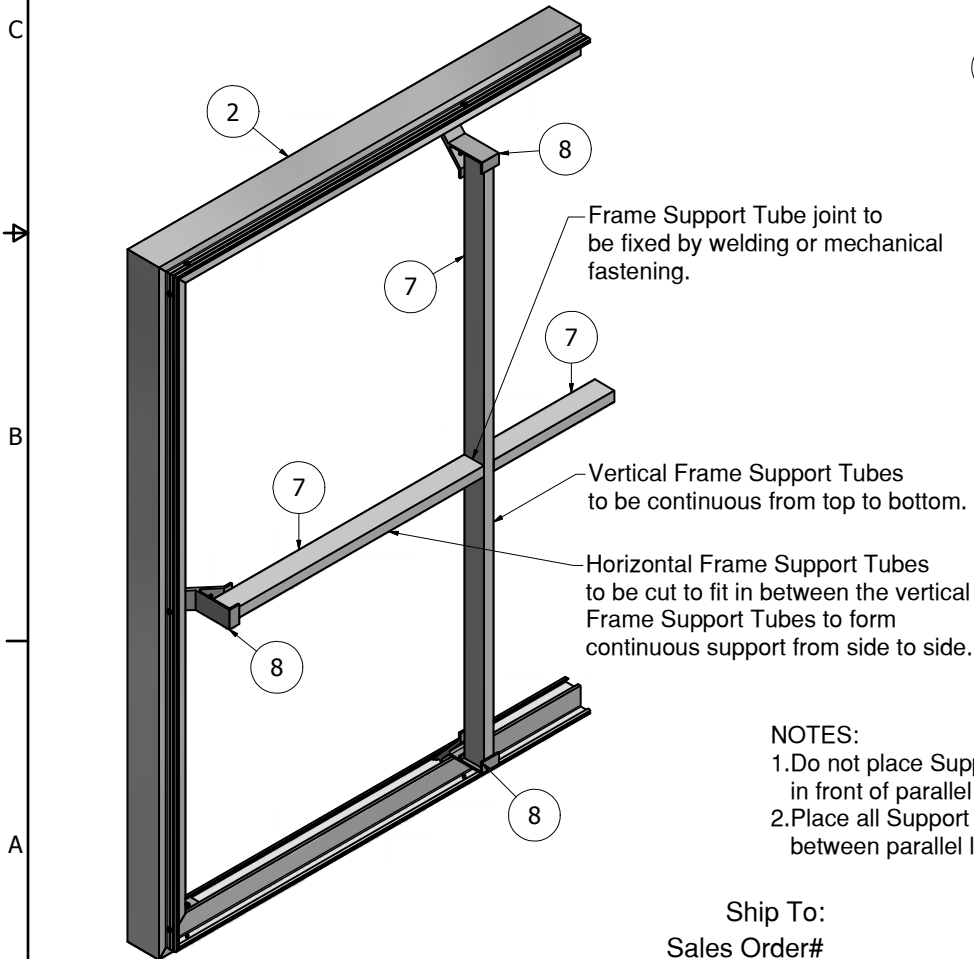

**NOTES:**

1. Do not place Support Assemblies directly in front of parallel steel support structures.
2. Place all Support Assemblies directly in between parallel lamps.

Ship To:  
Sales Order#

THIS DRAWING WAS CREATED AT NO CHARGE TO ASSIST YOU IN VISUALIZING OUR PROPOSAL. THE DRAWING HEREIN IS THE PROPERTY OF SIGNCOMP. PERMISSION TO COPY OR REVISE THIS DRAWING OR TO USE THIS DRAWING FOR PRODUCTION IS STRICTLY PROHIBITED AND CAN ONLY BE COPIED, REVISED OR USED FOR PRODUCTION WITH THE EXPRESSED WRITTEN PERMISSION OF SIGNCOMP.

DRAWING BY:	SBreihof	8/13/2013
Centroid X:	0.000 in	
Centroid Y:	0.000 in	
Principal Moments Ix:	0.000 in <sup>4</sup>	
Principal Moments Iy:	0.000 in <sup>4</sup>	
Section Modulus Ix:	0.000 in <sup>3</sup>	
Section Modulus Iy:	0.000 in <sup>3</sup>	

		TITLE
		Frame Support Placement
PART NO	5350 Frame Brace	REV
SHEET 1 OF 1		