

Features & Benefits

The EconoComp Line is engineered for fast, easy assembly. The filler is extruded with large inner body flanges to provide for the attachment of internal structure and simple attachment of raceway covers. Hanging bar tabs are designed into the molding to hang the face from, giving the face a flat appearance and assisting in the prevention of the face blowing out. These are available in two finishes. (Mill Finish & Dark Quaker Bronze.)

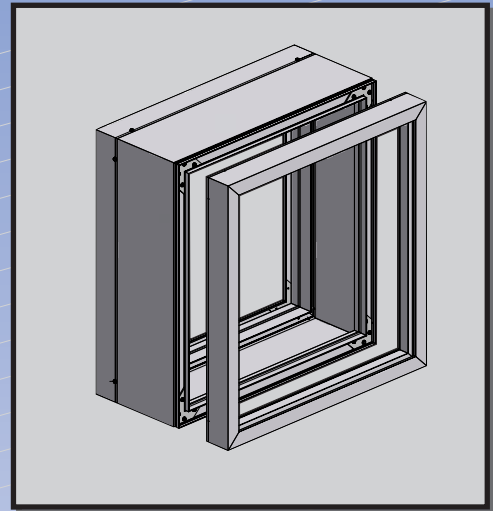

Answers to FAQ's

- The cabinet accepts up to 1/4" thick face material.
- Face trim size - Deduct 3/8" from the cabinet height & width.
- Add 1" in the direction of the lamp to allow for standard T12 bulbs to fit. (96" to 97")
- Recommended lamp spacing for flat faces is 10" on center.

Optional Items

- Raceway Cover 10" On Center Part #5087
- Raceway Cover Blank Part #5088
- Socket Raceway & Cover - See Standard Product Catalog Page 7 & 12.
- Econo Divider - Part #2140

