

2



1

PARTS LIST

ITEM	PART #	DESCRIPTION	NOTES
1	2010	Flat 2 Piece Double Face Medium Body	Assembly
2	2047	Flat 2" Retainer	Assembly
79	5178	Hinge Screw - #10 x 5/8" pancake head	Pre-drill 5/32" pilot hole every 36" - Top only
80	5178	Closure Screw - #10 x 5/8" pancake head	Pre-drill 5/32" pilot hole every 48" - Sides & Bottom

NOTE: PRE-CUT KITS ARE NOT PRE-DRILLED.

(Holes shown in this drawing are for reference only.
Drilling of pilot holes are to be done by fabricator.)

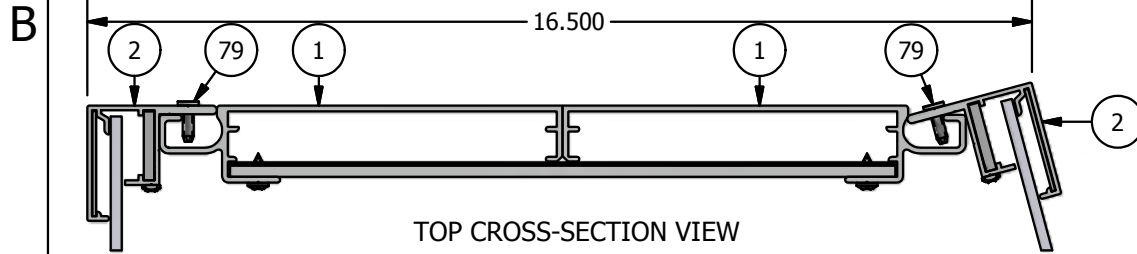

TOP CROSS-SECTION VIEW

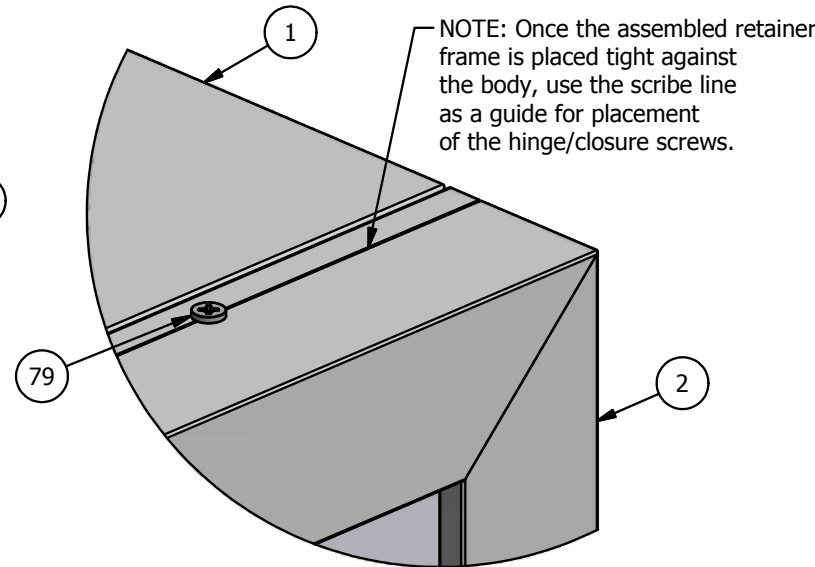
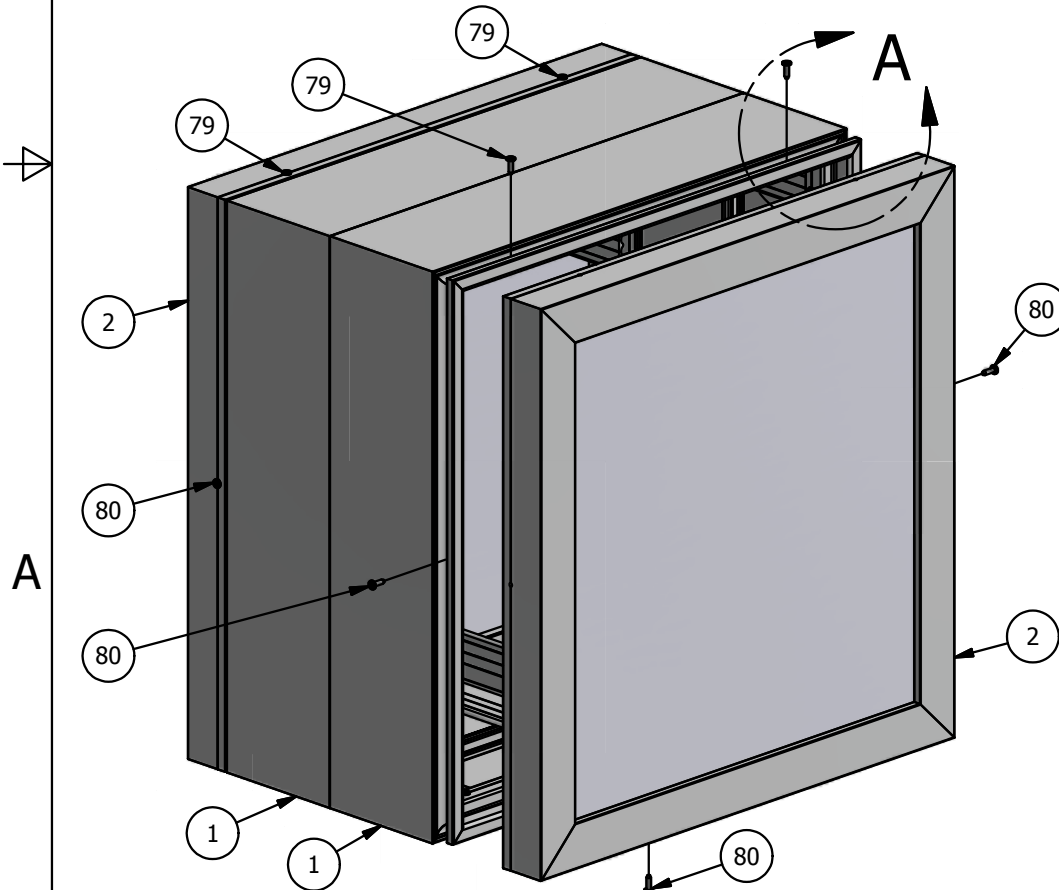
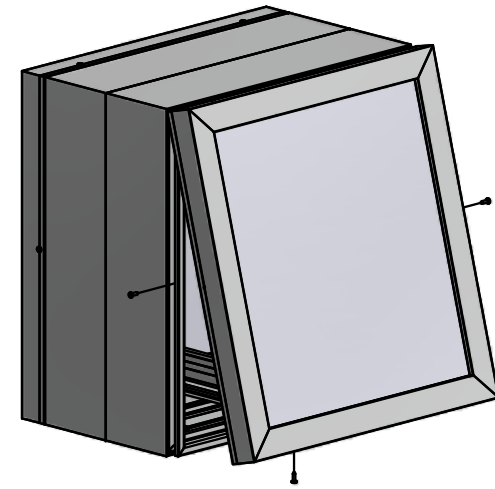

DETAIL A

Ship To:
Sales Order #

THIS DRAWING WAS CREATED AT NO CHARGE TO ASSIST YOU IN VISUALIZING OUR PROPOSAL. THE DRAWING HEREIN IS THE PROPERTY OF SIGNCOMP. PERMISSION TO COPY OR REVISE THIS DRAWING OR TO USE THIS DRAWING FOR PRODUCTION IS STRICTLY PROHIBITED AND CAN ONLY BE COPIED, REVISED OR USED FOR PRODUCTION WITH THE EXPRESSED WRITTEN PERMISSION OF SIGNCOMP.

Part Name: Flat 2 Piece Double Face Medium Body & Flat 2" Ret. - Assembly
 Part Number: K2010/2047
 Revision: 6/10/2015
 Date: 6/10/2015
 Sheet: 1 of 1
 Drawing By: SBreihof
 Size: A

SignComp

B

A

2



1

PARTS LIST			
ITEM	PART#	DESCRIPTION	NOTES
1	2010	Flat 2PC Double Face Medium Body	Top & Bottom
2	2010	Flat 2PC Double Face Medium Body	Sides
3	5910	Flat 2PC Double Face Medium Body Corner Angle	One (1) per corner
4	5910	Flat 2PC Double Face Medium Body Corner Angle	Notched by Other
13	5218	Corner Angle Screw	Pre-drill 5/32" pilot hole

Shp To:
Sales Order#

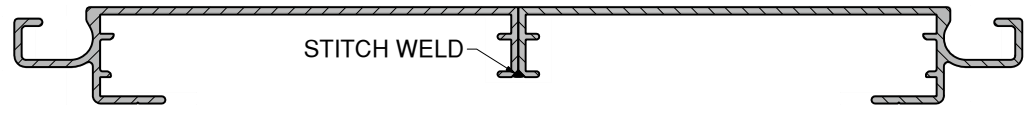
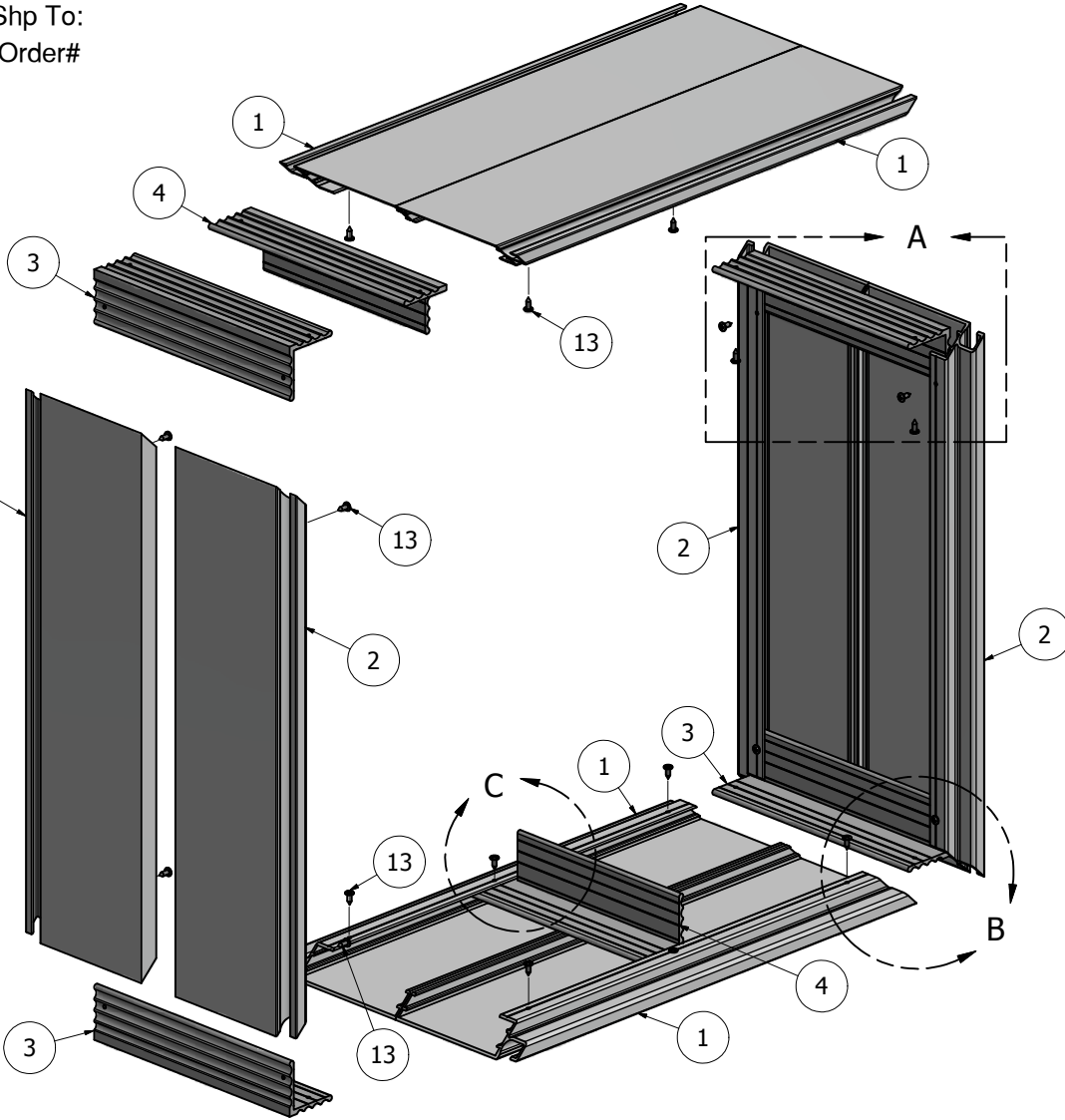

CROSS-SECTION VIEW

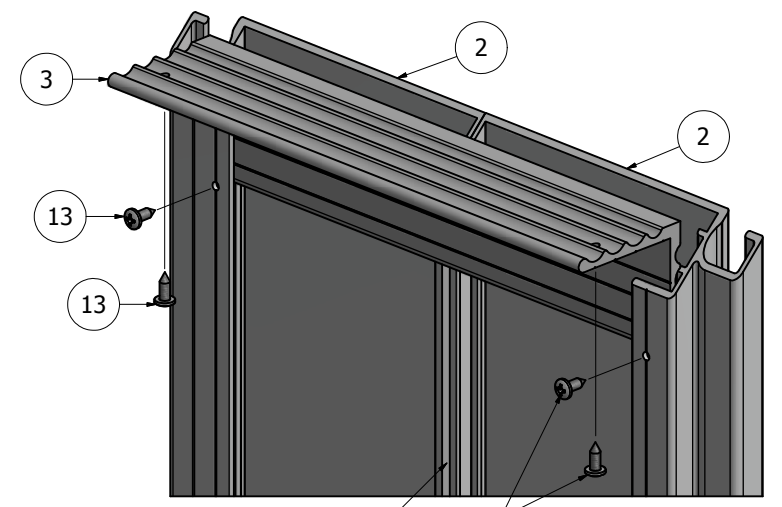

NOTE: Stitch weld the body joint then fill in the gaps between the welds with a bead of silicon.

DETAIL A

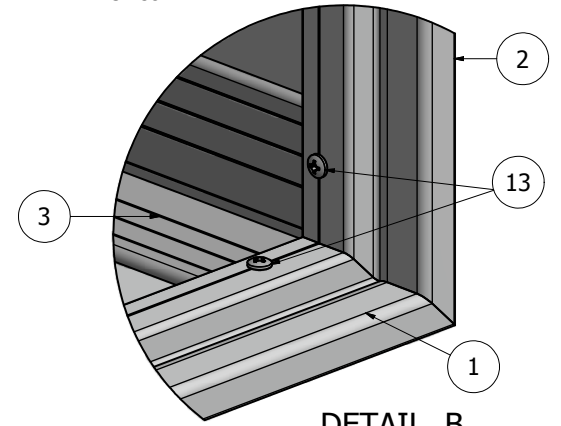

DETAIL B
ASSEMBLED

NOTE: PRE-CUT KITS ARE NOT PRE-DRILLED.
(Holes shown in this drawing are for reference only. Drilling of pilot holes are to be done by fabricator.)

DRAWING BY: SBreihof 8/14/2013		SignComp
Centroid X: 0.000 in	TITLE	
Centroid Y: 0.000 in	Flat 2PC Double Face Medium Body - Assembly	
Principal Moments Ix: 0.000 in ⁴	PART NO	REV
Principal Moments Iy: 0.000 in ⁴	K2010	
Section Modulus Ix: 0.000 in ³	SHEET 1 OF 2	
Section Modulus Iy: 0.000 in ³		

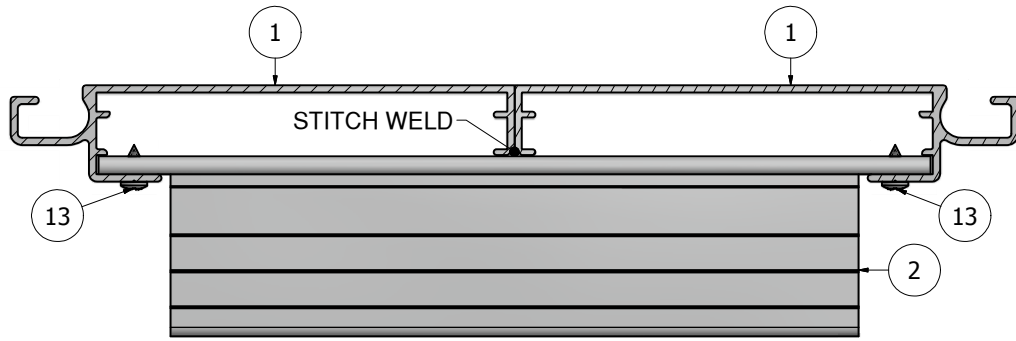

TOP & BOTTOM CROSS-SECTION VIEW
AT BODY BRACE

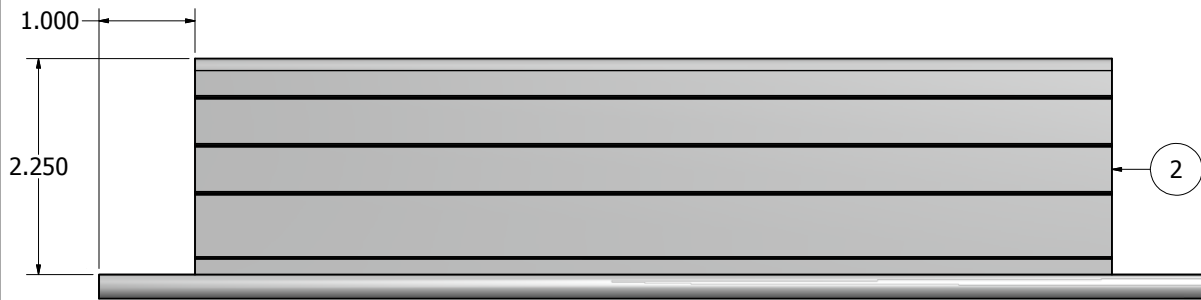

NOTE: NOTCH BOTH ENDS OF THE ANGLE ABOVE TO BYPASS THE INNER BODY FLANGES. THIS SERVES AS A BRACE TO PROVIDE ADDITIONAL SUPPORT TO THE JOINED BODY SECTIONS.

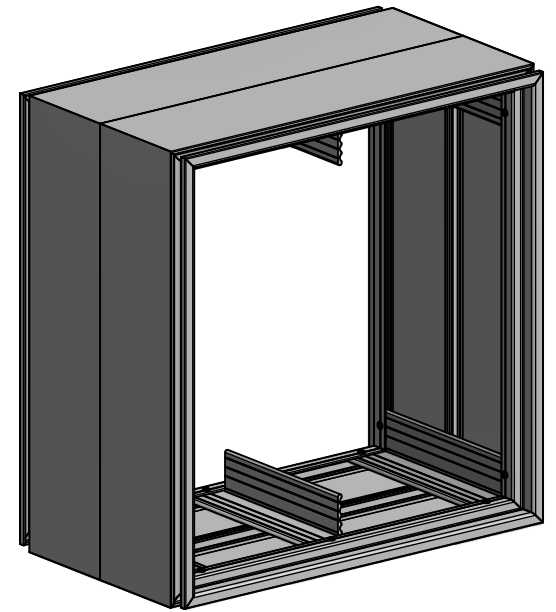

NOTE: BRACES SHOULD BE SPACED A MIN. OF 48" ON CENTER.

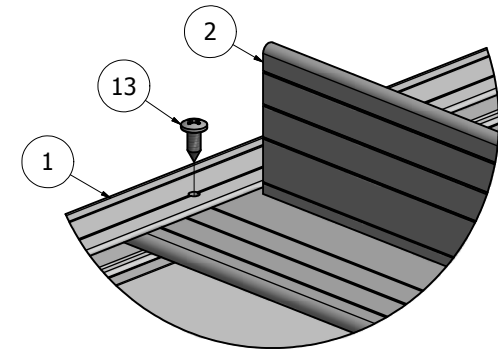

DETAIL C

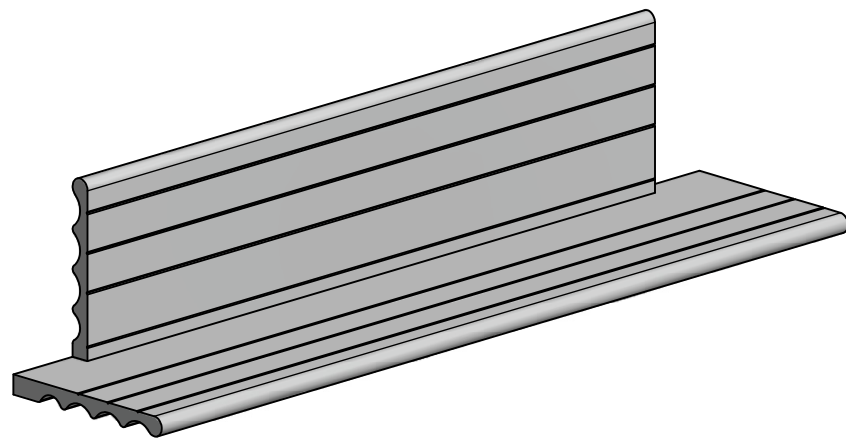

THIS DRAWING WAS CREATED AT NO CHARGE TO ASSIST YOU IN VISUALIZING OUR PROPOSAL. THE DRAWING HEREIN IS THE PROPERTY OF SIGNCOMP. PERMISSION TO COPY OR REVISE THIS DRAWING OR TO USE THIS DRAWING FOR PRODUCTION IS STRICTLY PROHIBITED AND CAN ONLY BE COPIED, REVISED OR USED FOR PRODUCTION WITH THE EXPRESSED WRITTEN PERMISSION OF SIGNCOMP.

DRAWING BY:	SBreihof	8/14/2013
Centroid X:	0.000 in	
Centroid Y:	0.000 in	
Principal Moments Ix:	0.000 in ⁴	
Principal Moments Iy:	0.000 in ⁴	
Section Modulus Ix:	0.000 in ³	
Section Modulus Iy:	0.000 in ³	

SignComp

Flat 2PC Double Face Medium Body - Assembly

PART NO	K2010	REV
---------	--------------	-----

PARTS LIST			
ITEM	PART #	DESCRIPTION	NOTES
1	2010	Flat 2PC Double Face Medium Body	All Sides
2	5910	Flat 2PC Double Face Medium Body Corner Angle	Notched by Other
13	5218	Corner Angle Screw	Pre-drill 5/32" pilot hole

2

PARTS LIST

ITEM	PART #	DESCRIPTION	NOTES
1	2047	Flat 2" Retainer	Top & Bottom Retainers
2	2047	Flat 2" Retainer	Sides
3	5214	Flat 2" Frame Corner Bracket	
4	5214	Flat 2" Frame Corner Key	
87	5195	Flat Frame Corner Bracket Screw	#8 x 5/16" - Pre-drill 1/8" holes Four (4) per corner

B NOTE: PRE-CUT KITS ARE NOT PRE-DRILLED.

(Holes shown in this drawing are for reference only.
Drilling of pilot holes are to be done by fabricator.)

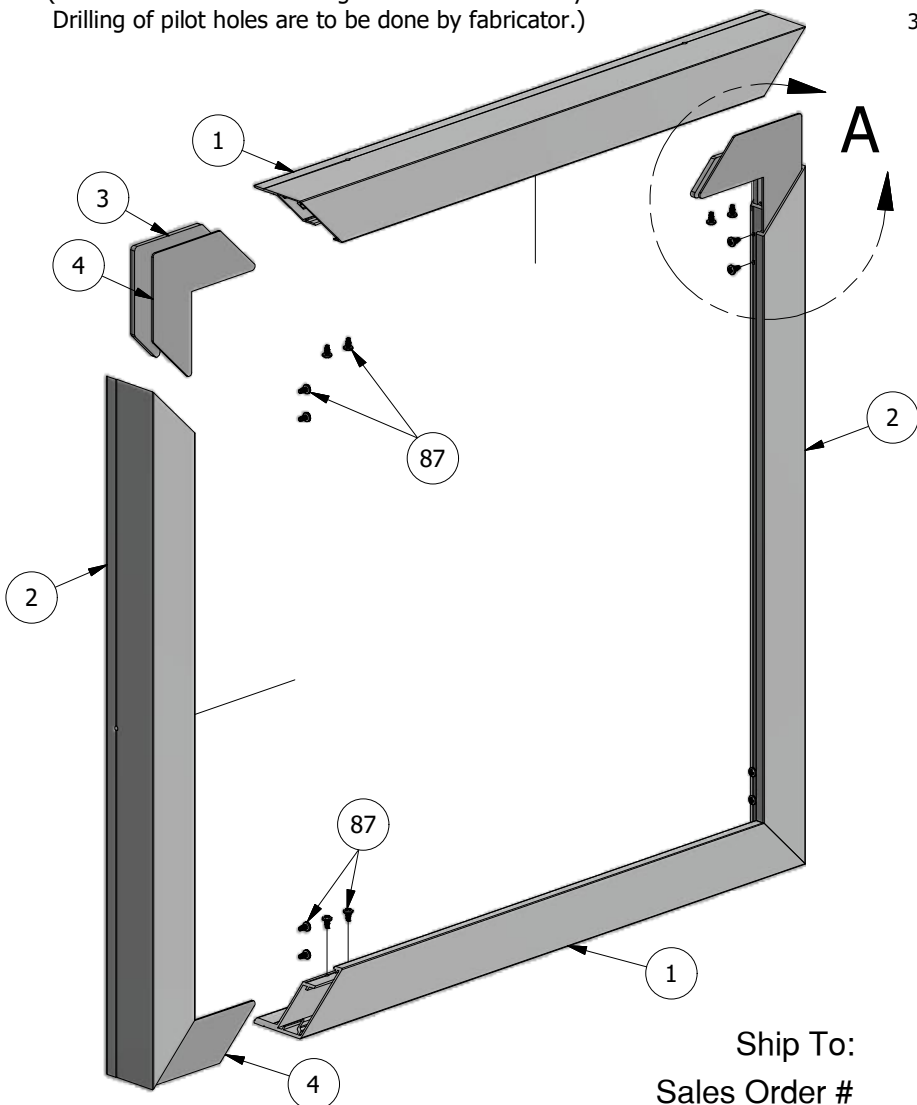

Ship To:
Sales Order #

2

1

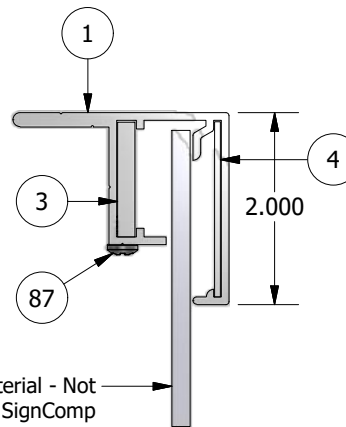

CROSS-SECTION VIEW

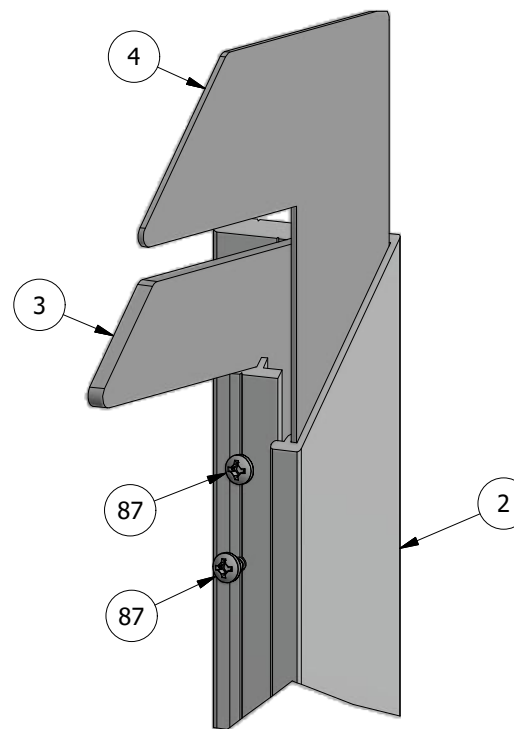
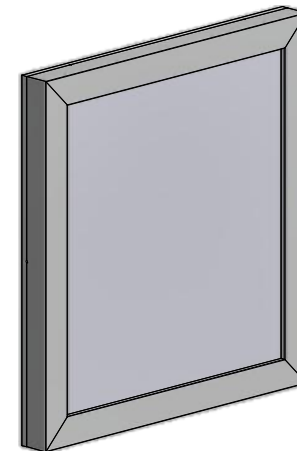

DETAIL A

1

THIS DRAWING WAS CREATED AT NO CHARGE TO ASSIST YOU IN VISUALIZING OUR PROPOSAL. THE DRAWING HEREIN IS THE PROPERTY OF SIGNCOMP. PERMISSION TO COPY OR REVISE THIS DRAWING OR TO USE THIS DRAWING FOR PRODUCTION IS STRICTLY PROHIBITED AND CAN ONLY BE COPIED, REVISED OR USED FOR PRODUCTION WITH THE EXPRESSED WRITTEN PERMISSION OF SIGNCOMP.

Part Name: Flat 2" Retainer

Part Number: 2047

Revision:

Date: 4/27/2015

Drawing By: SBreihof

Sheet: 1 of 1

Size: A

SignComp

B

A