

| PARTS LIST | | | |
|------------|------------|---------------------------------------|------------------------------------|
| ITEM | PART # | DESCRIPTION | NOTES |
| 1 | K2007 | Flat Double Face Medium Body | Assembly |
| 2 | K2104-2121 | Flat Bleed Retro Frame w/ Bleed Cover | Assembly |
| 79 | 5175 | Hinge Screw - #10 x 5/8" Pan Head | Pre-drill 5/32" hole every 36" o/c |
| 80 | 5175 | Closure Screw - #10 x 5/8" Pan Head | Pre-drill 5/32" hole every 48" o/c |

Ship To:
Sales Order#

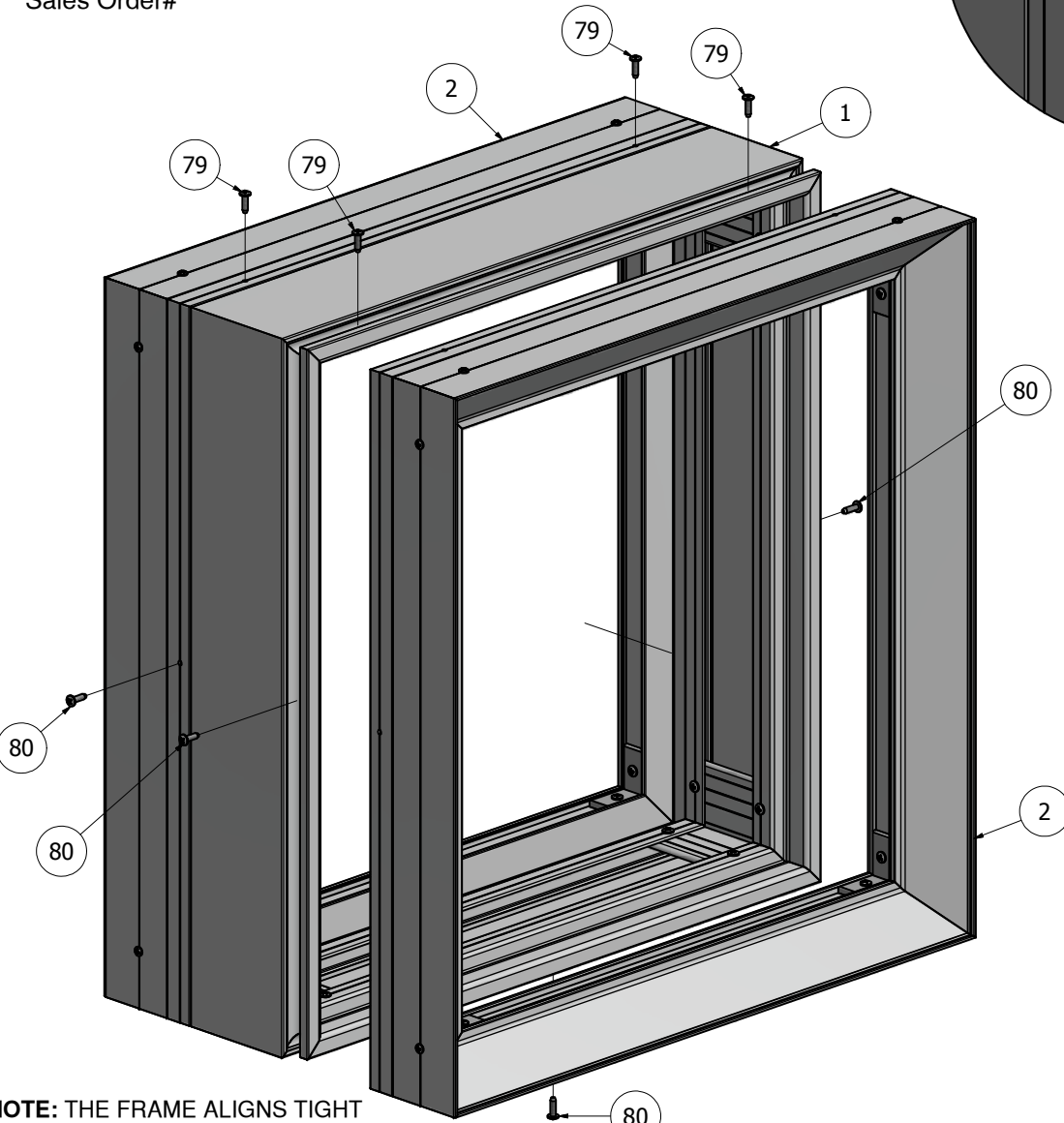

NOTE: THE FRAME ALIGNS TIGHT TO THE BODY, SHOWING NO REVEAL.

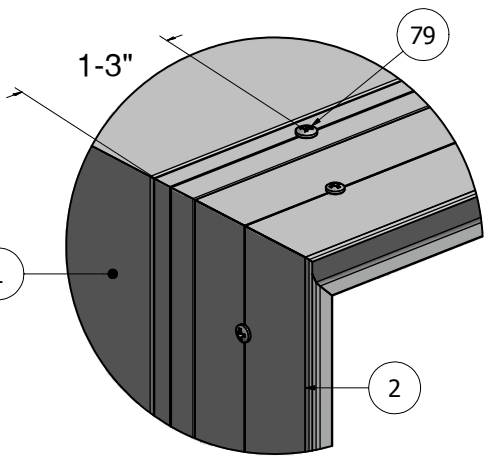

DETAIL A
FRAME CLOSED

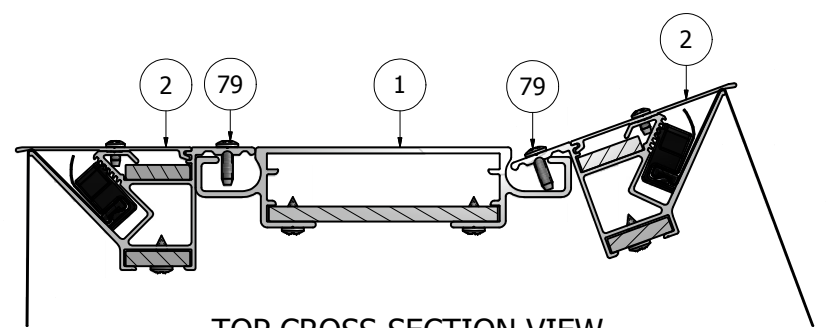
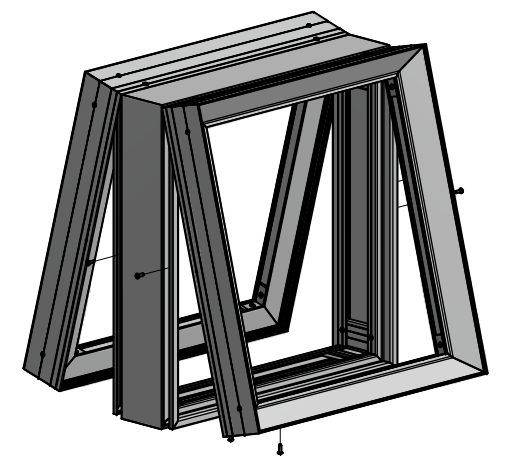

TOP CROSS-SECTION VIEW

NOTE: PRE-CUT KITS ARE NOT PRE-DRILLED.
(Holes shown in this drawing are for reference only. Drilling of pilot holes are to be done by fabricator.)

| | | |
|---|---|-----------------|
| DRAWING BY: SBreihof 8/13/2013 | | SignComp |
| Centroid X: 0.000 in | TITLE | |
| Centroid Y: 0.000 in | Flat Double Face Medium Body w/ Flat Bleed Retro Frame and Bleed Cover - Assembly | |
| Principal Moments Ix: 0.000 in ⁴ | PART NO | REV |
| Principal Moments Iy: 0.000 in ⁴ | K2007-2104-21 | |
| Section Modulus Ix: 0.000 in ³ | SHEET 1 OF 1 | |
| Section Modulus Iy: 0.000 in ³ | | |

| PARTS LIST | | | |
|------------|--------|---|----------------------------|
| ITEM | PART # | DESCRIPTION | NOTES |
| 1 | 2007 | Flat Double Face Medium Body | Top and Bottom |
| 2 | 2007 | Flat Double Face Medium Body | Sides |
| 3 | 5907 | Flat Double Face Medium Body Corner Angle | One (1) per corner |
| 13 | 5218 | Corner Angle Screw | Pre-drill 5/32" pilot hole |

Ship To:
Sales Order#

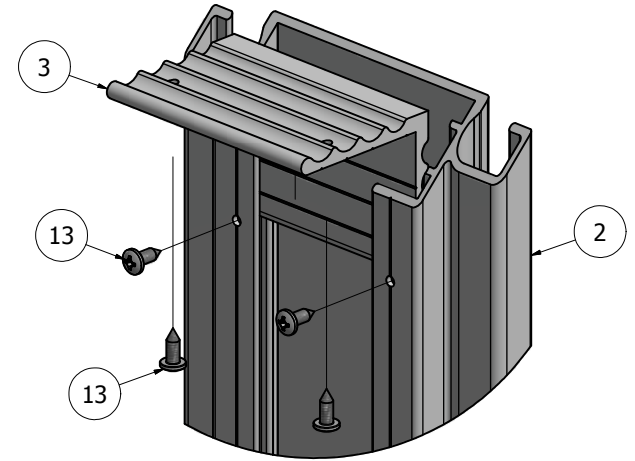
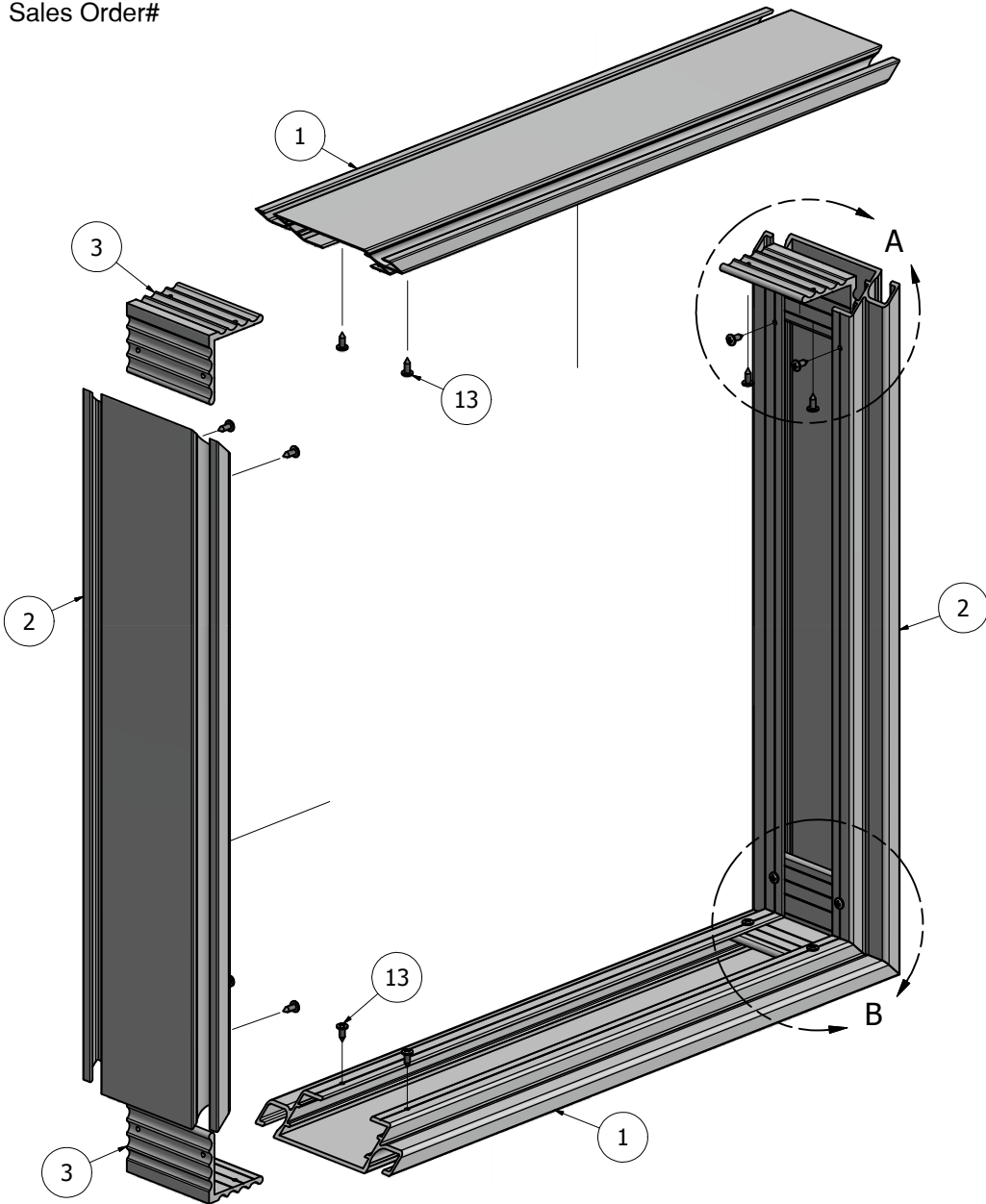

DETAIL A

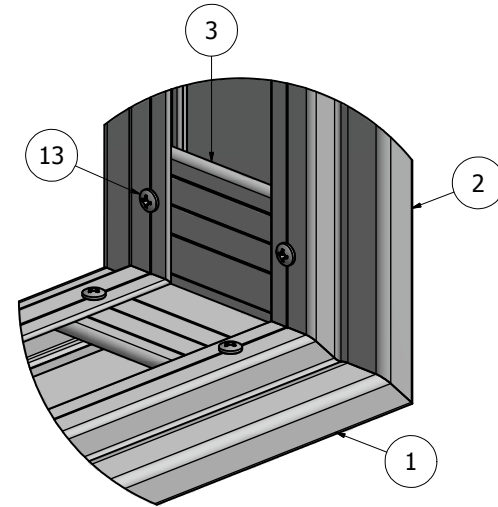

DETAIL B

NOTE: PRE-CUT KITS ARE NOT PRE-DRILLED.
(Holes shown in this drawing are for reference only.
Drilling of pilot holes are to be done by fabricator.)

THIS DRAWING WAS CREATED AT NO CHARGE TO ASSIST YOU IN VISUALIZING OUR PROPOSAL. THE DRAWING HEREIN IS THE PROPERTY OF SIGNCOMP. PERMISSION TO COPY OR REVISE THIS DRAWING OR TO USE THIS DRAWING FOR PRODUCTION IS STRICTLY PROHIBITED AND CAN ONLY BE COPIED, REVISED OR USED FOR PRODUCTION WITH THE EXPRESSED WRITTEN PERMISSION OF SIGNCOMP.

| | | |
|-----------------------|-----------------------|-----------|
| DRAWING BY: | SBreihof | 8/13/2013 |
| Centroid X: | 0.000 in | |
| Centroid Y: | 0.000 in | |
| Principal Moments Ix: | 0.000 in ⁴ | |
| Principal Moments Iy: | 0.000 in ⁴ | |
| Section Modulus Ix: | 0.000 in ³ | |
| Section Modulus Iy: | 0.000 in ³ | |

SignComp

TITLE
Flat Double Face Medium Body - Assembly

PART NO
K2007

| PARTS LIST | | | |
|------------|-------|------------------------|--------------|
| ITEM | PART# | DESCRIPTION | NOTES |
| 1 | 2104 | Flat Bleed Retro Frame | Top & Bottom |
| 2 | 2104 | Flat Bleed Retro Frame | Sides |
| 3 | 5305 | Frame Corner Angle | |
| 13 | 5218 | Corner Angle Screw | |

Ship To:
Order Number:

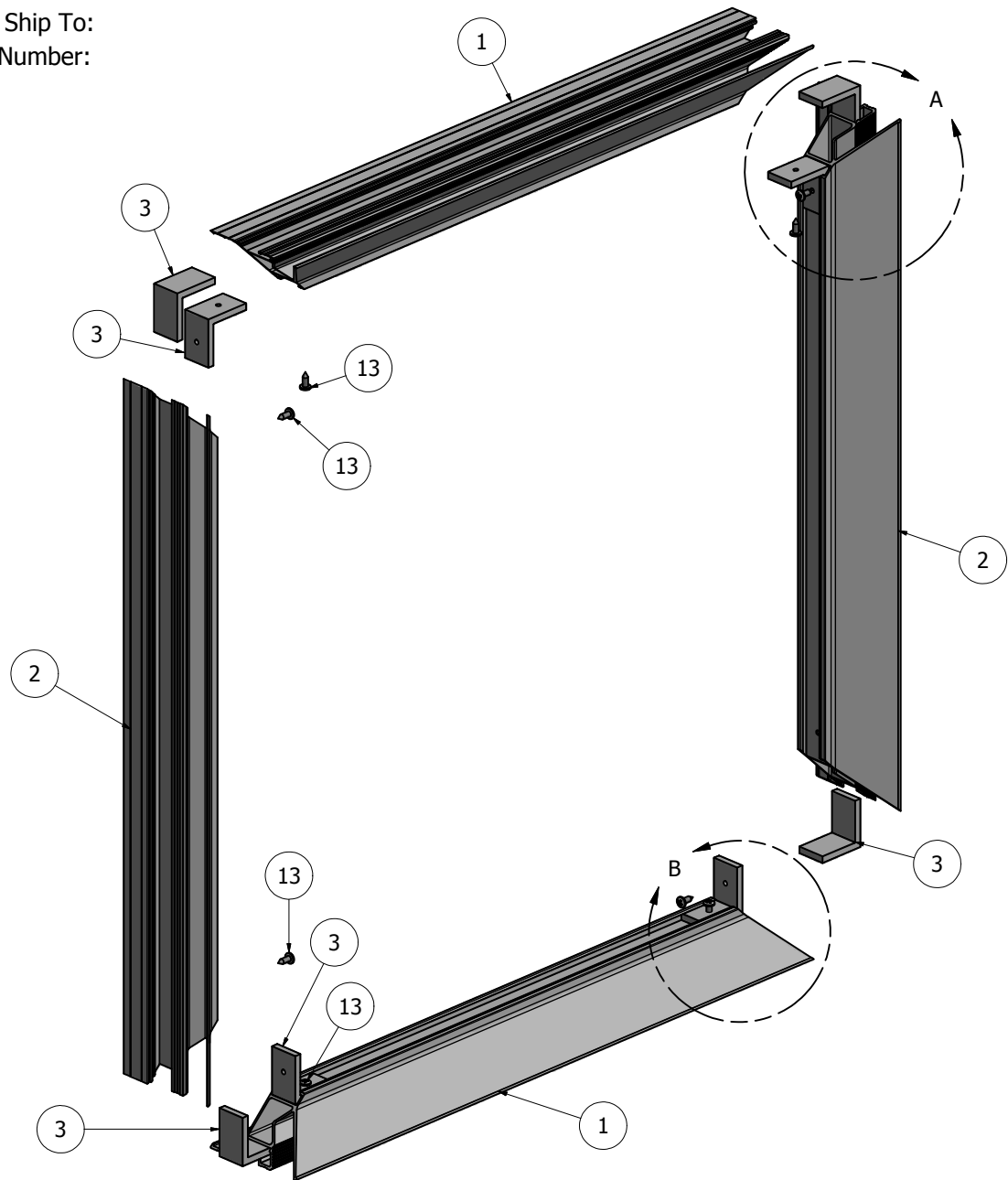

OUTER FRAME CORNER
ANGLE FLOATS IN THE
FRAME FOR ALIGNMENT

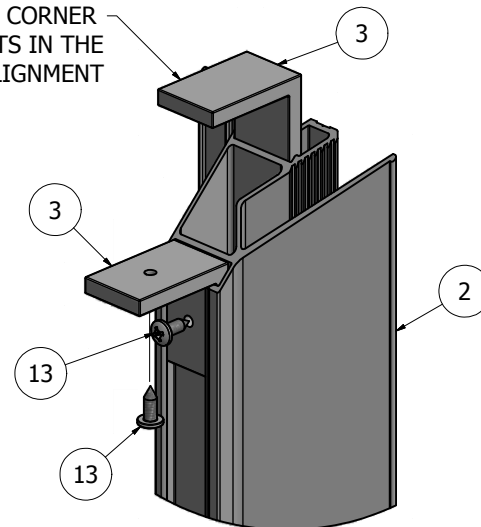

DETAIL A

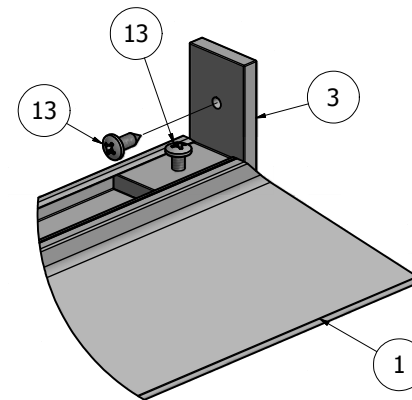

DETAIL B

NOTE: PRE-CUT KITS ARE NOT PRE-DRILLED.

(Holes shown in this drawing are for reference only.
Drilling of pilot holes are to be done by fabricator.)

THIS DRAWING WAS CREATED AT NO CHARGE TO ASSIST YOU IN VISUALIZING OUR PROPOSAL. THE DRAWING HEREIN IS THE PROPERTY OF SIGNCOMP. PERMISSION TO COPY OR REVISE THIS DRAWING OR TO USE THIS DRAWING FOR PRODUCTION IS STRICTLY PROHIBITED AND CAN ONLY BE COPIED, REVISED OR USED FOR PRODUCTION WITH THE EXPRESSED WRITTEN PERMISSION OF SIGNCOMP.

| | | | |
|-----------------------|-----------------------|----------|--|
| DRAWN | SBreihof | 5/8/2012 | <h1>SignComp</h1> |
| Centroid X: | 0.000 in | | |
| Centroid Y: | 0.000 in | | |
| Principal Moments Ix: | 0.000 in ⁴ | | |
| Principal Moments Iy: | 0.000 in ⁴ | | <h2>Flat Bleed Retro Frame - Assembly</h2> |
| Section Modulus Ix: | 0.000 in ³ | | |
| Section Modulus Iy: | 0.000 in ³ | | |
| DWG NO | | | REV |
| K2104 | | | |
| SHEET 1 OF 1 | | | |

| PARTS LIST | | | |
|------------|-------|------------------------------|----------------------------|
| ITEM | PART# | DESCRIPTION | NOTES |
| 1 | K2104 | Flat Bleed Retro Frame | Assembly |
| 2 | 2121 | Flat Bleed Retro Frame Cover | Top & Bottom |
| 3 | 2121 | Flat Bleed Retro Frame Cover | Sides |
| 12 | 5195 | Cover Screw | Pre-drill 3/32" pilot hole |

Ship To:
Sales Order#

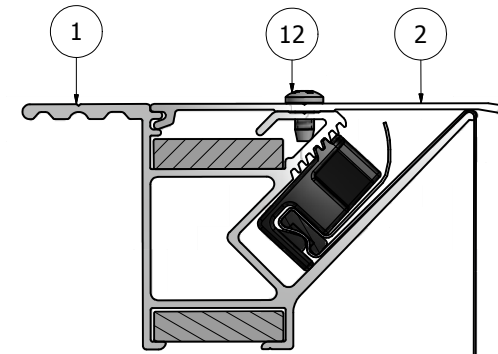
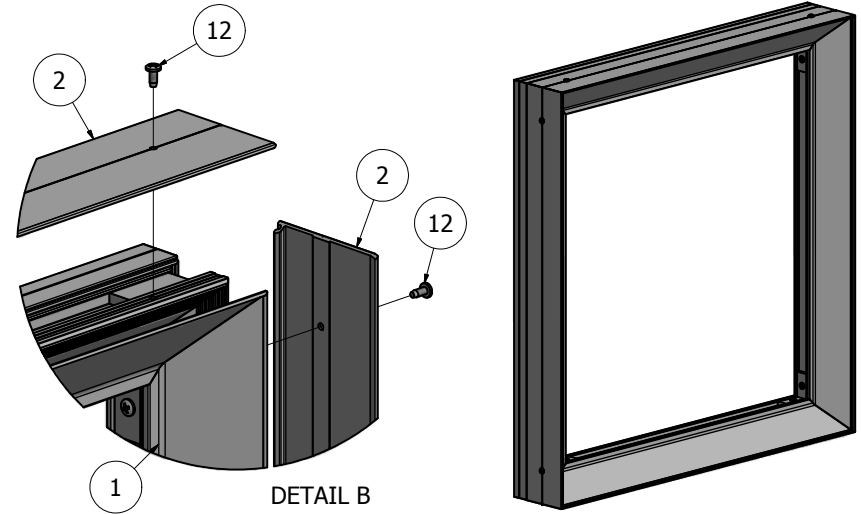
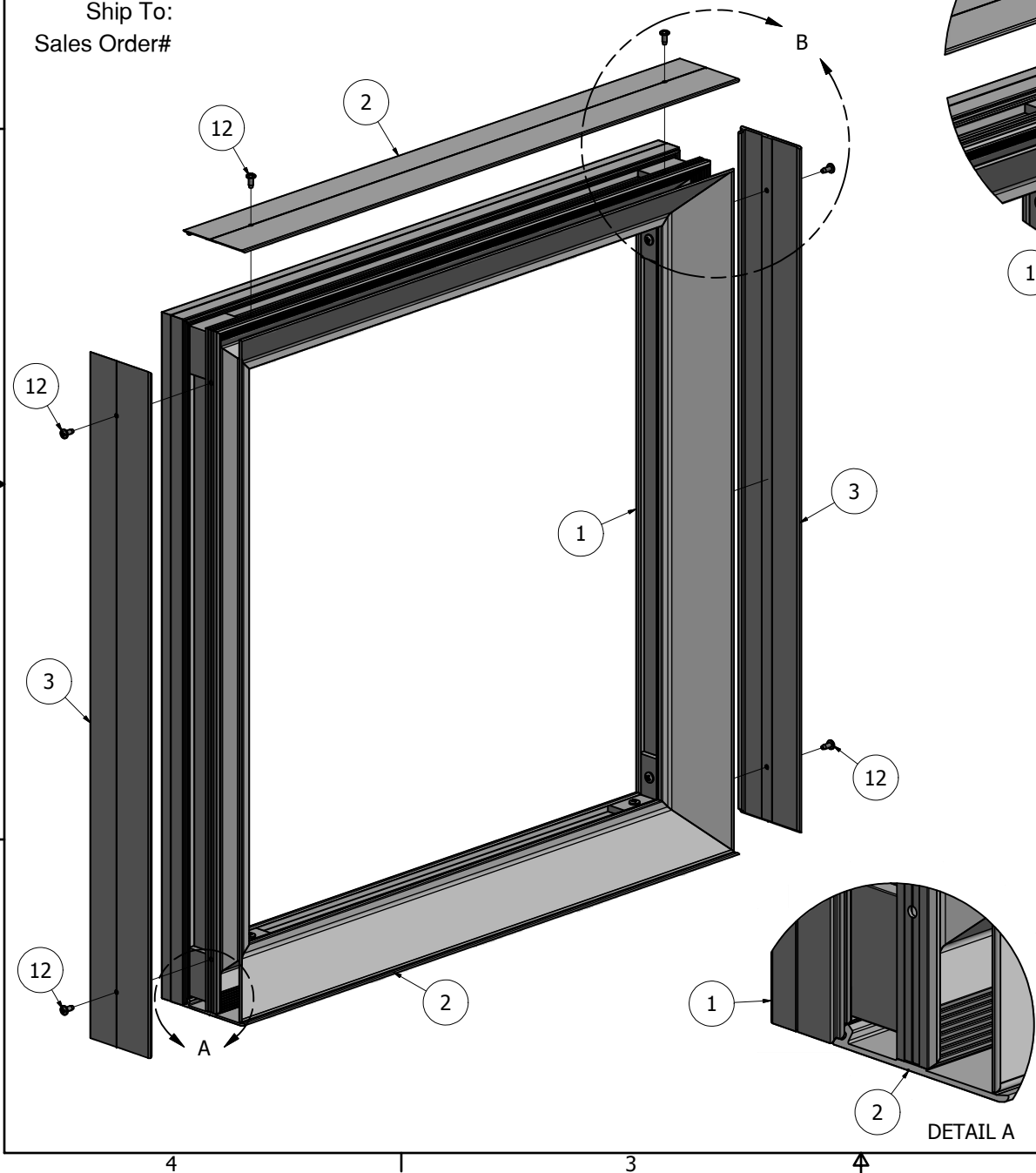

CROSS-SECTION VIEW

NOTE: PRE-CUT KITS ARE NOT PRE-DRILLED.
(Holes shown in this drawing are for reference only.
Drilling of pilot holes are to be done by fabricator.)

THIS DRAWING WAS CREATED AT NO CHARGE TO ASSIST YOU IN VISUALIZING OUR PROPOSAL. THE DRAWING HEREIN IS THE PROPERTY OF SIGNCOMP. PERMISSION TO COPY OR REVISE THIS DRAWING OR TO USE THIS DRAWING FOR PRODUCTION IS STRICTLY PROHIBITED AND CAN ONLY BE COPIED, REVISED OR USED FOR PRODUCTION WITH THE EXPRESSED WRITTEN PERMISSION OF SIGNCOMP.

| | | |
|-----------------------|-----------------------|----------|
| DRAWN | SBreihof | 5/8/2012 |
| Centroid X: | 0.000 in | |
| Centroid Y: | 0.000 in | |
| Principal Moments Ix: | 0.000 in ⁴ | |
| Principal Moments Iy: | 0.000 in ⁴ | |
| Section Modulus Ix: | 0.000 in ³ | |
| Section Modulus Iy: | 0.000 in ³ | |

| | |
|---|-----|
| SignComp | |
| TITLE | |
| Flat Bleed Retro Frame w/ Flat Bleed Retro Frame Cover - Assembly | |
| DWG NO | REV |
| K2104-21 | |
| SHEET 1 OF 1 | |

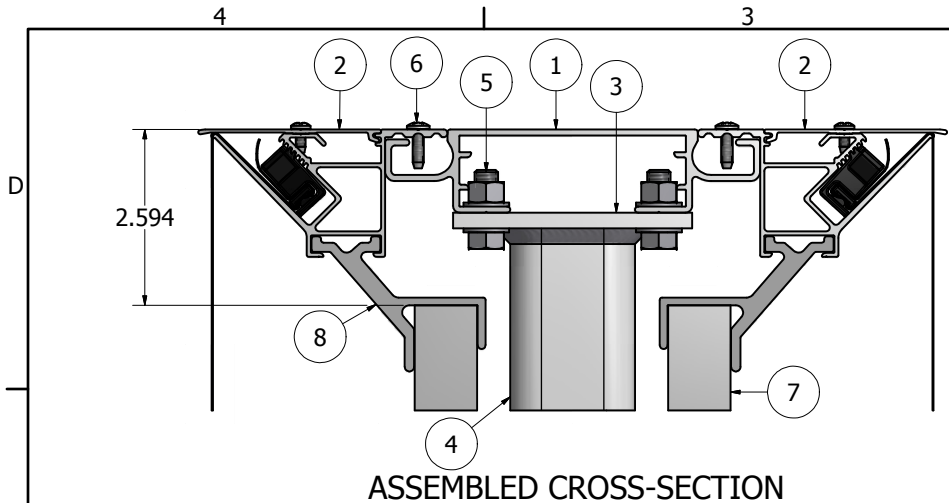

| PARTS LIST | | | |
|------------|------------|---------------------------------------|-----------------|
| ITEM | PART # | DESCRIPTION | NOTES |
| 1 | K2007 | Flat Double Face Medium Body | Assembly |
| 2 | K2104-2121 | Flat Bleed Retro Frame w/ Bleed Cover | Assembly |
| 3 | | Mounting Plate | By Other |
| 4 | | Main Support Tube | By Other |
| 5 | | Mounting Plate Bolt Assembly | By Other |
| 6 | 5175 | Hinge/Closure Screw | |
| 7 | 2177 | Frame Support Tube | 1" x 1" Sq Tube |
| 8 | 5352 | Small Frame Brace | |

Compression Bracing for Flexible Vinyl Faces
 Place a vertical Small Frame Brace and Frame Support Tube approximately every 36" on center. Cut and insert horizontal pieces of Frame Support Tube attached to Braces, approximately every 36" in between the vertical assemblies.

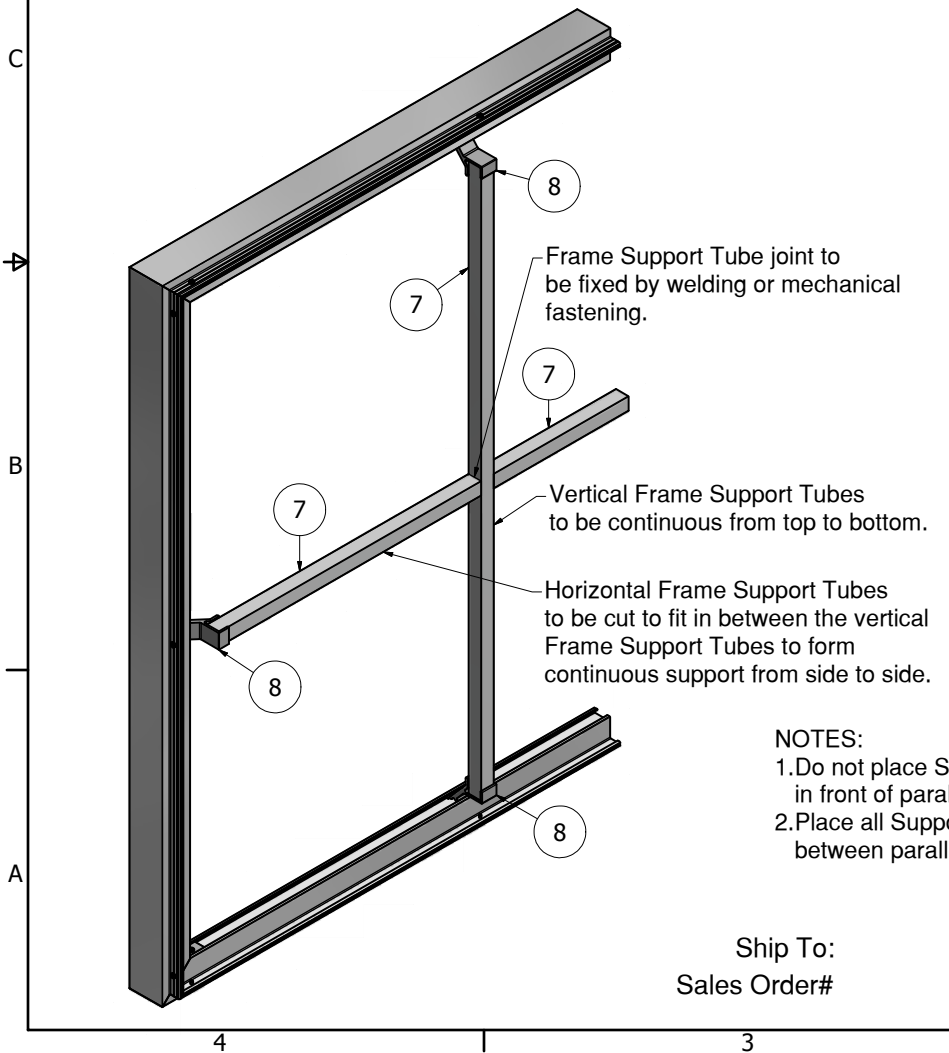

- NOTES:**
1. Do not place Support Assemblies directly in front of parallel steel support structures.
 2. Place all Support Assemblies directly in between parallel lamps.

Ship To:
Sales Order#

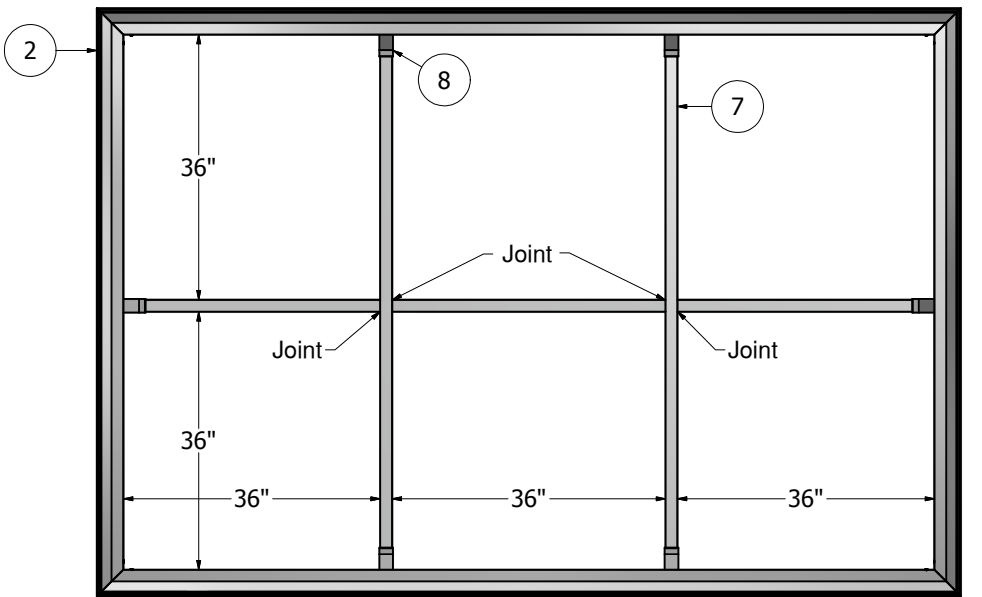

THIS DRAWING WAS CREATED AT NO CHARGE TO ASSIST YOU IN VISUALIZING OUR PROPOSAL. THE DRAWING HEREIN IS THE PROPERTY OF SIGNCOMP. PERMISSION TO COPY OR REVISE THIS DRAWING OR TO USE THIS DRAWING FOR PRODUCTION IS STRICTLY PROHIBITED AND CAN ONLY BE COPIED, REVISED OR USED FOR PRODUCTION WITH THE EXPRESSED WRITTEN PERMISSION OF SIGNCOMP.

| | | | |
|-----------------------|-----------------------|-----------|-------------------------------|
| DRAWING BY: | SBreihof | 8/13/2013 | SignComp |
| Centroid X: | 0.000 in | | |
| Centroid Y: | 0.000 in | | |
| Principal Moments Ix: | 0.000 in ⁴ | | Frame Support Placement |
| Principal Moments Iy: | 0.000 in ⁴ | | |
| Section Modulus Ix: | 0.000 in ³ | | PART NO |
| Section Modulus Iy: | 0.000 in ³ | | 5352 Small Frame Brace |
| | | | REV |

SHEET 1 OF 1